



Yannathan, 235 Heads Road

59.75 Acres of Fertile Soil in Yannathan!

LJ Hooker Pakenham is thrilled to introduce 235 Heads Road, Yannathan to the market. With a proud ownership history spanning over five decades, this property presents an exciting opportunity for new owners to infuse it with their own vision and unlock its full potential.

Key Features:

- * A comfortable and cozy three bedroom residence
- * Enjoy distinct spaces for relaxation and entertainment with separate lounge and dining room
- * Recently updated kitchen and bathroom
- * Spacious double carport.
- * 59.75 Acres of fertile peat soil to explore the vast potential of this expansive land, ideal for various agricultural pursuits.
- * The property includes a disused dairy along with cattle yards, offering possibilities for



LAND 23.88 ha

For Sale
Please Call

Contact
Troy Farrell
0417 244 524
tfarrell.pakenham@ljhooker.com.au



Disclaimer: All information contained therein is gathered from relevant third parties sources. We cannot guarantee or give any warranty about the information provided. Interested parties must rely solely on their own enquiries.

LJ Hooker Pakenham
(03) 5943 8000

restoration or adaptive reuse.

Situated approximately an hour from Melbourne, this farm occupies prime real estate in what is widely regarded as the finest grazing country in Gippsland. Its history as a productive dairy farm speaks to its inherent potential and the opportunities it presents for the discerning buyer.

This listing represents a remarkable chance to secure a property of exceptional quality. With strong demand for such offerings in the current market landscape, act swiftly to seize this rare opportunity.

For further details or to arrange a viewing, please contact LJ Hooker Pakenham today

Please note: All property details listed were current at the time of publishing. Due to extreme buyer demand, some properties may have been sold in the preceding 24 hours. Therefore confirmation of all opens with the listing agent within 24 hours of their scheduled opening is advised..

More About this Property

Property ID	1P38FC9
Property Type	Lifestyle
Land Area	23.88 ha
Including	Toilets (2)

Troy Farrell 0417 244 524

Sales Specialist | Licensed Estate Agent | tfarrell.pakenham@ljhooker.com.au

LJ Hooker Pakenham (03) 5943 8000

45 John Street, PAKENHAM VIC 3810

pakenham@ljhooker.com.au | pakenham@ljhooker.com.au

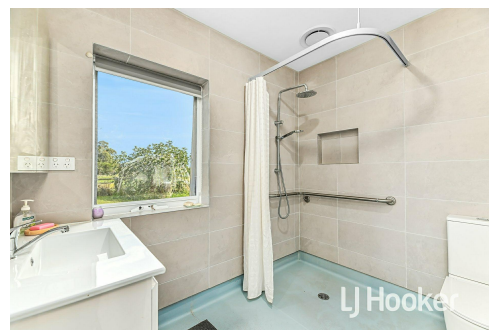

Disclaimer: All information contained therein is gathered from relevant third parties sources. We cannot guarantee or give any warranty about the information provided. Interested parties must rely solely on their own enquiries.

LJ Hooker Pakenham
(03) 5943 8000

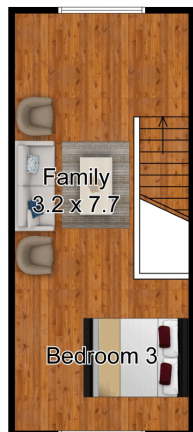

This drawing is for illustrative purposes only and while every effort has been made to maintain accuracy, prospective purchasers should check all information