



1 Sadowa Court, Wulguru

FABULOUS FAMILY HOME

Lovingly held by the same owner for over 30 years, this home is a true testament to long-term care and pride of ownership. Meticulously maintained throughout, it presents in exceptional condition, reflecting decades of thoughtful upkeep and attention to detail. With an open plan design and great outdoor features, this home is perfect for buyers seeking practicality and privacy.

Features Include:

- Three generous sized bedrooms
- Built in robes to all bedrooms and airconditioning
- Main bedroom has an ensuite and walk in robe
- Functional kitchen with great connection to living spaces
- Laundry conveniently located off the kitchen
- Private front deck - ideal for morning coffee or evening relaxation
- Colourbond shed with half carport and half workshop space
- Positioned in a quiet family friendly court.

If you are looking for a low maintenance home in sought after Wulguru with excellent storage and outdoor space, this property is well worth your inspection.

3  2  2 

FOR SALE

Offers over \$620,000

AGENTS

Suzanne Coverlid
0439 032 210
suzanne.coverlid@ljhooker.com.au

AGENCY

LJ Hooker Townsville
07 44262125

All information contained therein is gathered from relevant third parties sources.
We cannot guarantee or give any warranty about the information provided.
Interested parties must rely solely on their own enquiries.

 **LJ Hooker**

MORE DETAILS

Property ID 48AHWK
Property Type House
Land Area 610 m2

Suzanne Coverlid 0439 032 210

Sales & Marketing Consultant | suzanne.coverlid@ljhooker.com.au

LJ Hooker Townsville 07 44262125

Shop 18/39 Eyre Street, NORTH WARD QLD 4810
townsville.ljhooker.com.au | townsville@ljhooker.com.au



All information contained therein is gathered from relevant third parties sources.
We cannot guarantee or give any warranty about the information provided.
Interested parties must rely solely on their own enquiries.

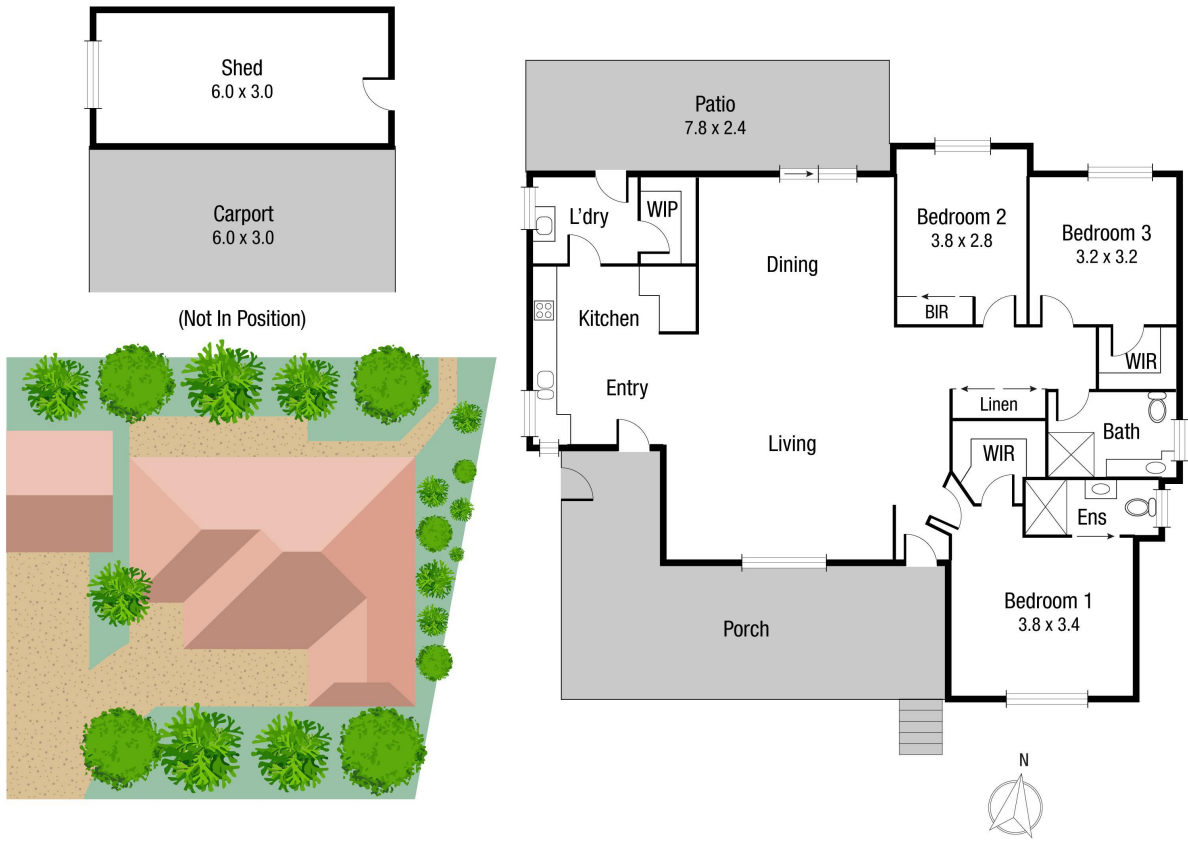

Scale in metres. Indicative only. Dimensions are approximate. All information contained herein is gathered from sources we believe to be reliable. However we cannot guarantee its accuracy and interested persons should rely on their own enquiries.

TOTAL AREA : 165.6 sq.m

1 Sadowa Ct, Wulguru