



Wondecla, 116 Chester Road

360° Views | Family Living | Rich Soils

Just 26 minutes from Atherton and 1 hour and 45 minutes from Cairns, set on a stunning 10.5-acre block with views in every direction, this exceptional property offers the perfect blend of comfort, functionality, and natural beauty.

The driveway winds through to the heart of the property, where a beautifully designed home awaits. Step inside to a grand entrance that leads into a spacious open-plan living area, enhanced by polished timber floors, raked ceilings, and an abundance of natural light.

The well-appointed kitchen overlooks the living and dining areas which open directly to the expansive main veranda-perfect for entertaining and offering the best mountain views. A central fireplace creates a cozy atmosphere and warms the entire home during the cooler months.

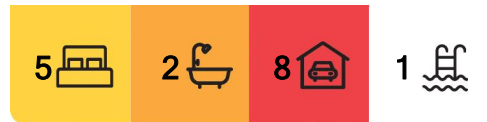

For Sale
Please Call

View
ljhooker.com.au/S1GF1S

Contact
Alex Payne
0409 328 153
alex@ljhookerpropertyplus.com



Disclaimer: All information contained therein is gathered from relevant third parties sources. We cannot guarantee or give any warranty about the information provided. Interested parties must rely solely on their own enquiries.

LJ Hooker Atherton
(07) 4091 3144

The thoughtfully designed master wing offers privacy and comfort with a generous bedroom, ensuite, walk-in robe, private deck, and home office-plus a sitting area ideal for a relaxing afternoon drink.

The southern wing caters to family and guests with spacious bedrooms, all featuring built-in robes and views, plus a well sized main bathroom and large laundry.

Step outside to your own private retreat: a large inground pool complete with a tranquil waterfall feature-perfect for summer days.

The land is flat, fertile, and fully usable-ideal for those looking to run livestock, plant fruit trees, start a veggie garden, or simply enjoy the open space and manicured lawns. The property is fully fenced and includes:

A powered shed near the home with lockable storage and a covered area.

A large shed on the eastern boundary with high clearance, perfect for boats, caravans, or machinery.

Water is supplied via bore, and mains power is connected.

If you're seeking space, lifestyle, and a home that offers both luxury and practicality-this is the property for you. Contact exclusive marketing agent Alex Payne today for more information.

More About this Property

Property ID	S1GF1S
Property Type	House
House Size	349 m2
Land Area	4.28 hectare
Including	Ensuite Pool Balcony Built-in-Robes Fully Fenced Water Tank

Alex Payne 0409 328 153

Property Sales Consultant | alex@ljhookerpropertyplus.com

LJ Hooker Atherton (07) 4091 3144

10 Main Street, ATHERTON QLD 4883

atherton.ljhooker.com.au | atherton@ljhatherton.com



Disclaimer: All information contained therein is gathered from relevant third parties sources.

We cannot guarantee or give any warranty about the information provided. Interested parties must rely solely on their own enquiries.

**LJ Hooker Atherton
(07) 4091 3144**

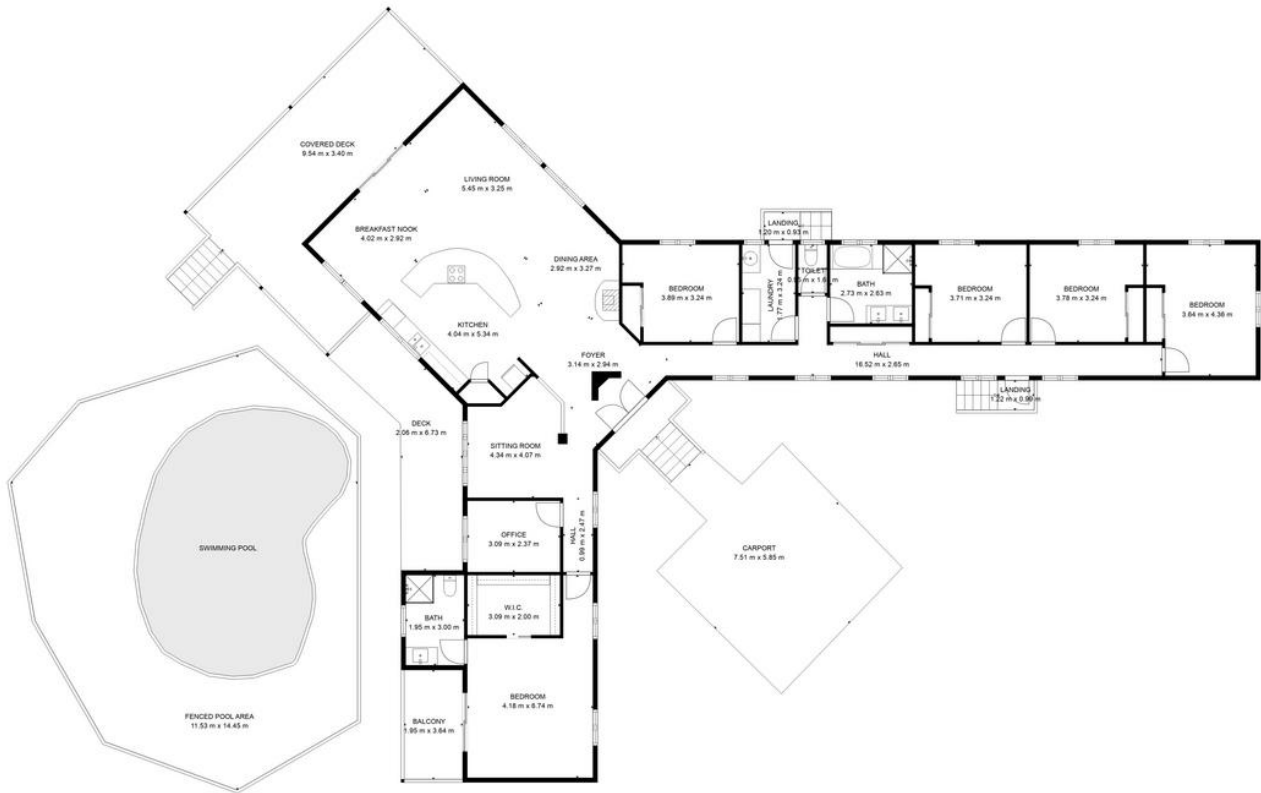

TOTAL: 220 m²
FLOOR 1: 220 m²
**EXCLUDED AREAS: FENCED POOL AREA: 83 m², BALCONY: 7 m², COVERED DECK: 41 m²,
 DECK: 18 m², LANDING: 5 m², CARPORT: 42 m²
 WALLS: 16 m²**

FLOOR PLAN CREATED BY CUBICASA APP. MEASUREMENTS DEEMED HIGHLY RELIABLE BUT NOT GUARANTEED.

