



## Windsor, 608/217 Lutwyche Road

### STUNNING OUTLOOK & MOVE IN READY!

Stylish and contemporary there is nothing left for you to do but enjoy the sophisticated lifestyle offered by this brilliant apartment! This property provides you with the convenience of inner-city living, public transport connectivity, and a plethora of greenspaces on your doorstep.

The ducted air-conditioned living area flows to the kitchen complete with dishwasher and stone benchtops. Your private alfresco provides outdoor entertaining options with stunning views and soaring 3.68m ceilings too. The complex also offers secure allocated garage parking.

#### FEATURES:

- + Built in 2022
- + East Facing towards Albion and city glimpses to the south
- + 2.88m Ceilings in Living Area



**Disclaimer:** All information contained therein is gathered from relevant third parties sources. We cannot guarantee or give any warranty about the information provided. Interested parties must rely solely on their own enquiries.

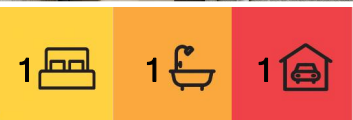

**For Sale**  
Please Call

**View**  
[ljhooker.com.au/1DU1F4N](https://ljhooker.com.au/1DU1F4N)

**Contact**  
**Lucy West**  
0422 175 322  
[lucy.west@ljhooker.com.au](mailto:lucy.west@ljhooker.com.au)

**LJ Hooker Stafford**  
(07) 3357 1888

- + Open-plan lounge/dining area
- + Modern kitchen with dishwasher and stone benchtops.
- + Carpeted bedroom.
- + Ducted AC
- + Secure garage space.
- + Intercom and fob access

You will feel totally connected with a direct link to the city at only 3 km. Conveniently located for busway links, the RBW Hospital and the future Olympic precinct this unit is ideal for a first home buyer or smart investor.

Please contact Lucy West for further details.

## More About this Property

<b>Property ID</b>	1DU1F4N
<b>Property Type</b>	Apartment
<b>Including</b>	Balcony Dishwasher

**Lucy West 0422 175 322**

Sales & Marketing Consultant | [lucy.west@ljhooker.com.au](mailto:lucy.west@ljhooker.com.au)

**LJ Hooker Stafford (07) 3357 1888**

205 Stafford Road, STAFFORD QLD 4053

[stafford.ljhooker.com.au](http://stafford.ljhooker.com.au) | [stafford@ljhooker.com.au](mailto:stafford@ljhooker.com.au)

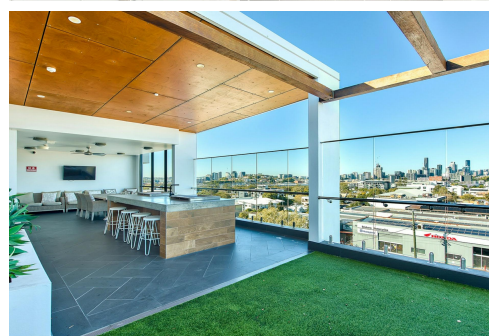

**Disclaimer:** All information contained therein is gathered from relevant third parties sources. We cannot guarantee or give any warranty about the information provided. Interested parties must rely solely on their own enquiries.

**LJ Hooker Stafford**  
**(07) 3357 1888**



**608/217 Lutwyche Rd,  
Lutwyche**



**FLOOR AREA SIZES**

Internal	50.8m <sup>2</sup>
External	11.7m <sup>2</sup>
Car Space	14.0m <sup>2</sup>
<b>TOTAL</b>	<b>76.5m<sup>2</sup></b>

Whilst every attempt has been made to ensure the accuracy of the floor plans contained here, measurements of doors, windows, rooms and any other items are approximate and no responsibility is taken for any error, omission or misstatement.

These plans are for representation purposes only. Provided by primepixels.com.au