



33 Rayner Road, Whale Beach



'Illowra' Unique Oceanfront Resort at Whale Beach

Positioned at the end of prestigious Rayner Road, this pavilion-inspired residence is a striking celebration of modern beach house design. 'Illowra' captures the very essence of coastal living, supremely private, architecturally bold, and designed to showcase some of the most extraordinary ocean views on the Northern Beaches.

The home's distinctive circular pavilion form, with its floor-to-ceiling glass, creates a breathtaking connection to the natural surrounds. Every curve and angle has been meticulously crafted to frame the Pacific Ocean, Whale Beach and the endless horizon beyond, filling interiors with light and an ever-changing coastal panorama.

Set across a generous 1002sqm parcel, this five-bedroom, 4.5-bathroom residence has been envisioned for multi-generational living and effortless entertaining. Defined living zones offer both connection and privacy, while multiple terraces and alfresco spaces make the most of the home's extraordinary setting.

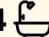
Two master suites, each occupying its own level, provide a private sanctuary. Both feature ensuites with dual vanities and mesmerising outlooks, while one showcases a custom round bath cocooned in

5  4  5 

FOR SALE
Contact Agent

VIEW
By Appointment

AGENTS
David Edwards
0415 440 044
dedwards@ljhpb.com.au

BJ Edwards
0420 304 140
bjedwards@ljhpb.com.au

AGENCY
LJ Hooker Palm Beach
(02) 9974 5999

All information contained therein is gathered from relevant third parties sources.
We cannot guarantee or give any warranty about the information provided.
Interested parties must rely solely on their own enquiries.

 **LJ Hooker**

glass which is a remarkable design statement that brings the ocean almost within reach.

Every element is designed to enhance the lifestyle experience:

- Expansive open-plan kitchen, dining, and living flowing seamlessly to the oceanfront terraces
- A resort-style pool and spa framed by sun-drenched decks
- Private sitting room, spacious lounge, and covered alfresco entertaining with spectacular Whale Beach views
- Warm timber flooring balancing architectural drama with comfort
- Abundant storage and thoughtful functionality throughout

For practicality and peace of mind, the property also provides spacious garaging for up to three cars, complemented by additional off-street parking. Whether hosting family and friends or enjoying the home as a private retreat, this feature ensures convenience, security, and ease of living in one of Whale Beach's most exclusive addresses.

From sunrise to sunset, 'Illowra' offers a privileged perspective of one of Australia's most celebrated coastlines. Unique, private, and awe-inspiring, it is not just a home, it is a world-class coastal retreat unlike any other.

MORE DETAILS

Property ID	BQTF6Z
Property Type	House
Land Area	1002 m2

David Edwards 0415 440 044

Director | Licensee | David Edwards Palm Beach Realty Pty Ltd CLN 348342 | dedwards@ljhpb.com.au

BJ Edwards 0420 304 140

Licensed Real Estate Agent | bjedwards@ljhpb.com.au

LJ Hooker Palm Beach (02) 9974 5999

1073 Barrenjoey Road, PALM BEACH NSW 2108
palmbeach.ljhooker.com.au | office@ljhpb.com.au



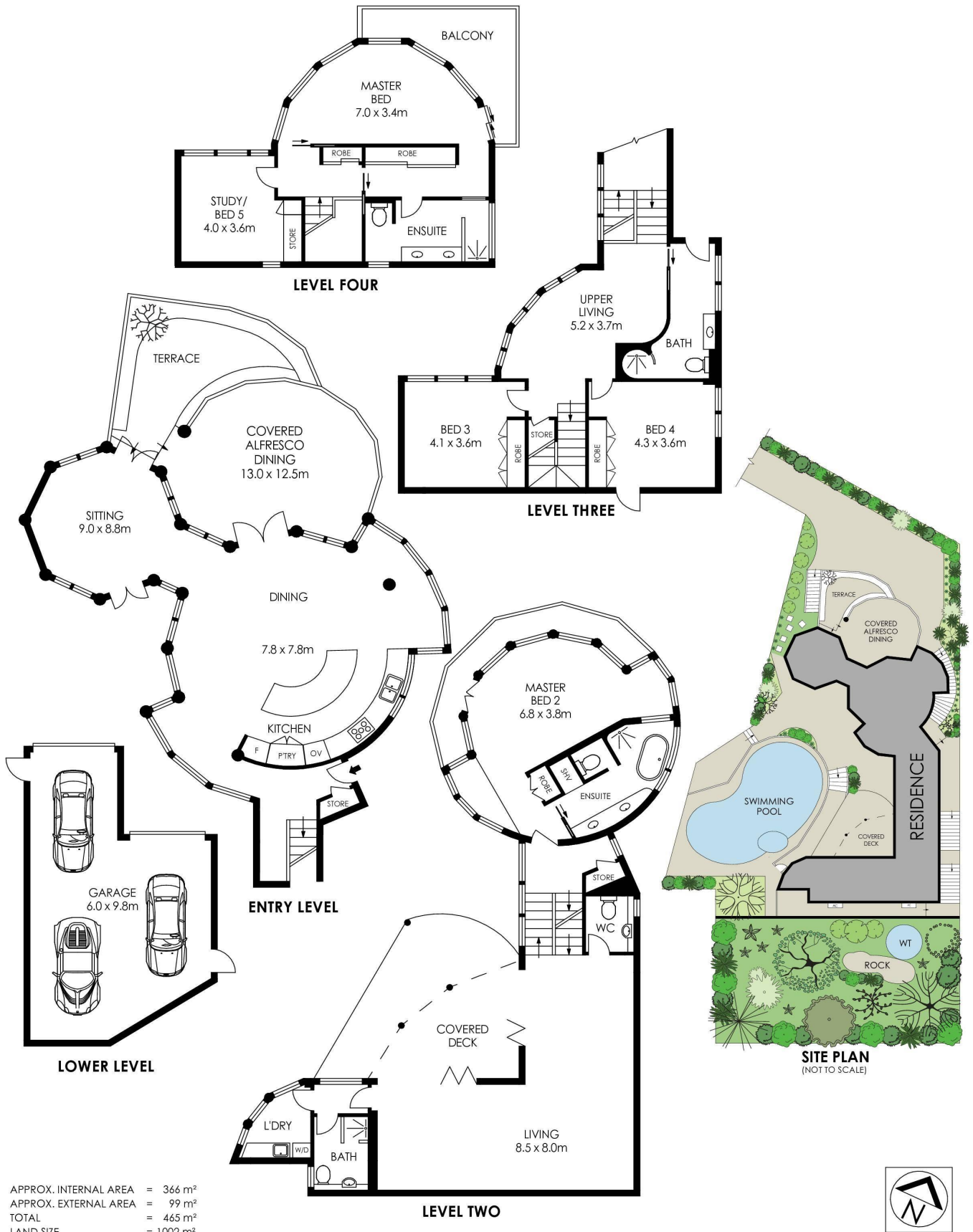

APPROX. INTERNAL AREA = 366 m²
 APPROX. EXTERNAL AREA = 99 m²
 TOTAL = 465 m²
 LAND SIZE = 1002 m²

PLANS SHOWN ONLY INDICATIVE OF LAYOUT. DIMENSIONS ARE APPROXIMATE.



33 Rayner Road, Whale Beach



All information contained therein is gathered from relevant third parties sources.
 We cannot guarantee or give any warranty about the information provided.
 Interested parties must rely solely on their own enquiries.

