

30 Beauty Drive, Whale Beach

"Casa Belle" Dual Beach and Pittwater Views, Stately Home with Pool in Prized Position

Tucked away at the very end of an exclusive cul-de-sac, this substantial family residence offers rare privacy, space and effortless coastal living in one of Whale Beach's most tightly held pockets, complete with easy level entry and drive-in access. Bathed in all-day northerly sunshine and capturing sweeping dual vistas across Pittwater and the ocean, the home offers a sense of serenity and seclusion just moments from the sand. Designed for relaxed family living and entertaining, Casa Belle is defined by its solid construction, generous proportions and seamless indoor-outdoor flow. High ceilings and expansive living zones enhance the feeling of space, while easy level access ensures everyday practicality.

- Sun-drenched northerly aspect with dual Pittwater and ocean views
- Expansive main living area opening to a balcony with sweeping water views
- Striking in-ground swimming pool and spa framed by sandstone terraces
- Modern kitchen connecting to a large secondary living/rumpus room

All information contained therein is gathered from relevant third parties sources. We cannot guarantee or give any warranty about the information provided. Interested parties must rely solely on their own enquiries.

6 4 4

FOR SALE

Buyers Guide \$5.8m

VIEW

Sat 2nd May @ 11:15AM - 11:45AM

AGENTS

Peter Robinson

0401 219 077

peter.robinson@ljhooker.com.au

AGENCY

LJ Hooker Palm Beach

(02) 9974 5999

LJ Hooker

- Generous master retreat with walk-in robe, ensuite, private balcony and Pittwater outlook
- Four additional double bedrooms/offices with two well-appointed bathrooms
- " Self-contained one-bedroom flat with private entrance —ideal for guests, extended family or income
- Double garage with mezzanine storage and internal access, plus ample off-street parking
- Quality finishes are showcased throughout, highlighted by striking marble stairs at the entrance leading to the upper level, complemented by marble stairs leading to the basement
- Natural stone and timber flooring add warmth and timeless elegance, creating an inviting and sophisticated atmosphere
- Level lawn, two private courtyards and large internal laundry
- Easy level access into the home, internal access from the garage
- Exceptionally private setting at the end of a quiet cul-de-sac
- Positioned approximately 300m from both the Pittwater and the golden sands of Whale Beach

Offering space, flexibility and a blue-chip coastal address, this is an exceptional opportunity as a permanent residence, luxurious holiday retreat or investment—just moments from the iconic sands of Whale Beach.

MORE DETAILS

Property ID	BUGF6Z
Property Type	House
Land Area	720.8 m2
Including	Ensuite Ocean Views Pool Water Views

Peter Robinson 0401 219 077

Principal & Peter Robinson Real Estate Pty Ltd CLN 10121506 | peter.robinson@ljhooker.com.au

LJ Hooker Palm Beach (02) 9974 5999

1073 Barrenjoey Road, PALM BEACH NSW 2108
palmbeach.ljhooker.com.au | office@ljhpb.com.au

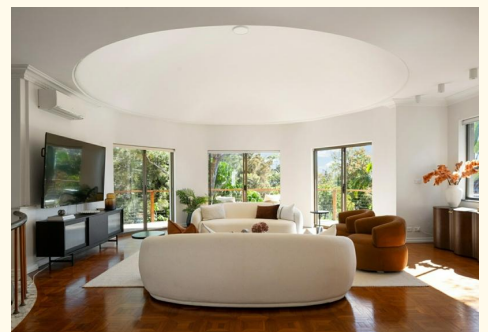

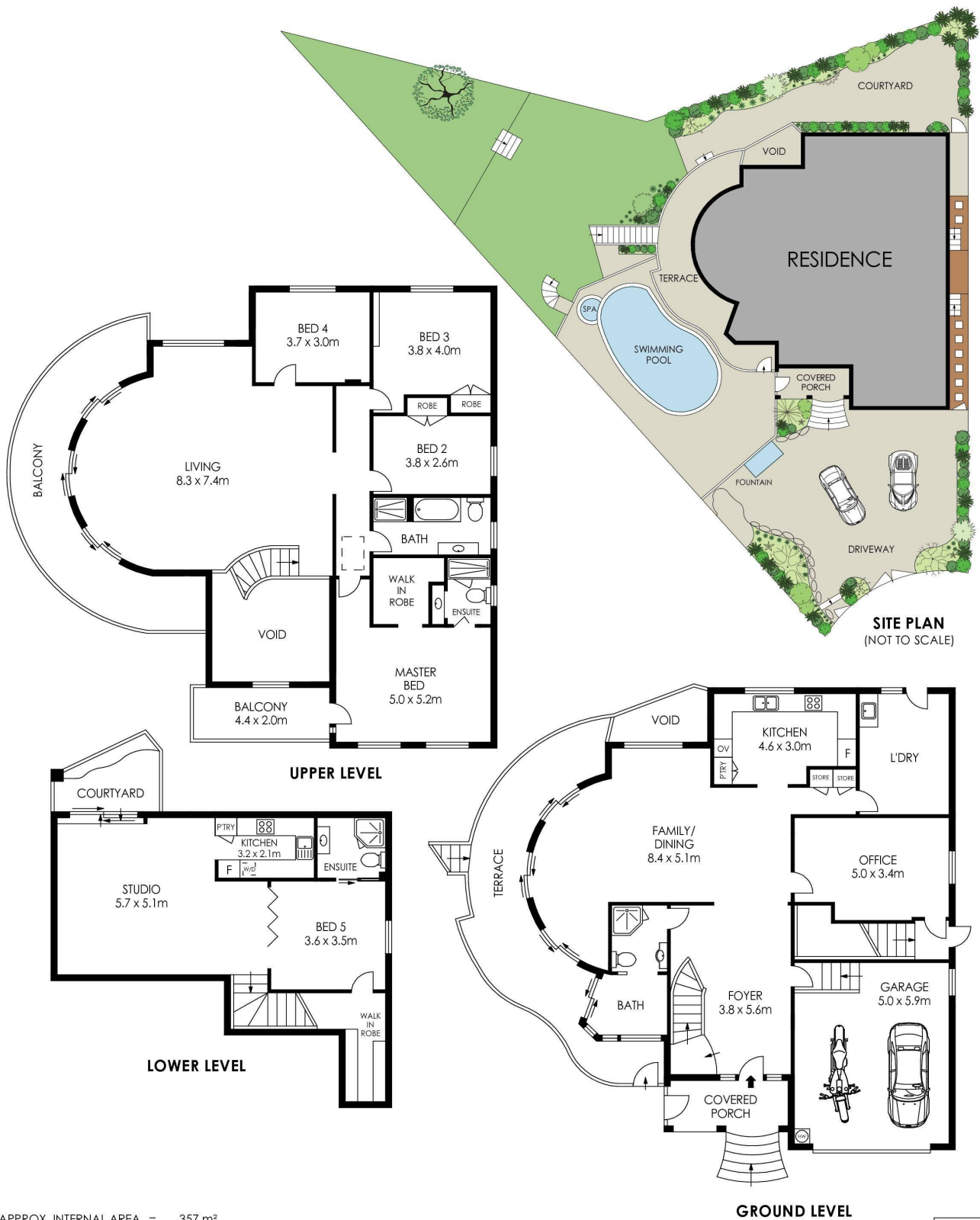

APPROX. INTERNAL AREA = 357 m²
 APPROX. EXTERNAL AREA = 73 m²
 TOTAL = 430 m²
 LAND SIZE = 720.8 m²

PLANS SHOWN ONLY INDICATIVE OF LAYOUT. DIMENSIONS ARE APPROXIMATE.

30 Beauty Drive, Whale Beach

All information contained therein is gathered from relevant third parties sources.
 We cannot guarantee or give any warranty about the information provided.
 Interested parties must rely solely on their own enquiries.