

25 Rayner Road, Whale Beach

Privacy, Panorama and Position; North-Facing Beach House with Ocean Views

Bathed in natural light and perfectly oriented to the north, this exceptional beach house captures the essence of relaxed coastal living with sweeping ocean and district views that feel both expansive and private.

Extensively renovated, the residence promises effortless, low-maintenance living without compromise. Designed to adapt as families grow, the home offers up to four generous bedrooms, including two with ensuites. The master retreat enjoys soft, tree-filtered views across Careel Bay, while the versatile fourth bedroom easily transforms into a media room or home office for those who value flexibility as part of a modern lifestyle.

At the heart of the home, a wall of glass spans the open-plan living and dining area, inviting the outdoors in and flooding the interiors with sunlight. This space flows seamlessly to a substantial semi-enclosed deck - a sheltered haven for alfresco entertaining and a breathtaking vantage point from which to savour the ever-changing ocean panorama. From sunrise light to coastal sunsets, the views are

4 🏠 3 🚿 4 🚗

FOR SALE
Guide \$4.75m

VIEW
By Appointment

AGENTS
BJ Edwards
0420 304 140
bjedwards@ljhpb.com.au

David Edwards
0415 440 044
dedwards@ljhpb.com.au

AGENCY
LJ Hooker Palm Beach
(02) 9974 5999

All information contained therein is gathered from relevant third parties sources.
We cannot guarantee or give any warranty about the information provided.
Interested parties must rely solely on their own enquiries.

 **LJ Hooker**

nothing short of captivating.

The living area is complemented by a well-appointed granite kitchen with breakfast bar and quality stainless steel appliances, ideal for both everyday living and hosting with ease. Thoughtful luxuries continue throughout, with spa baths in the main bathroom and media ensuite creating moments of indulgence.

Comfort is assured year-round with ducted air conditioning, while polished timber floors add warmth and elegance to the living spaces. All bedrooms include built-in wardrobes, and practical features such as an internal laundry, internal access to the automated double lock-up garage, and additional off-street parking further enhance daily convenience.

Privately set, beautifully renovated and framed by stunning ocean views, this light-filled coastal home delivers an enviable lifestyle where ease, outlook and position come together perfectly.

MORE DETAILS

Property ID	BS0F6Z
Property Type	House
Land Area	942 m2
Including	Ocean Views Water Views

BJ Edwards 0420 304 140

Licensed Real Estate Agent | bjedwards@ljhpb.com.au

David Edwards 0415 440 044

Director | Licensee | David Edwards Palm Beach Realty Pty Ltd CLN 348342 | dedwards@ljhpb.com.au

LJ Hooker Palm Beach (02) 9974 5999

1073 Barrenjoey Road, PALM BEACH NSW 2108
palmbeach.ljhooker.com.au | office@ljhpb.com.au



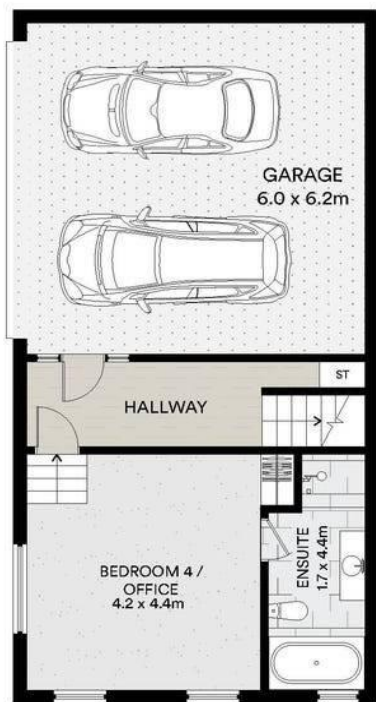

LOWER LEVEL



ENTRY LEVEL



All information contained in this document is from sources we believe to be accurate, however we cannot guarantee its accuracy. Interested persons should make and rely on their own enquiries in relation to measurements, dimensions, layout, furniture and descriptions.

APPROX. INTERNAL AREA: 234M²
 APPROX. EXTERNAL AREA: 48M²
 APPROX. TOTAL AREA: 282M²
 APPROX. LAND AREA: 923M²

All information contained therein is gathered from relevant third parties sources. We cannot guarantee or give any warranty about the information provided. Interested parties must rely solely on their own enquiries.