





1039 The Horsley Drive, Wetherill Park

## Solid Brick Home in Prime Location

Enjoy the convenience of being close to Market Town, Tafe, Stockland Wetherill Park, schools, public transport and T - Ways. Move straight in, invest or run a home business, the option is yours. Owner is ready to sell so don't miss out.

- 3 good size bedrooms
- Spacious lounge room
- Kitchen with meals area
- Updated bathroom
- 557 sqm block 15m frontage (approx.)
- Granny flat potential (s.t.c.a)

**DISCLAIMER:** We have in preparing this information used our best endeavours to ensure that the information contained therein is true and accurate however, accept no responsibility and disclaim all liability in respect of any errors, inaccuracies or misstatements contained herein. Prospective buyers should make their own enquiries to verify the information contained herein

3  1  1 

**FOR SALE**  
UNDER OFFER

### AGENTS

Amelle Ghassibe  
0424 754 232  
aghasibe@ljhfairfield.com.au

### AGENCY

LJ Hooker Fairfield  
(02) 9727 7766

All information contained therein is gathered from relevant third parties sources. We cannot guarantee or give any warranty about the information provided. Interested parties must rely solely on their own enquiries.



## MORE DETAILS

Property ID 143EF99  
Property Type House  
Land Area 557 m2

**Amelle Ghassibe 0424 754 232**  
Residential Sales | [aghasibe@ljhfairfield.com.au](mailto:aghasibe@ljhfairfield.com.au)

**LJ Hooker Fairfield (02) 9727 7766**  
195b The Boulevard, FAIRFIELD HEIGHTS NSW 2165  
[fairfield.ljhooker.com.au](http://fairfield.ljhooker.com.au) | [fairfield@ljhfairfield.com.au](mailto:fairfield@ljhfairfield.com.au)



All information contained therein is gathered from relevant third parties sources.  
We cannot guarantee or give any warranty about the information provided.  
Interested parties must rely solely on their own enquiries.



Floor Plan

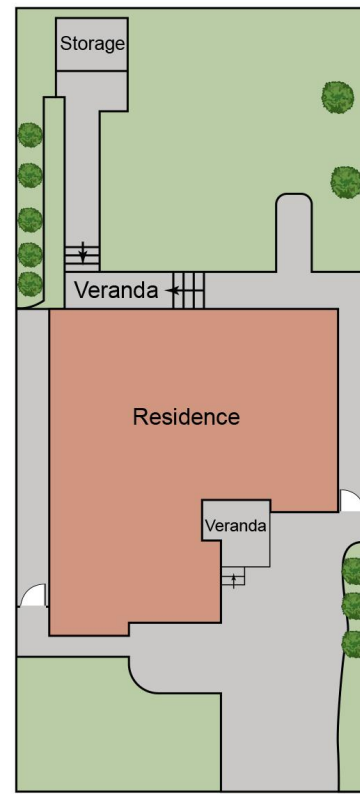

Site Plan

**1039 The Horsley Drive  
Wetherill Park 2164**

Scales in metres. Indicative only. Dimensions are approximate. All information contained here in is gathered from sources we believe to be reliable. However we cannot guarantee its accuracy and interested persons should rely on their own enquiries.

