

## Wellington Point, 22 Spurs Drive

Superb Location - High Breezy Position - Great Value

Nestled in the heart of the sought-after Wellington Point, this stunning residence offers a blend of coastal living, vibrant café culture, and the idyllic Redlands lifestyle. Enjoy the best of both worlds: cool bay breezes and modern comforts, including air conditioning and an expansive outdoor entertaining space. Whether you're soaking in the views from your elevated position or taking a refreshing dip in the breathtaking infinity-edge pool, your summers will be transformed.

This property is a true entertainer's delight, boasting a vast outdoor area perfect for hosting memorable gatherings with family and friends. The seamless flow from the modern kitchen, complete with stone benchtops, to the alfresco zone and pool ensures easy living. With abundant storage, a double lock-up garage, double carport, and generous side access for your boat or caravan, this home is designed for those who crave space and flexibility.



**For Sale**  
Offers Over \$1,200,000

**View**  
[ljhooker.com.au/BSN3F2S](http://ljhooker.com.au/BSN3F2S)

**Contact**  
**Bruce Hutchison**  
0403 245 556  
[bruce@ljhpropertycentre.com.au](mailto:bruce@ljhpropertycentre.com.au)



**LJ Hooker Property Centre**  
**(07) 3286 2500**

**Disclaimer:** All information contained therein is gathered from relevant third parties sources. We cannot guarantee or give any warranty about the information provided. Interested parties must rely solely on their own enquiries.

The downstairs level offers two spacious living areas, a well-appointed bathroom, a large laundry, and two oversized walk-in storage closets, while upstairs, four bedrooms and two bathrooms provide ample privacy for the family. Eco-friendly features like a 5kW solar power system and solar hot water to help keep energy costs down.

At a glance:

- \*4-car accommodation, including side access for a boat or caravan
- \*Infinity-edge pool with spectacular views
- \*Multiple living areas for versatile entertaining
- \*Central location, close to public transport and top schools
- \*Energy-efficient with solar power and solar hot water
- \*Freshly painted internally throughout
- \*Nearby schools: Wellington Point Primary & High, Birkdale Primary, Ormiston College, and more

Just a stones throw to popular Horizon Shopping Village & bus transportation just steps away and Wellington Point train station within a 17-minute walk, convenience is at your doorstep. This exceptional home won't last long-act now to secure your piece of paradise!

## More About this Property

<b>Property ID</b>	BSN3F2S
<b>Property Type</b>	House
<b>Land Area</b>	710 m <sup>2</sup>
<b>Including</b>	Outdoor Entertaining

**Bruce Hutchison 0403 245 556**  
Independent Contractor - Starsky Enterprises Pty Ltd |  
bruce@ljhpropertycentre.com.au

**LJ Hooker Property Centre (07) 3286 2500**  
152-164 Shore Street West, Raby Bay, Brisbane QLD 4163  
propertycentre.ljhooker.com.au | hello@ljhpc.com.au



**LJ Hooker Property Centre**  
**(07) 3286 2500**

**Disclaimer:** All information contained therein is gathered from relevant third parties sources. We cannot guarantee or give any warranty about the information provided. Interested parties must rely solely on their own enquiries.



:: FLOOR PLAN  
First Floor



:: FLOOR PLAN  
Ground Floor

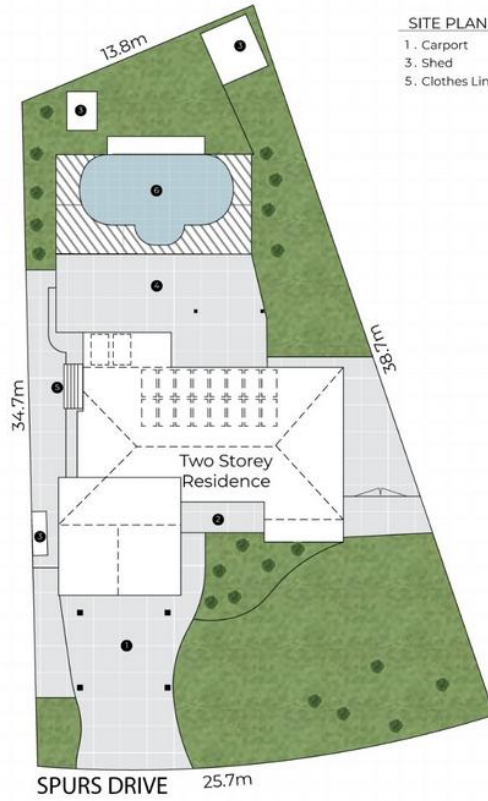

SITE PLAN LEGEND

- 1. Carport    2. Porch
- 3. Shed       4. Alfresco
- 5. Clothes Line   6. Pool



22 Spurs Drive, Wellington Point



Whilst every attempt has been made to ensure the accuracy of the floor plan contained here, measurements of doors, windows, rooms and any other items are approximate and no responsibility is taken for any error, omission, or misstatement. This plan is for illustrative purposes only and should be used as such by any prospective buyer.