



52 Norwood Avenue, Weir Views

First-Home Buyer & Investor Opportunity - 4-Bedroom Home in Thriving Suburb

Perfectly suited for first-home buyers and savvy investors, this modern 4-bedroom, 2-bathroom home offers low-maintenance living in one of Melbourne's fastest-growing suburbs.

Featuring a light-filled open-plan living and dining area, ducted heating throughout, and a split system in the living zone for year-round comfort. The master bedroom includes a walk-in robe and ensuite, while the remaining bedrooms are fitted with built-in robes. Outside, enjoy a spacious backyard ideal for kids, entertaining, or future landscaping, plus a double garage with internal access.

Location Highlights:

- St Lawrence of Brindisi Catholic Primary School - 1.2km
- New Toolern Waters Primary School (opening soon) - 2km
- Aspire Early Education & Kindergarten - 1.5km

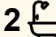
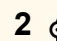
4  2  2 

FOR SALE
\$549,000- \$599,000

AGENTS
Yohanna Saad
0423 523 061
yohanna.saad@ljhmelton.com.au

Anuj Narwal
0410 120 588
anuj.narwal@ljhmelton.com.au

AGENCY
LJ Hooker Melton
(03) 8797 5588

All information contained therein is gathered from relevant third parties sources. We cannot guarantee or give any warranty about the information provided. Interested parties must rely solely on their own enquiries.

 **LJ Hooker**

- Al Iman College - 2.8km
- Melton South Primary School - 3.8km
- Melton Secondary College - 4.2km
- Opalia Shopping Centre - 1.5km
- Melton South Train Station - 4km
- Easy access to the Western Freeway and local parklands

Whether you're entering the market or adding to your investment portfolio, this property combines modern comfort, family-friendly design, and a prime position surrounded by new schools, childcare, and major amenities.

A fantastic opportunity to secure a quality home in a thriving, high-growth pocket of Weir Views.

Don't miss your chance to secure this wonderful property - it won't last long!

Call Yohanna Saad on 0423 523 061 to inspect today!

DISCLAIMER: All stated dimensions are approximate only. Particulars given are for general information only and do not constitute any representation on the part of the vendor or agent.

Please see the below link for an up-to-date copy of the Due Diligence Check List:

<http://www.consumer.vic.gov.au/duediligencechecklist>

MORE DETAILS

| | |
|---------------|-------------|
| Property ID | RGXHWU |
| Property Type | House |
| Land Area | 408 m2 |
| Including | Ensuite |
| | Toilets (2) |

Yohanna Saad 0423 523 061
 Sales Agent | yohanna.saad@ljhmelton.com.au
Anuj Narwal 0410 120 588
 Director | anuj.narwal@ljhmelton.com.au

LJ Hooker Melton (03) 8797 5588
 307 High Street, MELTON VIC 3337
 melton.ljhooker.com.au | admin@ljhmelton.com.au



Floor Plan

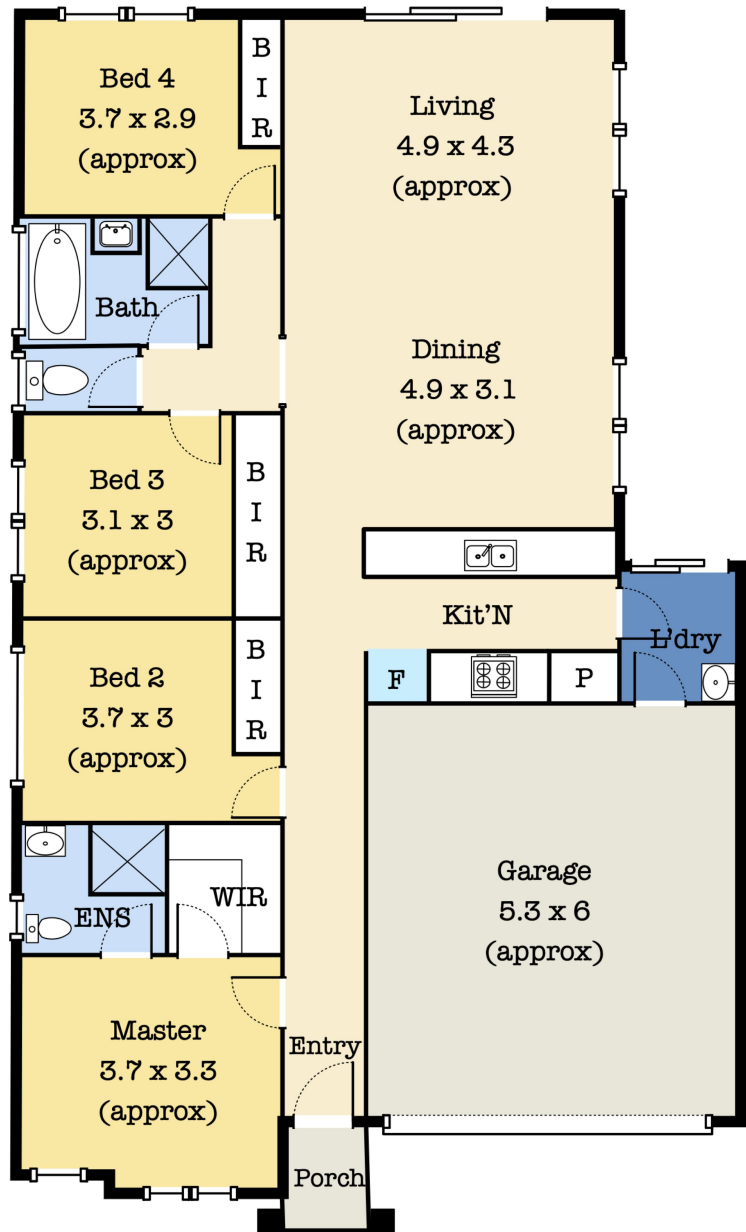
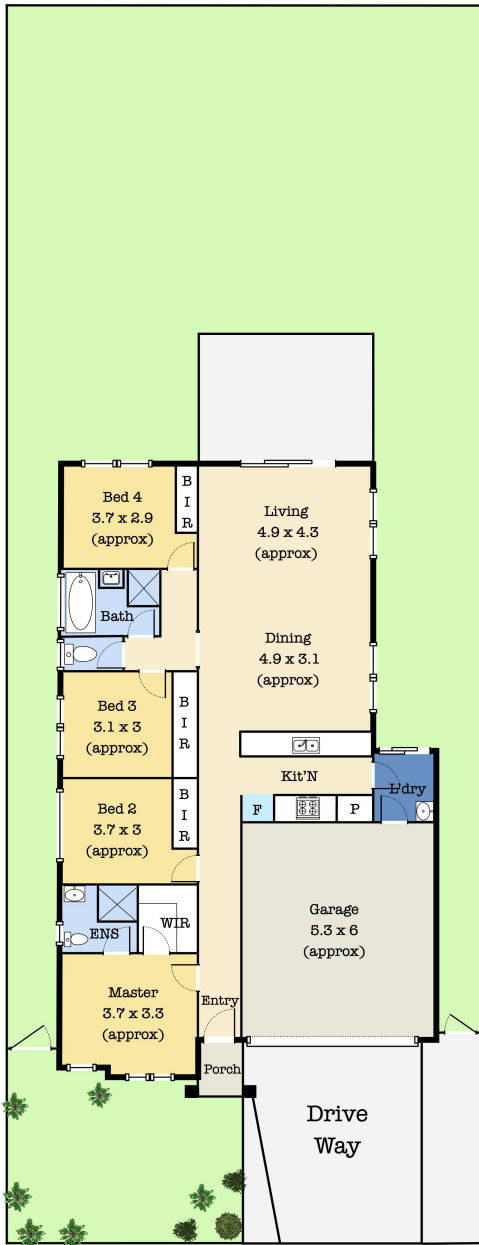

52 Norwood Ave, Weir Views VIC 3338

*This floorplan is for illustration purposes only and no warranty is given to its accuracy. Purchasers are advised to carry out their own investigations.

All information contained therein is gathered from relevant third parties sources. We cannot guarantee or give any warranty about the information provided. Interested parties must rely solely on their own enquiries.