

56 Dover Road, Wamberal

## Luxe Coastal Living Moments From the Beach

Recently renovated and beautifully reimagined, this stunning tri-level coastal residence blends relaxed beachside charm with elevated contemporary design. Featuring a charming weatherboard exterior and a spacious split-level floorplan, the home offers generous proportions, multiple living zones and seamless indoor—outdoor entertaining.

Inside, a refined neutral palette and layered textures create a calm, sophisticated atmosphere, complemented by designer lighting and quality finishes throughout. At the heart of the home is a spacious entertainer's kitchen with timeless finishes, premium appliances and ample storage, flowing effortlessly into the living and entertaining areas.

The private master suite serves as a peaceful retreat, complete with a walk-in robe and beautifully appointed ensuite. Additional bedrooms are well-sized and supported by two stylish bathrooms plus a powder room for added convenience.

Outdoors, a generous entertaining deck overlooks a sparkling swimming pool and private yard - perfect for summer gatherings and

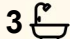
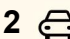
4  3  2 

### AUCTION

Sat 18th Apr @ 3:00PM

### VIEW

Sat 4th Apr @ 11:10AM - 11:30AM

### AGENTS

Michael Ahearn  
0466 464 240  
michael.ahearn@ljhooker.com.au

Matthew Farrugia  
0403 661 499  
matthew.farrugia@ljhooker.com.au

### AGENCY

LJ Hooker Terrigal  
(02) 4385 8444

All information contained therein is gathered from relevant third parties sources.  
We cannot guarantee or give any warranty about the information provided.  
Interested parties must rely solely on their own enquiries.

 **LJ Hooker**

relaxed weekends. Just a short stroll to the beach, lagoon and local cafés, this beautifully renovated home offers the ultimate coastal lifestyle.

**Key features:**

- Fully renovated tri-level home on an expansive 670sqm block walking distance to the beach
- 4 generous bedrooms all with built-in robes. Master bedroom boasts large walk-in wardrobe and luxurious ensuite
- Multiple living areas provide flexibility for families and guests
- 3 well appointed bathrooms, plus additional powder room
- Striking modern coastal kitchen with integrated appliances, induction cooktop, stone benchtops and butler's pantry
- Spacious laundry with ample storage and external access
- Ducted a/c, electric fireplace and ceiling fans throughout
- Flooring is a mix of stunning travertine tiles and carpet, complemented by Velux skylights and statement lighting
- Covered entertaining deck with outdoor kitchen and built-in BBQ
- In-ground swimming pool and large level backyard
- Pool house to store pool equipment, toys and furniture
- Double lock-up garage and additional off-street parking in driveway
- A short 10-minute stroll to Wamberal Beach, restaurants and cafes. 5-minute drive to Terrigal Beach and town centre. 10 minutes to Erina Fair shopping centre and 25 minutes to M1 freeway to Sydney and Newcastle

**Rates:**

Council Rates \$3,274.18 Per annum

Water Rates \$1,185.08 Per annum

Please note that all information herein is gathered from sources we believe to be reliable. Images, photographs, plans, drawings and maps are indicative only. LJ Hooker Terrigal makes no representation or warranty as to the accuracy of the information provided and accepts no liability for any errors or omissions. All interested parties should make and rely upon their own independent enquiries. All measurements and details are approximate and subject to change without notice.

## MORE DETAILS

Property ID 1HSDGC1  
Property Type House  
Land Area 670 m2  
Including Ensuite  
Air Conditioning  
Dishwasher  
Built-in-Robes  
Close to Schools  
Close to Shops  
Close to Transport  
Garage  
Internal Laundry  
Pool  
Storage

### Michael Ahearn 0466 464 240

Sales Specialist - LREA | michael.ahearn@ljhooker.com.au

### Matthew Farrugia 0403 661 499

Director / Sales Specialist - LREA |  
matthew.farrugia@ljhooker.com.au

### LJ Hooker Terrigal (02) 4385 8444

Shop 1 & 2, 1 Campbell Crescent, TERRIGAL NSW 2260  
terrigan.ljhooker.com.au | terrigan@ljhooker.com.au



# 56 Dover Road Wamberal



MAIN LEVEL

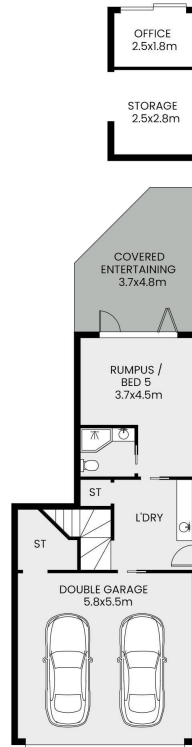

LOWER LEVEL

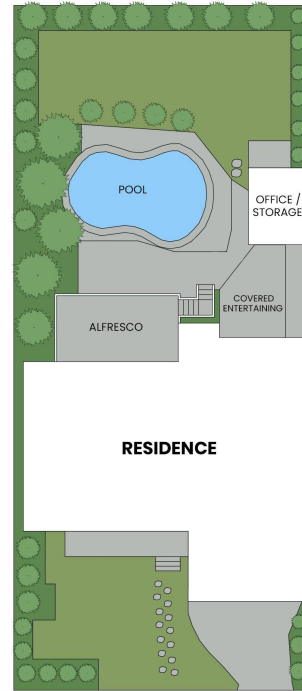

SITE PLAN

Scale in meter. Indicative only. Measurement and dimensions are approximate. All information contained herein is gathered from source we believe to be reliable. However we cannot guarantee its accuracy and interested persons should rely on their own enquiries.

