



Wamberal, 20 Dover Road

Statement of Luxury Seizing Spectacular Views

Revel in the impeccable craftsmanship of this designer beachside residence showcasing ocean views from almost every room. Set in an enviable position, only a 2 minute stroll to Wamberal Beach, shops and cafes, this incredible home boasts expansive interiors capturing natural light and a beautiful sea breeze as it seamlessly connects with the ultimate pool and entertaining area. This is an offer not to be missed to acquire such a statement of luxury for your family home or perfect holiday escape.

-Architectural masterpiece designed and engineered by Malcolm Ellis Design, built by Troy Paul from Hudson Lane Projects, offering a versatile and spacious floorplan adapting to your every need

-Sophisticated coastal styling by interior designer Samantha Bacon, spanning over three split levels of luxury set across a 632sqm block



Disclaimer: All information contained therein is gathered from relevant third parties sources. We cannot guarantee or give any warranty about the information provided. Interested parties must rely solely on their own enquiries.

5

3

2

For Sale

Contact Agent

View

ljhooker.com.au/1FEVGC1

Contact

Michael Ahearn

0466 464 240

michael.ahearn@ljhooker.com.au

Tim Andrews

0412 663 065

tim.andrews@ljhooker.com.au

LJ Hooker Terrigal
(02) 4385 8444

- First floor features an open plan concept with living, dining and kitchen extending out to both front and rear balconies taking in the most magnificent ocean views whilst enjoying the comfort of the grand sandstone fireplace, pitched ceilings and frameless corner windows
- Lavish master suite with walk-in-robe and ensuite bathroom plus second bedroom with built-in-robos and deluxe main bathroom
- Entertainers' kitchen equipped with integrated dishwasher, induction cooktop, large butlers pantry plus stunning curved stone island bench for family and guests to gather
- Ground floor offers two additional bedrooms with built-in-robos serviced by second bathroom with freestanding tub, and lounge room opening out to a covered balcony leading down to the backyard
- Transition to the tranquil entertaining zone with spectacular pool house overlooking the mineral pool surrounded by limestone paving, level grass yard and immaculate landscaping with hedges privately framing creating an ideal retreat for family and friends
- Additional features include James Hardie cladding, entry level concrete slab, engineered oak timber floors, doors and windows by Sublime, A/C, plantation shutters, huge amounts of storage, water tank, dedicated home office, and laundry
- Enjoy the supreme convenience of this blue-ribbon address within walking distance to Terrigal and lagoon, with easy access to public transport, only 10 minutes to Erina Fair Shopping Centre and 15-20 minutes to M1 Freeway to Sydney and Newcastle

More About this Property

Property ID	1FEVGC1
Property Type	House
Land Area	632 m ²
Including	Ensuite Study Air Conditioning Toilets (4) Dishwasher Built-in-Robes Carpeted Close to Shops Close to Transport Family room Garage Heating High Clearance

Michael Ahearn

Sales Specialist | michael.ahearn@ljhooker.com.au

Tim Andrews

Principal / Licensee | tim.andrews@ljhooker.com.au

LJ Hooker Terrigal (02) 4385 8444

Shop 1 & 2, 1 Campbell Crescent, TERRIGAL NSW 2260
terrigan.ljhooker.com.au | terrigan@ljhooker.com.au



LJ Hooker Terrigal
(02) 4385 8444

Disclaimer: All information contained therein is gathered from relevant third parties sources.
We cannot guarantee or give any warranty about the information provided. Interested parties must rely solely on their own enquiries.

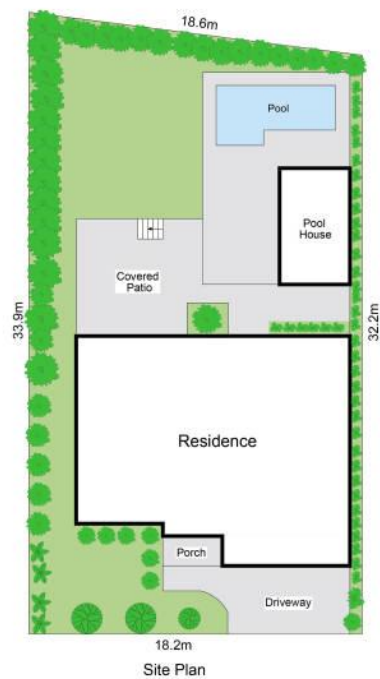

0 1 2 3 4 5 6 7 8 9 10 METRES

Scale in metres. Indicative only. Dimensions are approximate. All information contained herein is gathered from sources we believe to be reliable. However we cannot guarantee its accuracy and interested persons should rely on their own enquiries

INT : 415 m²
EXT : 221 m²



NOT TO SCALE

20 Dover Road, Wamberal