

Wallerawang

Modern Family Brick Veneer on 890 square metres



A comfortable and well presented brick veneer home located in a quiet area of Wallerawang village.

The conventional layout includes 3 bedrooms (2 with built-in wardrobes), a light and modern open plan living, meals and kitchen area with double natural gas stove & breakfast bar, a modern bathroom and laundry with extra toilet.

The real bonus is the large rear sunroom and impressive features such as easy care floating floors and natural gas ducted central heating.

The fully fenced back yard has remote electric gate access, concrete paved driveway and large off street parking space and a double garage with electricity connected.

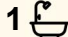
A fantastic opportunity for a first home buyer or young family.

3  1  2 

FOR SALE
\$620,000

VIEW
Sat 27th Jun @ 11:45AM - 12:15PM

AGENTS
Jamie Giokaris
0418 201 028
jgiokaris@ljlithgow.com.au

AGENCY
LJ Hooker Lithgow
(02) 6351 2548

All information contained therein is gathered from relevant third parties sources.
We cannot guarantee or give any warranty about the information provided.
Interested parties must rely solely on their own enquiries.

 **LJ Hooker**

MORE DETAILS

Property ID 1JSVF9X
Property Type House
House Size 120 m2
Land Area 890 m2

Jamie Giokaris 0418 201 028
Principal | jgiokaris@ljhlithgow.com.au

LJ Hooker Lithgow (02) 6351 2548
201 Main Street, LITHGOW NSW 2790
lithgow.ljhooker.com.au | enquiries@ljhlithgow.com.au



All information contained therein is gathered from relevant third parties sources.
We cannot guarantee or give any warranty about the information provided.
Interested parties must rely solely on their own enquiries.

5 Lidsdale Street, Wallerawang

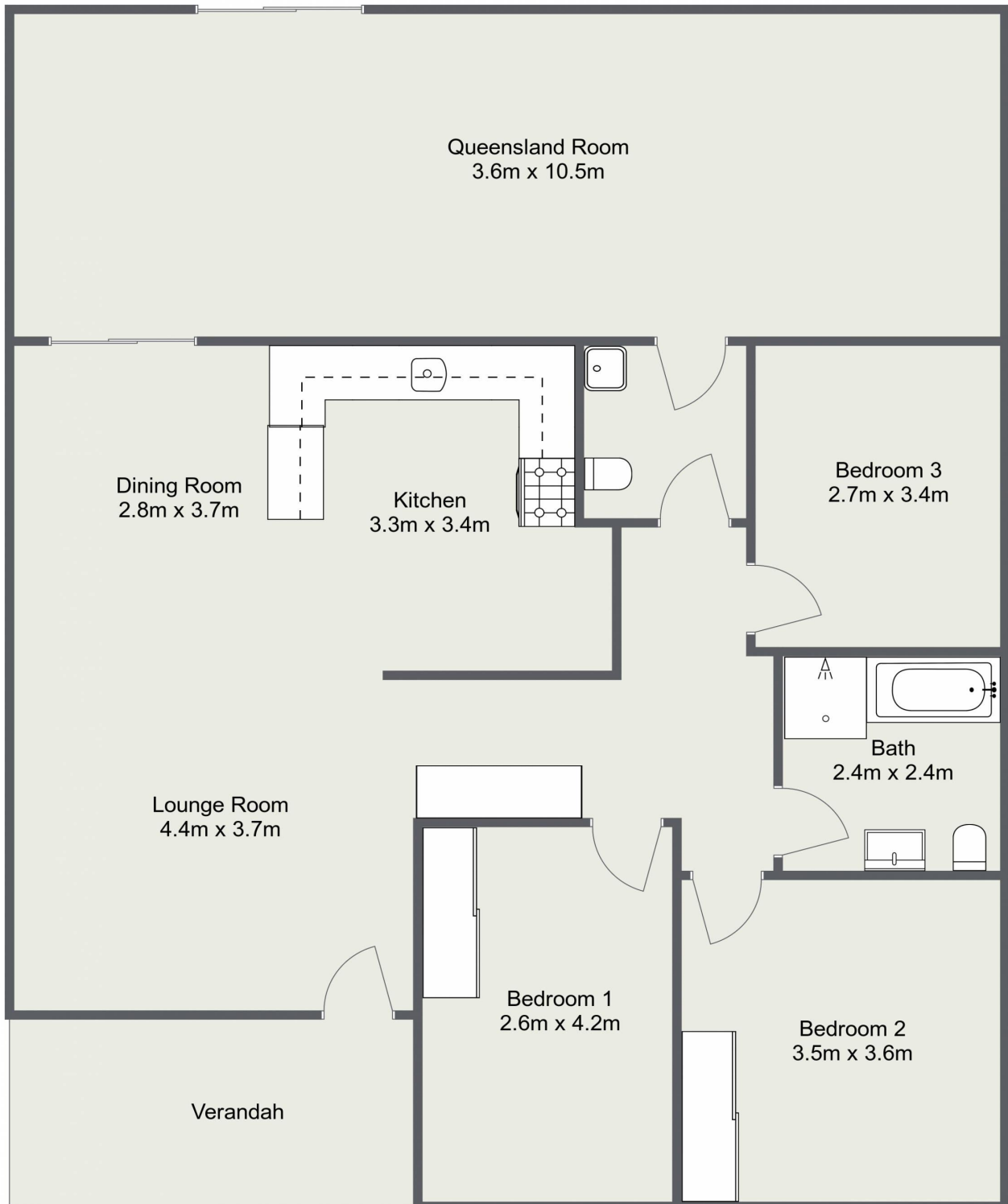

Please Note: The above dimensions are approximate and are intended to be used as a guide only.
Interested parties are urged to rely on their own enquiries.