



Victoria Point, 10 Carl Jung Court

Sold By Karen Renouf

Ideally positioned in a highly sought after cul de sac, surrounded by quality homes, this elevated 836m² block enjoys stunning water views standing in the back garden. A lowset, neat and tidy, solidly built home is situated on one side of the block allowing for a second dwelling, your dream home, and the land could also accommodate a duplex. Only a short stroll to the waterfront esplanade walking path and offering endless exciting possibilities on a rare gem of a block —this property is a must-see!

*Open plan dining and living room with laminate floors opening onto a conservatory overlooking the garden.

*Galley kitchen with breakfast bar, pantry and electric freestanding oven and cooktop.

*Master bedroom with air conditioning and built ins, second good sized bedroom with built ins.

*Bathroom with shower and vanity, separate toilet and large laundry.

*Extras include security screens and neutral colour palette.

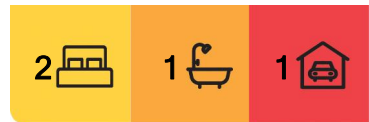

For Sale
Expression of Interest

View
ljhooker.com.au/BSXGF2S

Contact
Karen Renouf
0413 473 461
krenouf@ljhpropertycentre.com.au

Tony Webber
0457 637 578
twebber@ljhpropertycentre.com.au



LJ Hooker Property Centre
(07) 3286 2500

Disclaimer: All information contained therein is gathered from relevant third parties sources. We cannot guarantee or give any warranty about the information provided. Interested parties must rely solely on their own enquiries.

*Fully fenced 836m2 block laid to lawn with 2 mature trees —avocado and mango, garden shed.

*Single carport, gated, generous side access and off-street parking for multiple additional vehicles.

*Outstanding location —quiet, residential cul de sac with quality homes only 1 street from the stunning waterfront esplanade with beaches and parkland.

*Close to all your dining and shopping needs at Victoria Point shopping centre and world class schools, including Sheldon College.

This property provides the perfect backdrop for a breathtaking Bayside lifestyle. Easy commuting distance to Brisbane CBD.

Call now to book an inspection and become part of this tightly held community.

More About this Property

Property ID	BSXGF2S
Property Type	House
Land Area	836 m2
Including	Air Conditioning

Karen Renouf 0413 473 461

High Performance Agent - Team Renouf Properties Pty Ltd at LJH Property Centre
| krenouf@ljhpropertycentre.com.au

Tony Webber 0457 637 578

Team Renouf Properties Pty Ltd | twebber@ljhpropertycentre.com.au

LJ Hooker Property Centre (07) 3286 2500

152-164 Shore St West, Raby Bay, Brisbane Qld 4163
propertycentre.ljhooker.com.au | hello@ljhpc.com.au



LJ Hooker Property Centre
(07) 3286 2500

Disclaimer: All information contained therein is gathered from relevant third parties sources. We cannot guarantee or give any warranty about the information provided. Interested parties must rely solely on their own enquiries.



FLOOR PLAN

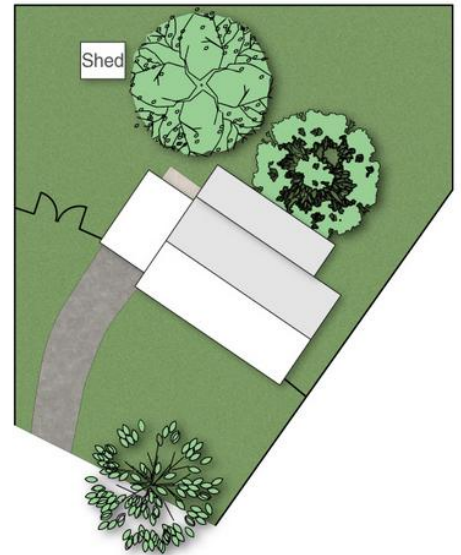

SITE PLAN

10 Carl Jung Court, Victoria Point

Total Approx Floor Area: 119m²

PLEASE NOTE THIS PLAN IS FOR MARKETING PURPOSES AND IS TO BE USED AS A GUIDE ONLY. ALL MARKINGS, MEASUREMENTS, AREAS, AND LAYOUT ARE INDICATIVE ONLY AND INTERESTED PARTIES SHOULD MAKE THEIR OWN ENQUIRIES BEFORE MAKING ANY DECISIONS. FLOOR COVERINGS INDICATED ARE FOR ILLUSTRATIVE PURPOSES ONLY AND MAY NOT ACCURATELY PORTRAY ACTUAL FLOOR COVERINGS OF THE PROPERTY. NO GUARANTEES ARE MADE REGARDING THE INFORMATION CONTAINED IN THIS PLAN AND NO LIABILITY FOR ANY INACCURACIES IS ACCEPTED.

Team Renouf **LJ Hooker**
Property Centre



LJ Hooker Property Centre
(07) 3286 2500

Disclaimer: All information contained therein is gathered from relevant third parties sources. We cannot guarantee or give any warranty about the information provided. Interested parties must rely solely on their own enquiries.