



Upper Coomera, 28 Rix Drive

Be Surprised At The Size

Set in a quiet location, strolling distance to parks and local amenities, this large 275sqm sqm family residence on 644sqm of land embraces a flowing selection of light filled Living spaces with sliding door access connecting the outdoors and huge covered entertaining area

With a private aspect and abundance of space for the largest of families you will feel right at home once you enter the foyer through the double doored entrance.

Occupying a quiet yet remarkably convenient location, only a few minutes walk to Upper Coomera's CBD and within a short walk to public transport.

Currently on a periodic lease. Rental appraisal \$790 - \$810 a week

The home features:

- * 275sq of Living areas
- * 4 large bedrooms

4 2 2

For Sale

Offers over \$899,000

View

ljhooker.com.au/42Y7GTJ

Contact

Robbie Dunn

0404 466 793

rdunn@ljhgc.com.au

LJ Hooker

Disclaimer: All information contained therein is gathered from relevant third parties sources.

We cannot guarantee or give any warranty about the information provided. Interested parties must rely solely on their own enquiries.

LJ Hooker Coomera
(07) 5585 7888

- * Master with large robe and spacious ensuite
- * Ducted Air conditioning installed a few years ago
- * Enormous Functional Kitchen/living
- * Quality appliances
- * Huge family room dividable into another bedroom if needed
- * Plenty of Storage
- * Security Screens & Doors
- * Spacious entry
- * Large covered entertaining area
- * 644m2 Block
- * Garden shed

Meters to public transport & walking distance to private and public schools, cafes, child care centres, shopping hubs and entertaining options and Westfield Coomera is 2 minutes away. Positioned 3 minutes to M1 exit (Exit 54), you are less than 40 mins to Brisbane City and less than 30 minutes to Surfers Paradise. Both Brisbane International Airport and Coolangatta International Airport under an hour away. Coomera train station is a 2minute drive away with the light rail opening rail travel up from the Sunshine Coast to Broadbeach

Important Note:
While every effort has been made to ensure accuracy, LJ Hooker Coomera will not be liable for any errors in typing or information. All details are deemed correct at the time of printing.

More About this Property

Property ID	42Y7GTJ
Property Type	House
House Size	275 m²
Land Area	644 m²
Including	Ensuite Air Conditioning Ducted Cooling Outdoor Entertaining Built-in-Robes Security screens

Robbie Dunn 0404 466 793
Sales Specialist | L.R.E.A | rdunn@ljhgc.com.au

LJ Hooker Coomera (07) 5585 7888
The Hub, 5/90 Days Road, UPPER COOMERA QLD 4209
coomera.ljhooker.com.au | coomera@ljhgc.com.au

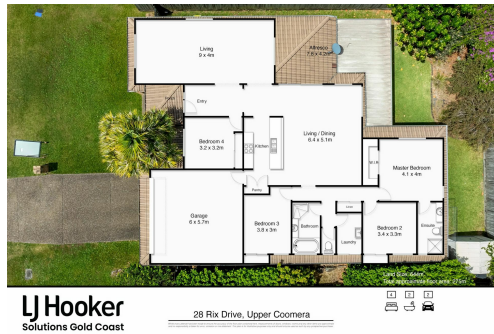

LJ Hooker

Disclaimer: All information contained therein is gathered from relevant third parties sources. We cannot guarantee or give any warranty about the information provided. Interested parties must rely solely on their own enquiries.

LJ Hooker Coomera
(07) 5585 7888



LJ Hooker
Solutions Gold Coast

28 Rix Drive, Upper Coomera

While every attempt has been made to ensure the accuracy of the floor plan contained here, measurements of doors, windows, rooms and any other items are approximate and no responsibility is taken for error, omission or misstatement. This plan is for illustrative purposes only and should only be relied on such for any prospective purchaser.

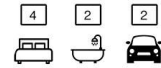

LJ Hooker

LJ Hooker Coomera
(07) 5585 7888

Disclaimer: All information contained therein is gathered from relevant third parties sources.
We cannot guarantee or give any warranty about the information provided. Interested parties must rely solely on their own enquiries.