

## Tweed Heads, 24/20 Binya Avenue

SOLD BY JO LYNCH & JO ELWIN

\*\*Open home on Sunday 9th March is cancelled due to severe weather. Sorry for any inconvenience.

Located in the highly sought-after Kirra Shores complex, live the Kirra Beach lifestyle within a secure gated community. Unit 24 is located in a quiet, family friendly cul-de-sac at the eastern end of the complex. You are a flat 700 metre stroll to the Kirra beachfront, with the Southern Gold Coast's trendiest bars, restaurants and cafes as your local options.

For surfers, your daily surf check is by bike. In fact, you will rarely reach for the car keys here! Kirra Shores offers resort-style amenities including 2 swimming pools, a tennis court and The Kirra Shop for the best pizza, pasta, burgers and more!

Set over two levels, this townhouse offers 2 spacious bedrooms upstairs, along with the bathroom and separate toilet.



**Disclaimer:** All information contained therein is gathered from relevant third parties sources. We cannot guarantee or give any warranty about the information provided. Interested parties must rely solely on their own enquiries.

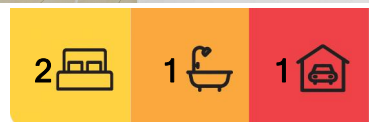

**For Sale**  
Contact Agent

**View**  
[ljhooker.com.au/KG3HEZ](http://ljhooker.com.au/KG3HEZ)

**Contact**  
**Jo Lynch**  
0424 420 884  
[jolynch@ljhookersgc.com.au](mailto:jolynch@ljhookersgc.com.au)

**Jo Elwin**  
0409 429 785  
[jo@ljhookerpb.com.au](mailto:jo@ljhookerpb.com.au)

**LJ Hooker Coolangatta | Tweed**  
**(07) 5536 5577**



The open plan kitchen and living / dining space is downstairs, opening to a covered courtyard that is lovely and sunny all day!

Appealing to many buyer groups including first home buyers, investors and downsizers, we encourage you to view this property at your earliest convenience.

Further details:

- 2 spacious bedrooms, with wardrobes and ceiling fans
  - 1 bathroom with bathtub, separate toilet
  - Single garage with integrated laundry
  - Living room with tiled flooring and ceiling fan
  - Kitchen with electric oven, stove top and plenty of cupboard space
  - Undercover outdoor courtyard at rear (fenced and perfect for pets)
  - Front courtyard between garage and front door.
- 
- Body corporate fees approx. \$86 per week (paid in quarterly instalments)
  - Council Rates - approx. \$2,382 per annum

To arrange your viewing, please contact The Jo & Jo Sales Team.

Jo Lynch - 0424 420 884

Jo Elwin - 0409 429 785

Disclaimer:

All information (including but not limited to the property area, floor size, price, address and general property description) is provided as a convenience to you, and has been provided to LJ Hooker by third parties. LJ Hooker is unable to definitively confirm whether the information listed is correct or 100% accurate. LJ Hooker does not accept any liability (direct or indirect) for any injury, loss, claim, damage or any incidental or consequential damages, including but not limited to lost profits or savings, arising out of or in any way connected with the use of any information, or any error, omission or defect in the information, contained on the Website. Information contained on the Website should not be relied upon and you should make your own enquiries and seek legal advice in respect of any property on the Website. Prices displayed on the Website are current at the time of issue, but may change.

## More About this Property

|               |        |
|---------------|--------|
| Property ID   | KG3HEZ |
| Property Type | Unit   |

**Jo Lynch 0424 420 884**

Sales & Marketing Specialist | [jolynch@ljhookersgc.com.au](mailto:jolynch@ljhookersgc.com.au)

**Jo Elwin 0409 429 785**

Sales & Marketing Specialist | [jo@ljhookerpb.com.au](mailto:jo@ljhookerpb.com.au)

**LJ Hooker Coolangatta | Tweed (07) 5536 5577**

5/100 Griffith Street, COOLANGATTA QLD 4225

[coolangattatweed.ljhooker.com.au](http://coolangattatweed.ljhooker.com.au) | [enquiries@ljhookerct.com.au](mailto:enquiries@ljhookerct.com.au)



**Disclaimer:** All information contained therein is gathered from relevant third parties sources.

We cannot guarantee or give any warranty about the information provided. Interested parties must rely solely on their own enquiries.



**LJ Hooker Coolangatta | Tweed  
(07) 5536 5577**

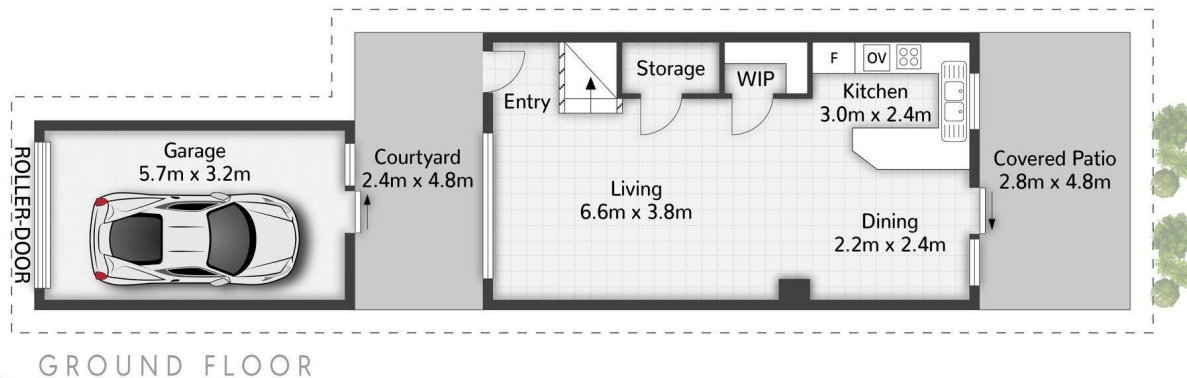
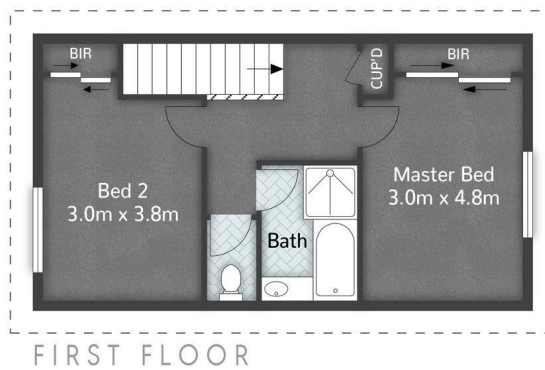

Unit 24/20 Binya Avenue/ **TWEED HEADS**

2 | 1 | 1 | 146m<sup>2</sup>

**LJ Hooker**  
Southern Gold Coast

All dimensions are approximate; they are subject to errors and inaccuracies and no liability will be accepted.  
Plans are shown for marketing purposes only.

**LJ Hooker**



**LJ Hooker Coolangatta | Tweed**  
**(07) 5536 5577**

**Disclaimer:** All information contained therein is gathered from relevant third parties sources.  
We cannot guarantee or give any warranty about the information provided. Interested parties must rely solely on their own enquiries.