



**Sold**



1004/2-4 Stuart Street, Tweed Heads

## Sold By Gary Evenden

250m to Greenmount Beach

Positioned high in the exclusive Ocean Tower, this stunning 2-bedroom, 2-bathroom apartment offers breathtaking elevated ocean and skyline views. You're so close to the beach, you can watch the footprints form in the sand... imagine the lifestyle you'll create just 250m from the shore. Designed for coastal living, the bright open-plan interiors flow seamlessly onto a north-facing balcony - perfect for soaking in sunrises or entertaining with friends against a spectacular backdrop.

This tower is one of Tweed Heads' most desirable buildings, renowned for its secure, well-maintained environment and prime location. The apartment offers resort facilities and easy access to the vibrant local precinct and popular beachside spots; making it perfect for those seeking a balanced lifestyle.

### Features:

- Ducted air conditioning throughout offering your desired climate control
- Ceiling fans fitted in living and bedrooms for enhanced airflow
- New carpet and paint for a clean, modern finish
- Updated bathroom and kitchen with quality finishes, including

All information contained therein is gathered from relevant third parties sources. We cannot guarantee or give any warranty about the information provided. Interested parties must rely solely on their own enquiries.

2 2 1

### FOR SALE

Sold By Gary Evenden

### AGENTS

Gary Evenden  
0411 966 001  
gary@ljhookerct.com.au

### AGENCY

LJ Hooker Coolangatta | Tweed  
(07) 5536 5577



- granite stone benchtop
- Integrated open-plan layout maximises space and natural light
- Retreat-style master bedroom with walk-in wardrobe and private ensuite
- Second bedroom includes built-in wardrobe for added storage
- Abundant storage space to keep the home clutter-free
- Wraparound balcony with stunning views, accessible from bedrooms and living area
- Secure undercover parking with lift access to your floor

Twin Towns has an array of resort facilities:

- Heated indoor pool and resort style outdoor swimming pool
- Steam room for improving your health
- Fitness club for your convenience
- Extras like Mini golf course, games room and 2 tennis courts
- Separate covered BBQ area
- Reception and concierge
- Onsite restaurant and bars
- 250 metre walk to Greenmount/Coolangatta beach
- Free undercover car parking
- Bus stop directly in front of Twin Towns, making travel effortless

Disclaimer:

All information (including but not limited to the property area, floor size, price, address and general property description) is provided as a convenience to you, and has been provided to LJ Hooker by third parties. LJ Hooker is unable to definitively confirm whether the information listed is correct or 100% accurate. LJ Hooker does not accept any liability (direct or indirect) for any injury, loss, claim, damage or any incidental or consequential damages, including but not limited to lost profits or savings, arising out of or in any way connected with the use of any information, or any error, omission or defect in the information, contained on the Website. Information contained on the Website should not be relied upon and you should make your own enquiries and seek legal advice in respect of any property on the Website. Prices displayed on the Website are current at the time of issue, but may change.

## MORE DETAILS

Property ID	KR3HEZ
Property Type	Unit
Including	Air Conditioning
	Pool
	Tennis Court
	Balcony
	Gym
	Built-in-Robes
	Secure Parking

**Gary Evenden 0411 966 001**

Sales Specialist – Independent Contractor |  
gary@ljhookerct.com.au

**LJ Hooker Coolangatta | Tweed (07) 5536 5577**

5/100 Griffith Street, COOLANGATTA QLD 4225  
coolangattatweed.ljhooker.com.au | enquiries@ljhookerct.com.au





**1004/2-4  
STUART STREET**  
Tweed Heads

Internal Area	80m <sup>2</sup>
External Area	28m <sup>2</sup>
Total Area	108m <sup>2</sup>
Car Space	16m <sup>2</sup>

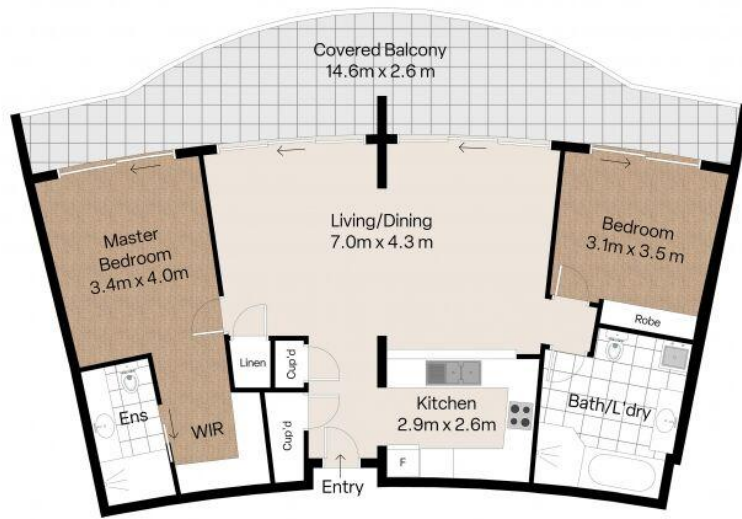

Car Space  
2.9m x 5.5 m



Secure Basement  
Parking

	2
	2
	1



Whilst every effort has been undertaken for 100% accuracy, plans should not be relied on solely. All images/finishes are for illustrative purposes only and are not intended to depict the general layout only. No plans/site plans represented are to scale. Areas have been rounded off where appropriate. Area calculations are based on third party calculations.