



**Sold**



22 Evelyn Crescent, Thornton

## Buy Now, Benefit Later —Prime Position in Thornton!

This 3 bedroom brick home is bursting with potential! ideal for first-home buyers ready to enter the market or investors looking for a property with plenty of upside.

Well located just minutes from Maitland Hospital, Stockland Green Hills, and a range of schools and local amenities, the home offers easy access to everything you need, making it a smart choice for long-term growth. The home itself is comfortable and immediately liveable yet offers endless scope to update and personalise. Imagine what a coat of paint, modern flooring, and refreshed kitchen and bathroom could do to completely transform the space. Whether you're planning to create your dream home or boost rental income, this is a golden opportunity.

With a strong rental market in the area, this property offers an estimated rental return of approximately \$500 per week, making it an attractive option for investors seeking reliable income and solid long term growth potential.

Affordable, well positioned, and packed with possibilities, this is one you don't want to miss!

3 1 1

**FOR SALE**  
\$675,000

### AGENTS

Todd Fisher  
0438 592 920  
tfisher.maitland@ljhooker.com.au

Jack Fisher  
jfisher.maitland@ljhooker.com.au

### AGENCY

LJ Hooker Maitland  
(02) 4933 5511

All information contained therein is gathered from relevant third parties sources.  
We cannot guarantee or give any warranty about the information provided.  
Interested parties must rely solely on their own enquiries.



Proudly marketed by LJ Hooker Maitland, please call exclusive agents Jack Fisher 0438 165 825 or Todd Fisher 0438 592 920 - 7 days for all inspections & further information.

- Front and side photo have had grass enhancement.

All information contained herein is gathered from sources we deem to be reliable. However, we cannot guarantee its accuracy and interested persons should rely on their own enquiries.

## MORE DETAILS

Property ID	1EDZF6H
Property Type	House
Land Area	595 m2
Including	Toilets (1)

### Todd Fisher 0438 592 920

Principal/Licensee in Charge | [tfisher.maitland@ljhooker.com.au](mailto:tfisher.maitland@ljhooker.com.au)

### Jack Fisher

Sales Associate | [jfisher.maitland@ljhooker.com.au](mailto:jfisher.maitland@ljhooker.com.au)

### LJ Hooker Maitland (02) 4933 5511

24 Ken Tubman Drive, MAITLAND NSW 2320  
[maitland.ljhooker.com.au](mailto:maitland.ljhooker.com.au) | [maitland@ljhooker.com.au](mailto:maitland@ljhooker.com.au)



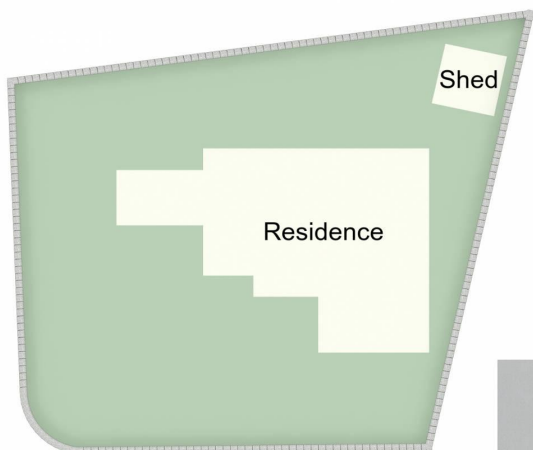

Site Plan  
(Not to Scale)

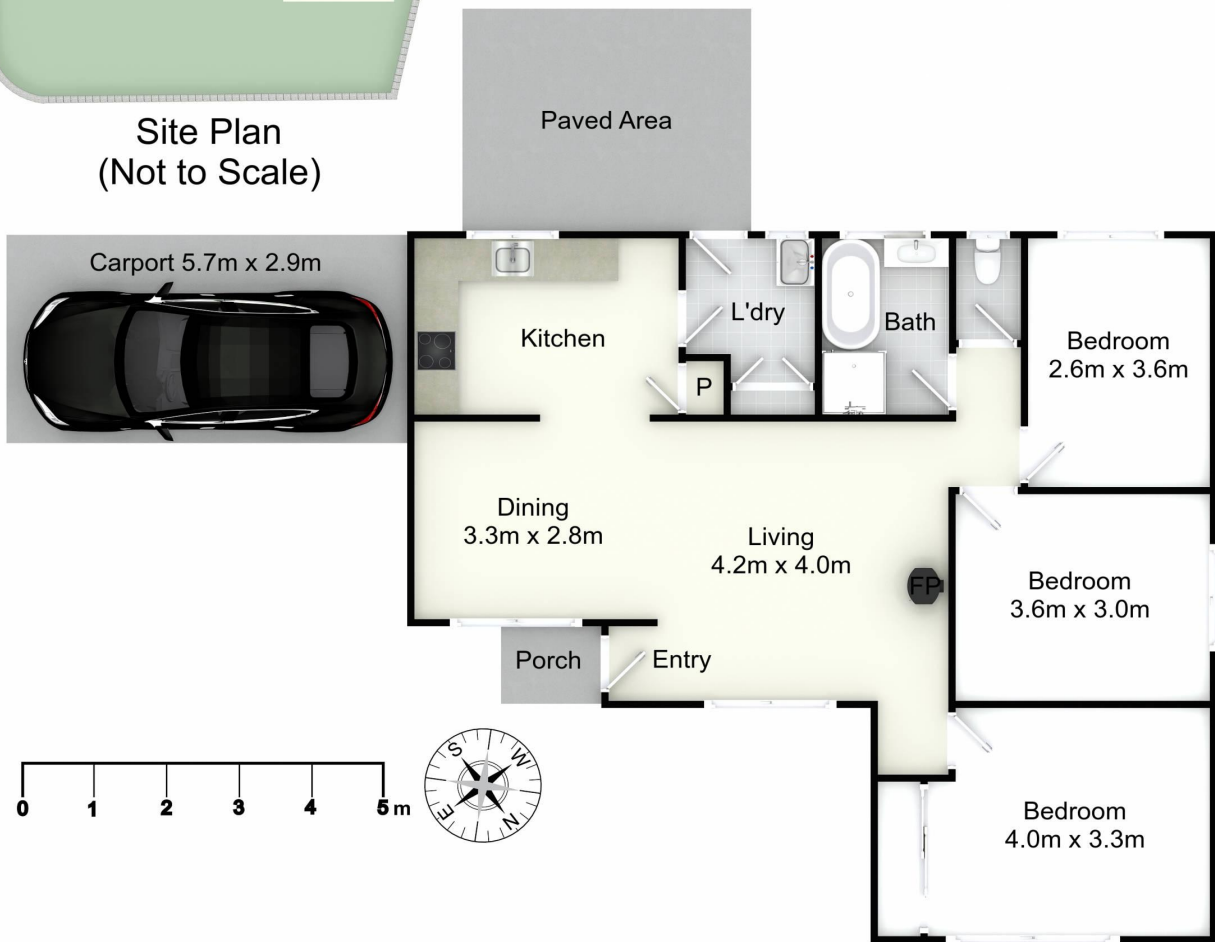

22 Evelyn Cr, Thornton

All information contained herein is gathered from sources we deem reliable. However, we cannot guarantee its accuracy and act as a messenger only in passing on the details. Interested parties should rely on their own inquiries and the contract for sale. The floor plans are artist's impressions only. The site plan is not to scale.

**LJ Hooker**  
Maitland

All information contained therein is gathered from relevant third parties sources. We cannot guarantee or give any warranty about the information provided. Interested parties must rely solely on their own enquiries.

**LJ Hooker**