

450 Montpelier Drive, The Oaks

**Price Reduced | Motivated Vendor | 64.64-Acres\* | Renovated Home | Shedding | Dual Occupancy Potential^**

Offered to the market by a vendor with clear intentions to sell and set on a 64.64-acre\* (26.16 ha\*) parcel, this property offers great future potential for rural living, business use or building a second home^.

Zoned RU2 and featuring a 4-bedroom home plus shedding, ideally located in the thriving township of The Oaks and boasting dual street frontage with a partly cleared section that presents an exceptional opportunity to design and build a second residence capturing stunning city skyline views.

The renovated brick-veneer home provides comfortable living and features a kitchen with adjacent meals area, equipped with a dishwasher and electric cooktop. A combined bathroom and laundry adds everyday convenience, while the flexible fourth bedroom can also serve as a study. The spacious main bedroom and cosy living room-complete with split-system air conditioning and a fireplace-ensure year-round comfort.

Outdoor infrastructure is a major highlight, with a large concreted shed perfect for storage/workshop setup plus an open machinery

4 🏠 1 🚗 10 🚗

**FOR SALE**

Offers Above \$1,895,000

**VIEW**

Sat 11th Apr @ 10:30AM - 11:00AM

**AGENTS**

Nicholas Pikis  
0437 248 641  
nicholas@ljhunitedgroup.com.au

Edwin Borg  
0418 236 274  
ed@ljhunitedgroup.com.au

**AGENCY**

LJ Hooker United Group  
1800 486 4833

All information contained therein is gathered from relevant third parties sources. We cannot guarantee or give any warranty about the information provided. Interested parties must rely solely on their own enquiries.



shed, two dams and dual road frontages. Additionally, there is an outdoor powder room with laundry or storage potential located beneath the home.

Whether you're seeking an ideal dual-occupancy opportunity, land suited for potential bio banking, or acreage with land-fill prospects, this property offers unmatched versatility in a peaceful rural setting.

- Approx.

^ Subject to Council Approval.

Webpage enquiries must include a contact number and email address to receive a response. Photo ID is required for all inspections. While care has been taken in presenting this information, prospective purchasers should confirm details independently.

## MORE DETAILS

Property ID	G2J1T
Property Type	AcreageSemi-rural
Land Area	26.16 hectare

**Nicholas Pikis 0437 248 641**

Sales Assistant | [nicholas@ljhunitedgroup.com.au](mailto:nicholas@ljhunitedgroup.com.au)

**Edwin Borg 0418 236 274**

Sales Executive | [ed@ljhunitedgroup.com.au](mailto:ed@ljhunitedgroup.com.au)

**LJ Hooker United Group 1800 486 4833**

41 Wentworth Road, BRINGELLY NSW 2556

[unitedgroup.ljhooker.com.au](http://unitedgroup.ljhooker.com.au) | [reception@ljhunitedgroup.com.au](mailto:reception@ljhunitedgroup.com.au)



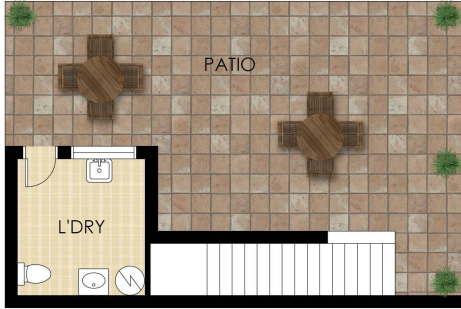

LOWER LEVEL



GROUND LEVEL

## 450 Montpelier Drive, The Oaks



Floor plans and site plans are for illustrative purposes only. They are not part of any legal document or title and are subject to errors, omission, and inaccuracies. Whilst every attempt has been made to ensure the accuracy of this plan, measurements of doors, windows, rooms, cupboards etc are approximate only.