



## Terrigal, 116 Hastings Road

### Endless Potential in a Prestige Terrigal Setting

Sold Pre-Market by Tim Andrews & Dougal Miller-Sneddon through the strength of LJ Hooker Terrigal's database.



**For Sale**  
Contact Agent

**View**  
[ljhooke.com.au/1H44GC1](https://ljhooke.com.au/1H44GC1)

**Contact**  
**Tim Andrews**  
0412 663 065  
tim.andrews@ljhooke.com.au  
**Dougal Miller-Sneddon**  
0423 138 180  
dougal.millersneddon@ljhooke.com.au



**Disclaimer:** All information contained therein is gathered from relevant third parties sources. We cannot guarantee or give any warranty about the information provided. Interested parties must rely solely on their own enquiries.

**LJ Hooker Terrigal**  
**(02) 4385 8444**

## More About this Property

<b>Property ID</b>	1H44GC1
<b>Property Type</b>	House
<b>Land Area</b>	714 m2

### **Tim Andrews 0412 663 065**

Principal / Licensee - LREA | [tim.andrews@ljhooker.com.au](mailto:tim.andrews@ljhooker.com.au)

### **Dougal Miller-Sneddon 0423 138 180**

Sales Specialist - LREA | [dougal.millersneddon@ljhooker.com.au](mailto:dougal.millersneddon@ljhooker.com.au)

### **LJ Hooker Terrigal (02) 4385 8444**

Shop 1 & 2, 1 Campbell Crescent, TERRIGAL NSW 2260

[terrigan.ljhooker.com.au](http://terrigan.ljhooker.com.au) | [terrigan@ljhooker.com.au](mailto:terrigan@ljhooker.com.au)



**LJ Hooker Terrigal**  
**(02) 4385 8444**

**Disclaimer:** All information contained therein is gathered from relevant third parties sources.

We cannot guarantee or give any warranty about the information provided. Interested parties must rely solely on their own enquiries.

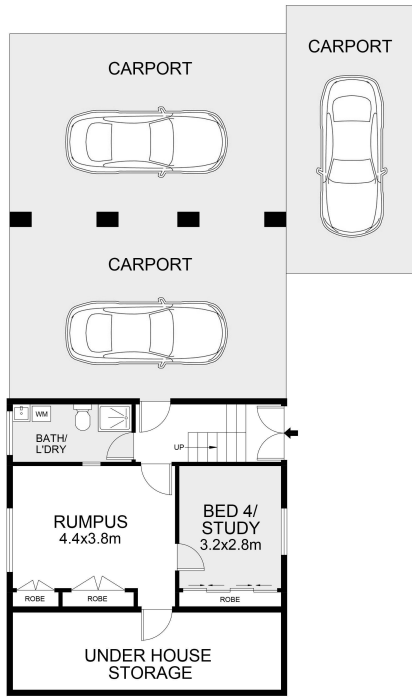

GROUND FLOOR



FIRST FLOOR

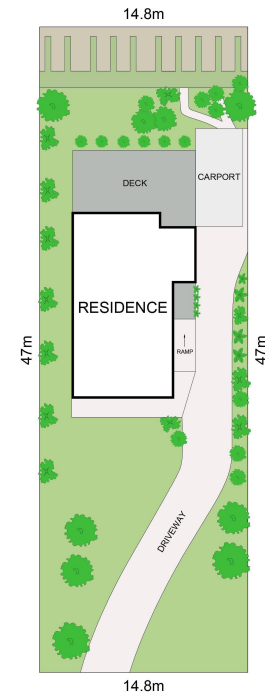

SITE PLAN

## 116 Hastings Road, Terrigal

Scale in metres. Indicative only. Measurements and dimensions are approximate.  
All information contained herein is gathered from sources we believe to be reliable.  
However we cannot guarantee its accuracy and interested persons should rely on their own enquiries.



INT : 153m<sup>2</sup>  
EXT : 148m<sup>2</sup>

