



24 Marcus Road, Templestowe Lower

Renovate, Extend or Rebuild on 715sqm (STCA) —Prime Investment Opportunity

Positioned in a high-demand pocket of Templestowe Lower, this well-maintained home on 715sqm (approx.) presents an outstanding investment opportunity with strong long-term upside.

The existing dwelling offers three bedrooms, central bathroom, separate living and dining areas, and a functional kitchen-providing immediate rental or occupancy potential.

The generous land size offers future scope to renovate, extend or redevelop (STCA), allowing investors to capitalise on capital growth in a tightly held suburb.

Conveniently located close to Westfield Doncaster, quality schools, parks, transport and major arterials, this is a strategic landholding combining immediate income potential with future development flexibility.

3  1  2 

FOR SALE

\$1,300,000 - \$1,400,000

VIEW

Sat 13th Jun @ 10:00AM - 10:30AM

AGENTS

Yuanyuan Chen

0415 831 789

yuanyuan.cityresmelbourne@ljhooker.com.au

AGENCY

LJ Hooker City Residential

(03) 9600 2166

All information contained therein is gathered from relevant third parties sources. We cannot guarantee or give any warranty about the information provided. Interested parties must rely solely on their own enquiries.

 **LJ Hooker**

MORE DETAILS

Property ID PJ2HC2
Property Type House
Including Air Conditioning
Close to Schools
Close to Shops

Yuanyuan Chen 0415 831 789

Senior Sales Consultant |
yuanyuan.cityresmelbourne@ljhooker.com.au

LJ Hooker City Residential (03) 9600 2166

Upper Ground Floor, 439-445 Lonsdale St, MELBOURNE VIC 3000
cityresmelbourne.ljhooker.com.au |
cityresmelbourne@ljhooker.com.au



All information contained therein is gathered from relevant third parties sources.
We cannot guarantee or give any warranty about the information provided.
Interested parties must rely solely on their own enquiries.

24 MARCUS RD, LOWER TEMPLESTOWE 3107

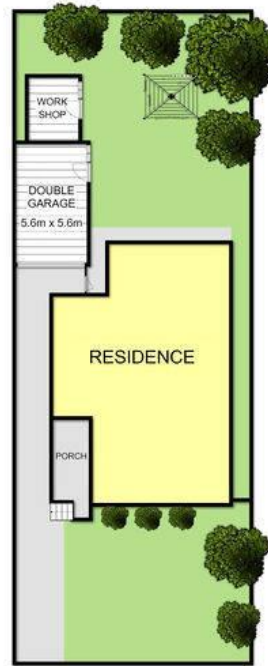
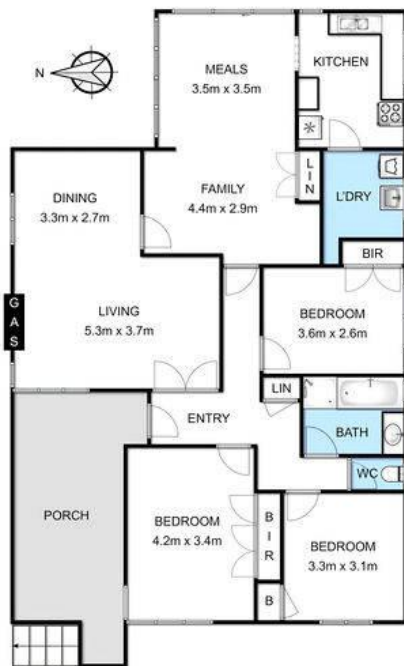

DISCLAIMER

Whilst every attempt has been made to ensure the accuracy of the floor plan contained here, measurements of doors, windows, rooms and other items here are approximate and no responsibility is taken for any error, omission or misstatement. This is for illustrative purpose only and should be used as such by any prospective purchaser.



All information contained therein is gathered from relevant third parties sources. We cannot guarantee or give any warranty about the information provided. Interested parties must rely solely on their own enquiries.

