

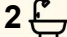
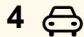

18 Paradise Drive, Tamboorine Mountain

3  2  4 

## CREATE YOUR DREAM HOME WITH SWEEPING GOLD COAST VIEWS

Set in a peaceful Tamboorine Mountain community, this expansive property offers sweeping Gold Coast views and an unrivalled sense of space and privacy! A rare opportunity to renovate or design your own home, it provides the perfect canvas to create a lifestyle of effortless living, taking full advantage of a location that combines serenity, panoramic vistas, and easy access to local amenities, schools, and the region's scenic attractions.

This existing two-level family home features multiple living, dining, and lounging areas across both levels, complemented by three bedrooms, two bathrooms, and covered provision for up to five vehicles. Expansive glazing to capture the sweeping horizon views, showcasing the potential to create something extraordinary with a thoughtful renovation or a complete rebuild.

Further enhancing the appeal is the huge 1,002m<sup>2</sup> block, with a corner position providing easy access for trades and vehicles, while the expansive yard offers plenty of space for children, pets, or accommodating any dream design!

**FOR SALE**  
SOLD BY RACHEL RYAN

### AGENTS

Rachel Ryan  
0433 774 501  
rryan@ljhgc.com.au

### AGENCY

LJ Hooker Tamboorine Mountain  
(07) 5545 1500

All information contained therein is gathered from relevant third parties sources.  
We cannot guarantee or give any warranty about the information provided.  
Interested parties must rely solely on their own enquiries.

 **LJ Hooker**

Known for its serenity and strong sense of community, this coveted location is close to scenic walking trails, charming dining and markets, as well as provides easy access to schools, shops, and everyday essentials. Positioned to take advantage of it all, this is an exceptional opportunity to create your own dream home, with dazzling horizon views forming the perfect backdrop to relaxed living or entertaining as you choose!

- " Expansive 1,002m<sup>2</sup> corner block with sweeping Gold Coast views
- Knockdown, renovate or rebuild opportunity
- Existing two-level family home with multiple living, dining and lounge areas
- Three bedrooms, two bathrooms
- Covered parking for up to five vehicles
- Expansive glazing to capture horizon views
- Corner position with easy access for trades and vehicles
- Large yard for children, pets or footprint expansion
- Peaceful Tamborine community with strong sense of community
- Close to scenic walking trails, dining and markets
- Easy access to schools, shops and everyday essentials
- Exceptional opportunity to create your dream home with panoramic backdrop!

## MORE DETAILS

Property ID	QDHFZ
Property Type	House
Land Area	1002 m2

### Rachel Ryan 0433 774 501

Sales Specialist | L.R.E.A | Independent Contractor |  
rryan@ljhgc.com.au

### LJ Hooker Tamborine Mountain (07) 5545 1500

Shop 1D/17-27 Main Western Road, TAMBORINE MOUNTAIN QLD  
4272

tamborinemountain.ljhooker.com.au |  
tamborinemountain@ljhgc.com.au



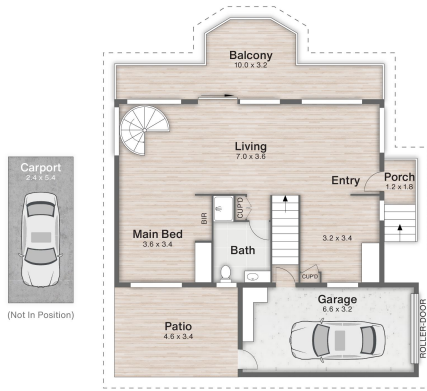

FIRST FLOOR

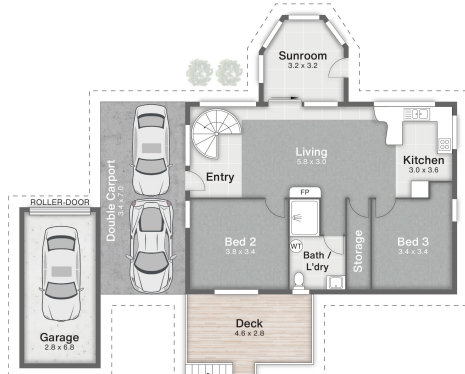

GROUND FLOOR

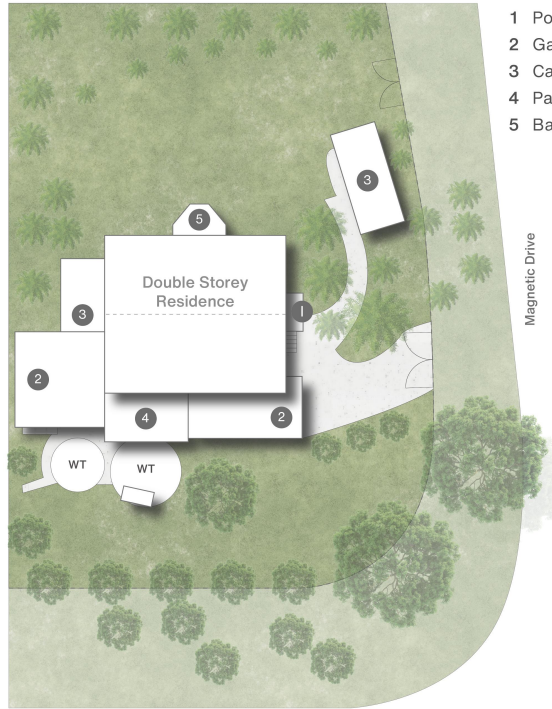

- 1 Porch
- 2 Garage
- 3 Carport
- 4 Patio
- 5 Balcony



18 Paradise Drive TAMBORINE MOUNTAIN

3 | 2 | 5 | 287m<sup>2</sup>

**LJ Hooker**

Coomera Ormeau Tamborine Mountain

All dimensions are approximate; they are subject to errors and inaccuracies and no liability will be accepted. Plans are shown for marketing purposes only.

All information contained therein is gathered from relevant third parties sources. We cannot guarantee or give any warranty about the information provided. Interested parties must rely solely on their own enquiries.

**LJ Hooker**