



158 Murlong Street, Swan Hill

Great Family Home or Investment Opportunity

Nicely set on a 675 square metre site in a well-established neighbourhood close to schools, childcare and public open space this home awaits those looking for a solid, well-appointed brick veneer with room for uplift in both liveability and value.

A very liveable 1980's brick veneer, this well cared-for family residence is in good heart but there is a live opportunity to put your own personality into the home in a cosmetic makeover program to lift the décor to reflect your personality.

There is a very spacious living room off the entrance hall and this connects through to the very roomy kitchen/meals/family room across the rear of the home. This open plan area promotes family connectedness and seamless movement through the central living space with all the room to accommodate the active family unit overlooking the rear garden.

The three bedrooms are light-filled and provide private spaces for adults and kids alike – freedom for everyone.

Conversely, the canny investor will recognise and appreciate the low maintenance aspects of this property and therefore its potential to deliver a great return on investment – the key metric for property investors.

3 1 3

FOR SALE
\$465,000

AGENTS

John Monahan
0427 292 965
jmonahan.admiral@ljhooker.com.au

AGENCY

LJ Hooker Swan Hill
(03) 5033 1331

All information contained therein is gathered from relevant third parties sources.
We cannot guarantee or give any warranty about the information provided.
Interested parties must rely solely on their own enquiries.

LJ Hooker

MORE DETAILS

Property ID JJAFCF
Property Type House
Land Area 675 m2
Including Evaporative Cooling
 Dishwasher
 Outdoor Entertaining
 Workshop
 Built-in-Robes

John Monahan 0427 292 965
Licensee | jmonahan.admiral@ljhooker.com.au

LJ Hooker Swan Hill (03) 5033 1331
310 Campbell Street, SWAN HILL VIC 3585
swanhill.ljhooker.com.au | swanhill@ljhooker.com.au



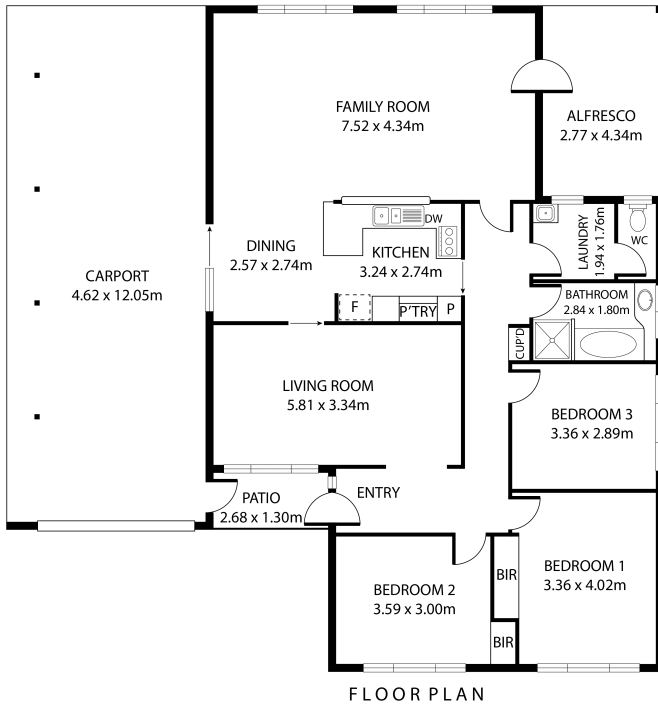

FLOOR PLAN

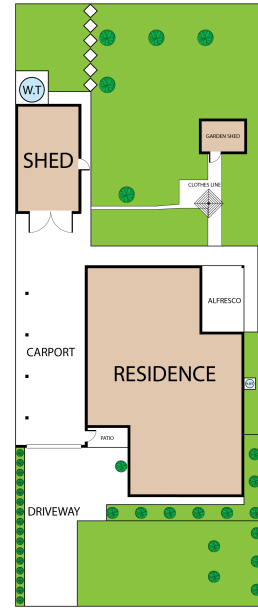
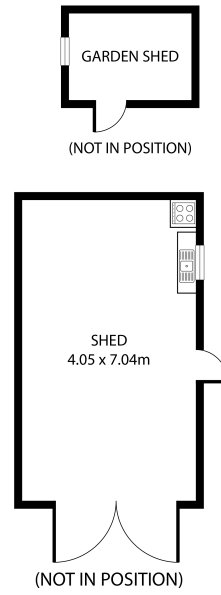

SITE PLAN

TOTAL LIVING AREA:	(131m ²)
PATIO:	3m ²
CARPORT:	56m ²
ALFRESCO:	12m ²
SHED:	28m ²
TOTAL SIZE:	230m ²

Whilst every attempt has been made to ensure the accuracy of the floor plan contained here, measurements of doors, windows, rooms and any other items are approximate and no responsibility is taken for any error, omission, or misstatement. This plan is for illustrative purposes only and should be used as such by any prospective purchaser.

158 Murlong Street, Swan Hill