

4/430 Liverpool Road, Strathfield South

## Sold by Joe Murania

Immaculately Presented and Affordable 3 Bedroom Garden Apartment.

Quietly positioned at the rear of a small full-brick complex of only nine, this beautifully presented garden apartment features 3 generous bedrooms, main with en-suite and all with built-in wardrobes, a modern open-plan kitchen, large main bathroom, and a spacious combined lounge and dining room, which leads out to an undercover outdoor area and a wraparound courtyard.

Secure parking is also available in the basement for 2 cars.

Conveniently located near schools, shops, and transport, this is the affordable three-bedroom home you've been looking for.

3 🚗 2 🚗 2 🚗

**FOR SALE**  
**SOLD**

### AGENTS

Joe Murania  
0416 044 267  
joe@ljhburwood.com.au

### AGENCY

LJ Hooker Burwood  
(02) 9745 3999

All information contained therein is gathered from relevant third parties sources.  
We cannot guarantee or give any warranty about the information provided.  
Interested parties must rely solely on their own enquiries.

 **LJ Hooker**

## MORE DETAILS

Property ID 11R4F8R  
Property Type Unit

**Joe Murania 0416 044 267**

Director | Sales Manager | [joe@ljhburwood.com.au](mailto:joe@ljhburwood.com.au)

**LJ Hooker Burwood (02) 9745 3999**

Shop 2/27-29 Burwood Road, BURWOOD NSW 2134  
[burwood.ljhooker.com.au](http://burwood.ljhooker.com.au) | [burwood@ljhburwood.com.au](mailto:burwood@ljhburwood.com.au)

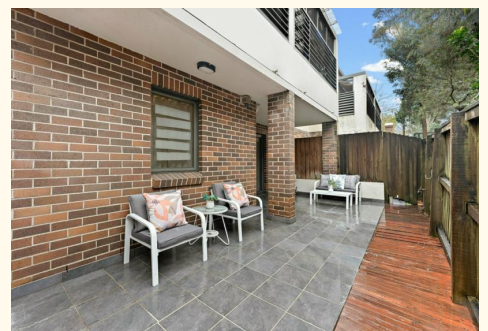

All information contained therein is gathered from relevant third parties sources.  
We cannot guarantee or give any warranty about the information provided.  
Interested parties must rely solely on their own enquiries.

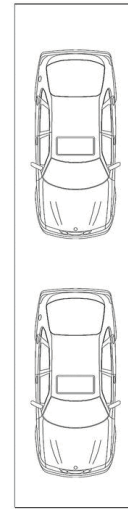
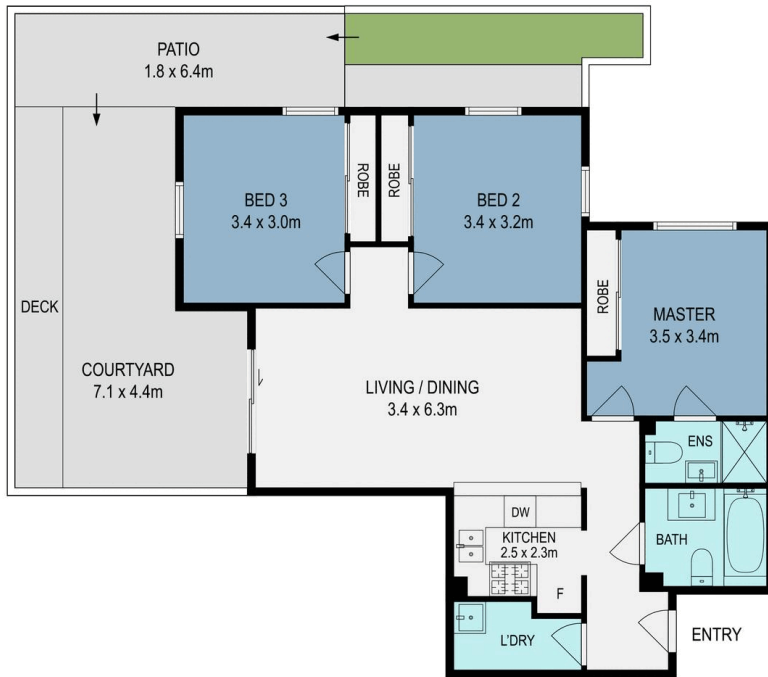

BASEMENT  
DOUBLE CAR SPACE  
(NOT TO SCALE)



4/430 Liverpool Road, Strathfield South

DISCLAIMER: THIS FLOOR PLAN IS INTENDED AS A GUIDE ONLY. IT DOES NOT CONSTITUTE PART OF ANY LEGAL DOCUMENTS. ALL DIMENSIONS ARE APPROXIMATE, ACTUAL MAY VARY. NO LIABILITY ACCEPTED. YOU MUST SEEK ADVICE FROM YOUR SOLICITOR. FLOOR PLAN BY WWW.MCPixelsAU.COM