

Stonyfell, 4A Fernbank Terrace

Sold by Marie Brus



Modern low maintenance single storey residence on 624m2 (approx) allotment.

Tastefully appointed with a French provincial influence and north facing picture windows this elegant home is flooded with natural light and boasts stunning polished timber floors

Offering 4 bedrooms, 2 with built-in robes and master with walk-in robes and ensuite. The formal lounge and dining room lead through to the quality kitchen and adjacent family/meals area.

Entertain outdoors in the large undercover paved alfresco or enjoy a quiet moment in the private courtyard.

This complete package is in the tightly held eastern suburb close to all amenities yet privately located in a leafy tranquil setting. Walking distance to St Peter's Girls School.



Disclaimer: All information contained therein is gathered from relevant third parties sources. We cannot guarantee or give any warranty about the information provided. Interested parties must rely solely on their own enquiries.

For Sale
Contact Agent

View
ljhooker.com.au/2CB5FDZ

Contact
Marie Brus
0418 844 502
marie.brus@ljhadelaidemetro.com.au
Mark Brus
0408 389 544
mark.brus@ljhadelaidemetro.com.au

LJ Hooker St Peters
(08) 8362 8008

Purchasing this property as an investment? Talk with Kirsty Clark from our PM team and see why our Property Management department is #1 amongst all the LJ Hooker offices Worldwide.

** All information provided has been obtained from sources we believe to be accurate, however, we cannot guarantee the information is accurate and we accept no liability for any errors or omissions (including but not limited to a property's land size, floor plans and size, building age and condition). Interested parties should make their own enquiries and obtain their own legal advice.

Should this property be scheduled for auction, the Vendor's Statement (Form 1) will be available at the LJ Hooker St Peters office for 3 consecutive business days immediately preceding the auction and at the auction for 30 minutes before it starts.

RLA 61345 RLA 282965 RLA 231015

More About this Property

Property ID	2CB5FDZ
Property Type	House
Land Area	642 m2
Including	Ensuite

Marie Brus 0418 844 502

Sales Consultant | marie.brus@ljhadelaidemetro.com.au

Mark Brus 0408 389 544

Sales Consultant | mark.brus@ljhadelaidemetro.com.au

LJ Hooker St Peters (08) 8362 8008

2a Portrush Road, PAYNEHAM SA 5070

stpeters.ljhooker.com.au | stpeters@ljhadelaidemetro.com.au

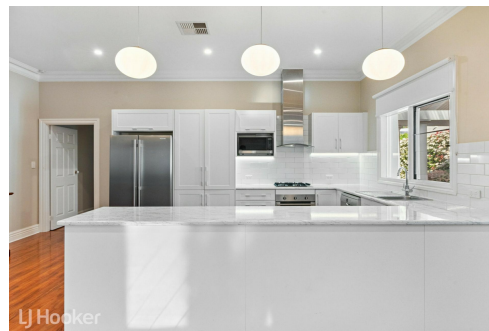

LJ Hooker St Peters
(08) 8362 8008

Disclaimer: All information contained therein is gathered from relevant third parties sources. We cannot guarantee or give any warranty about the information provided. Interested parties must rely solely on their own enquiries.

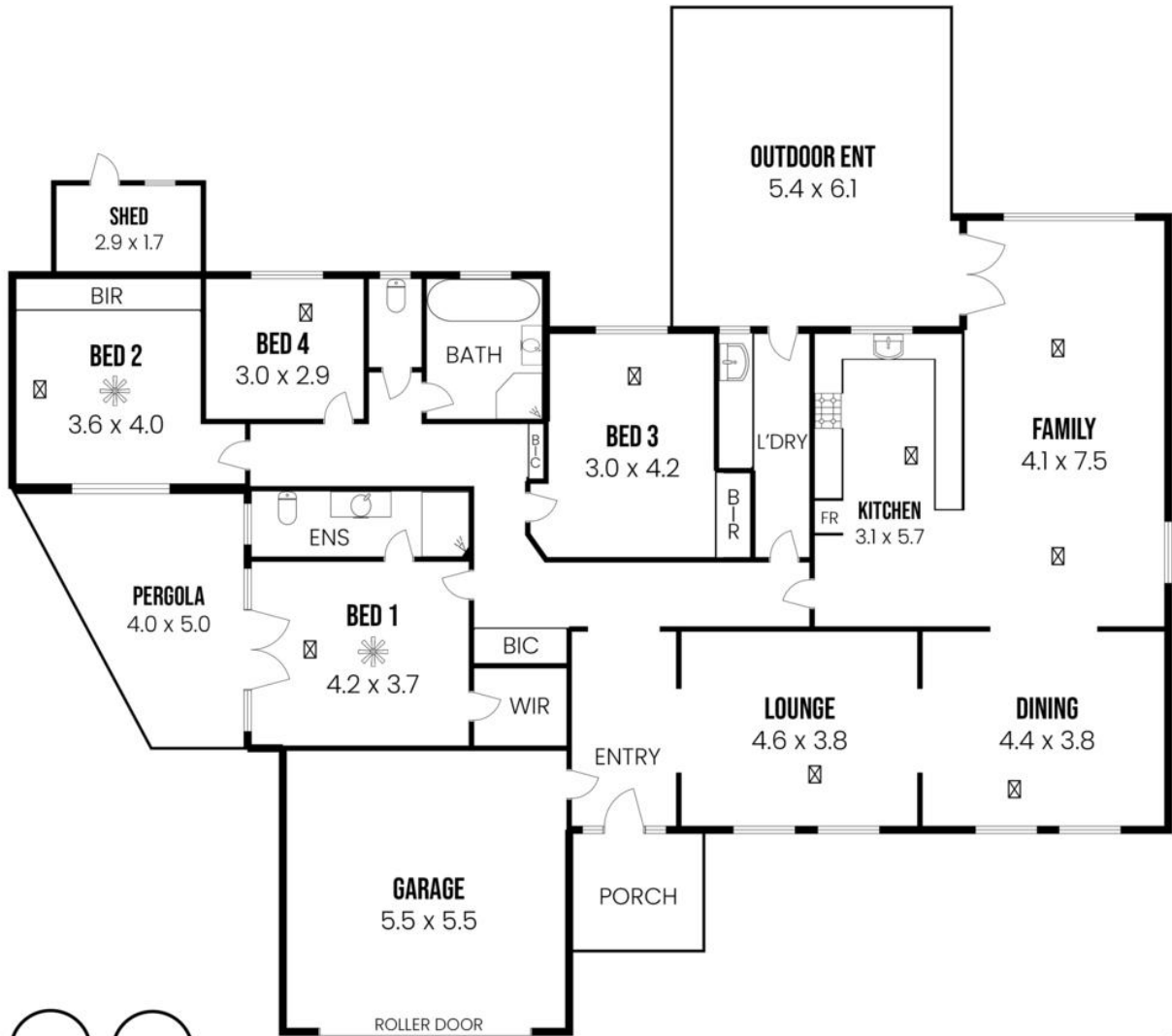

4a Fernbank Terrace, Stonyfell, SA 5066

Disclaimer: The information & figures obtained within this document has been compiled from information provided by vendor & sources that we believe are reliable. No warranty is given to their accuracy & all figures are subject to change without notice.



LJ Hooker St Peters
(08) 8362 8008

Disclaimer: All information contained therein is gathered from relevant third parties sources. We cannot guarantee or give any warranty about the information provided. Interested parties must rely solely on their own enquiries.