



**Sold**



55 - 155 Burke Road, Stanmore

**SOLD**

Welcome to 55 - 155 Burke Road.

Nestled in the tranquil hinterland of Stanmore, this picturesque 33.24-hectare property offers the ultimate rural lifestyle with stunning mountain views, abundant natural beauty, and the added bonus of an established lemon myrtle plantation. The charming four-bedroom, two-bathroom residence has been tastefully updated throughout and is positioned to take full advantage of its panoramic surrounds, offering both comfort and opportunity in a private, elevated setting.

Whether you're looking for a peaceful retreat or a productive acreage to live and work from, this property delivers. With multiple dams, a pump-fed irrigation system for the gardens, and recently upgraded water infrastructure, it's ideal for those seeking a self-sufficient lifestyle. Just 8 minutes to Woodford and 30 minutes to the Glass House Mountains, this is a rare chance to secure expansive, improved acreage with versatile infrastructure and an enviable outlook.

Key Features:

- 33.24 hectares of improved land with mountain views
- Four bedrooms, two bathrooms, and two spacious living areas

4 🏠 2 🚿 3 🚗

**FOR SALE**  
Expressions Of Interest

**AGENTS**  
Jack Cornford  
0484 241 803  
jack.cornford@ljhooker.com.au

**AGENCY**  
LJ Hooker Beerwah  
(07) 5318 7277

All information contained therein is gathered from relevant third parties sources. We cannot guarantee or give any warranty about the information provided. Interested parties must rely solely on their own enquiries.



Renovated in 2022: new paint, carpets, curtains, windows, and fly screens  
2021 ducted air conditioning system for year-round comfort  
Fully established lemon myrtle plantation  
Two new poly water tanks installed in October 2024  
Several dams including one with a water pump for garden irrigation  
Rainforest plantings and native raspberries throughout the property  
Two separate wood pine plantation patches at the rear  
Large powered shed with 2 car ports plus space for a caravan, tractor or boat and work area  
Located just 8 minutes to Woodford and 30 minutes to Glass House Mountains  
1 hour to Brisbane airport

Don't miss this rare opportunity to secure a versatile lifestyle property with income potential and breathtaking views.

Call Jack Cornford today on 0484 241 803 to arrange your private inspection.

### MORE DETAILS

Property ID	UFJ0D
Property Type	House
Land Area	33.24 hectare

#### Jack Cornford 0484 241 803

Principal of Beerwah | [jack.cornford@ljhooker.com.au](mailto:jack.cornford@ljhooker.com.au)

#### LJ Hooker Beerwah (07) 5318 7277

4/22 Peachester Road, BEERWAH QLD 4519  
[Beerwah.ljhooker.com.au](mailto:Beerwah.ljhooker.com.au) | [beerwah@ljhooker.com.au](mailto:beerwah@ljhooker.com.au)



55-155 Burke Road  
Stanmore

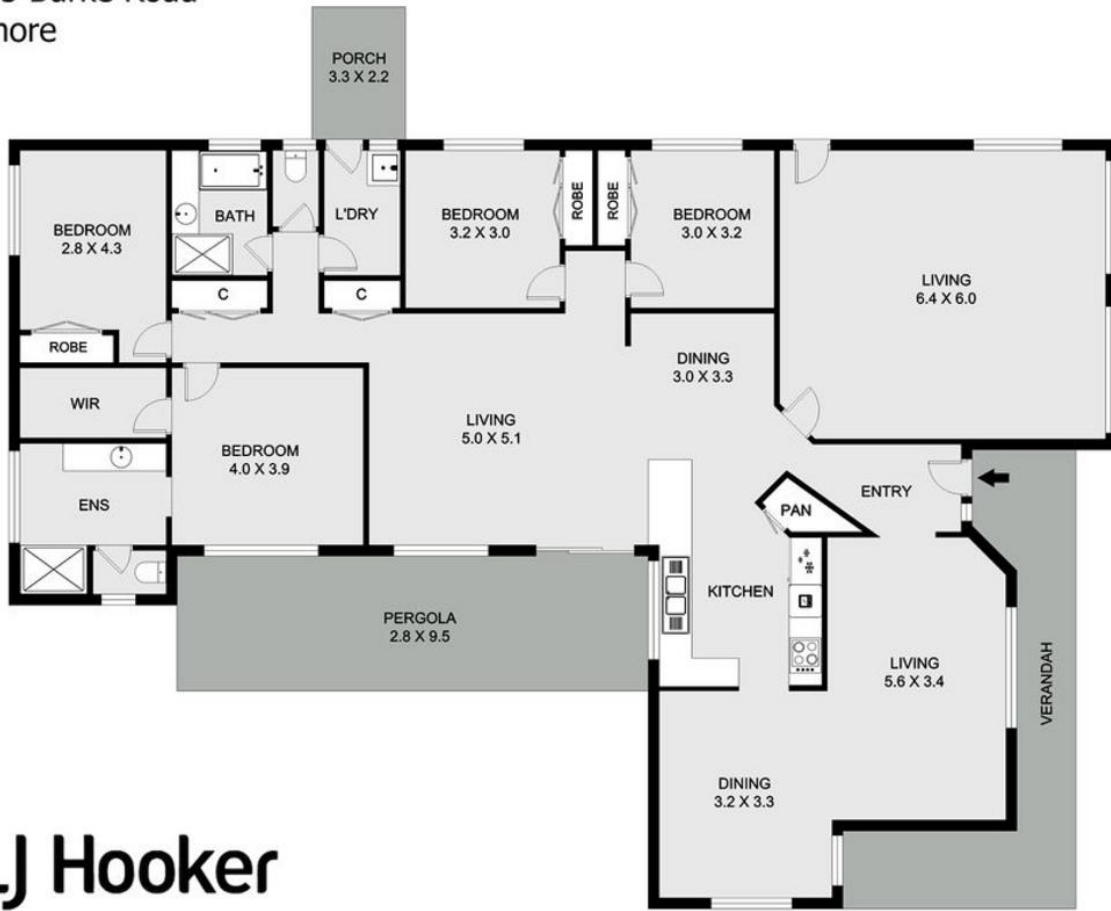

This floor plan is conceptual only, it is provided for illustrative purposes and should not be relied upon. We make no guarantee as to the accuracy of this plan, all interested parties should make and rely on their own enquiries in determining the accuracy and information contained on this floor or site plan.