



## St Helens, 10 Atlas Drive

Character home with stunning views

Perched in a prime St Helens location, 10 Atlas Drive is a captivating address boasting a home with classic charm and contemporary comfort, ideal for investors, retirees, developers or discerning homebuyers. This timeless 1961 oiled weatherboard home is presented in immaculate condition, with a focus on preserving its authentic character while catering for comfortable living.

Step into the gorgeous, light-filled home featuring three bedrooms, two offering tranquil easterly bay views, particularly stunning when greeted by the morning sun. The lounge and front veranda also share this enviable aspect, ensuring the picturesque scenery is a constant backdrop to everyday life. The heart of the home, a tasteful kitchen, is in excellent condition and adjoins the dining area where beautiful hardwood floorboards and a striking picture window create a warm and inviting space.

Outdoors, the easterly veranda provides a serene retreat for relaxation or alfresco dining



**Disclaimer:** All information contained therein is gathered from relevant third parties sources. We cannot guarantee or give any warranty about the information provided. Interested parties must rely solely on their own enquiries.



**For Sale**  
Please Call

**View**  
[ljhooker.com.au/PPGFN1](http://ljhooker.com.au/PPGFN1)

**Contact**  
**David Liebmann**  
0428 860 047  
[dliebmann.sthelens@ljhooker.com.au](mailto:dliebmann.sthelens@ljhooker.com.au)

**LJ Hooker St Helens**  
**(03) 6376 2300**

amidst the gentle coastal breeze, with wonderful bay views. Additional features include a large single garage, rain water tank and a remnant veggie patch. With Beauty Bay just 200m down the hill for swimming and fishing, and the town centre 1.5km along the walking track, this will be a location to treasure for generations.

St Helens is the largest centre on the East Coast and offers an enviable lifestyle for anyone who appreciates living within easy access to stunning natural beauty, fresh and saltwater fishing, surfing, diving, world-class mountain bike trails, bush walking and following exquisite food and wine trails. The town is fully serviced with schools, hospital, hardware, cafes and restaurants, community centre, light industrial area and employment opportunities.

10 Atlas Drive, with its excellent condition and untapped potential, invites you to envision a life or investment filled with peace, possibility, and panoramic views. Don't miss the chance to secure this slice of Tasmanian paradise.

Rates approximately \$1918

Zoned General Residential

## More About this Property

<b>Property ID</b>	PPGFN1
<b>Property Type</b>	House
<b>Land Area</b>	976 m2
<b>Including</b>	Toilets (1) Fire Place Balcony Deck Outdoor Entertaining Floorboards Built-in-Robes Water Tank

**David Liebmann 0428 860 047**  
Property Consultant | [dliebmann.sthelens@ljhooker.com.au](mailto:dliebmann.sthelens@ljhooker.com.au)

**LJ Hooker St Helens (03) 6376 2300**  
36 Cecilia Street, ST HELENS TAS 7216  
[sthelens.ljhooker.com.au](http://sthelens.ljhooker.com.au) | [sthelens@ljhooker.com.au](mailto:sthelens@ljhooker.com.au)



**LJ Hooker St Helens**  
**(03) 6376 2300**

**Disclaimer:** All information contained therein is gathered from relevant third parties sources. We cannot guarantee or give any warranty about the information provided. Interested parties must rely solely on their own enquiries.

# 10 Atlas Drive

This floor plan including furniture, fixture measurements and dimensions are approximate and for illustrative purposes only. LJ Hooker gives no guarantee, warranty or representation as to the accuracy and layout. All enquiries must be directed to the agent, vendor or party representing this floor plan.

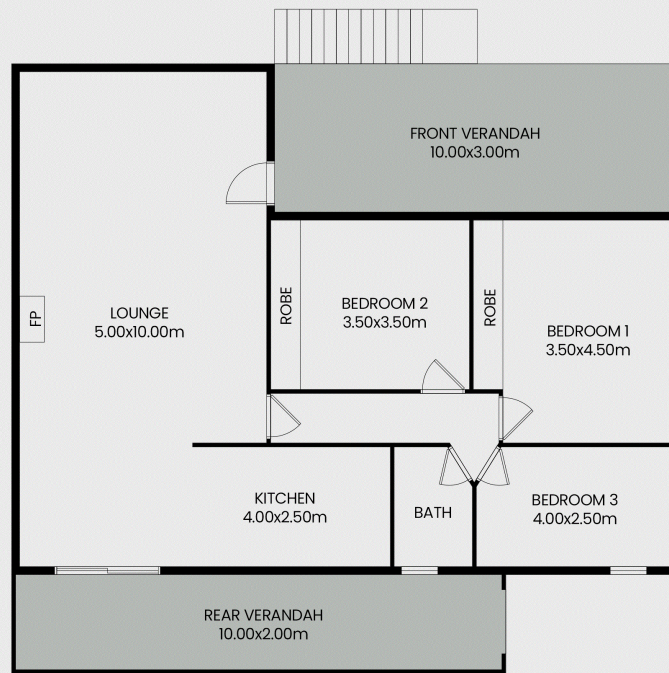

FLOOR PLAN



LJ Hooker St Helens  
(03) 6376 2300

**Disclaimer:** All information contained therein is gathered from relevant third parties sources. We cannot guarantee or give any warranty about the information provided. Interested parties must rely solely on their own enquiries.