

96/35 The Basin Road, St Georges Basin

Coastal Living



At Basin Shores, life moves at the pace you want it to. Whether you're into recreational activities such as tennis, fishing, boating and water sports, or simply relaxing by the pool with friends and family, Basin Shores has it all.

Only 2.5 hours drive south of Sydney and a 10km drive to Jervis Bay, Basin Shores provides the perfect location for the entire family to keep active and connect.

Located just 300 meters to the St Georges Basin waters edge and a short stroll to the township, Basin Shores is surrounded by some of Australia's most stunning beaches, lakes, estuaries, woodland and national parks so you can enjoy walking, birdwatching, swimming, fishing and canoeing.

This spacious three bedroom design with tandem carport, verandah and ample parking for visitors. With contemporary and modern features, the home is spacious and light filled. Delivered with quality finishes and attention to detail, your expectations will be exceeded in both function and beauty.

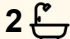
Your home will be your own personal sanctuary, within a private and secure community estate. Seamless light filled interiors designed to combine comfort with a low maintenance lifestyle, sleek kitchen with

3  2  2 

FOR SALE
\$679,000

VIEW
By Appointment

AGENTS
Martin Merritt
0412 424 226
martin.merritt@ljhwoollongong.com.au

AGENCY
LJ Hooker Wollongong | Corrimal |
Shellharbour
(02) 4229 8600

All information contained therein is gathered from relevant third parties sources.
We cannot guarantee or give any warranty about the information provided.
Interested parties must rely solely on their own enquiries.

 **LJ Hooker**

quality appliances, modern tiled bathroom and ensuite, large bedrooms and ample storage, all built to the highest of standards.

This impressive estate features fantastic community facilities, including:

- Tennis courts
- Bowling green
- Indoor heated swimming pool
- Community BBQ areas
- Kids playground
- Landscaped gardens

Recognised as one of the most attractive coastal living estates along the South Coast, Basin Shores is exactly what you've been looking for. Whether you're a first home buyer, investor, holiday maker or retiree, we are confident you will fall in love with everything Basin Shores has to offer.

MORE DETAILS

Property ID	W1CHQZ
Property Type	House
House Size	83 m2
Including	Ensuite Ducted Cooling Ducted Heating Toilets (2) Balcony Deck Dishwasher Floorboards Built-in-Robes Fully Fenced

Martin Merritt 0412 424 226

Principal | Licenced Real Estate Agent |
martin.merritt@ljhwollongong.com.au

LJ Hooker Wollongong | Corrimal | Shellharbour (02) 4229 8600

69 Kembla Street, WOLLONGONG NSW 2500
wollongong.ljhooker.com.au | wollongong@ljhooker.com.au



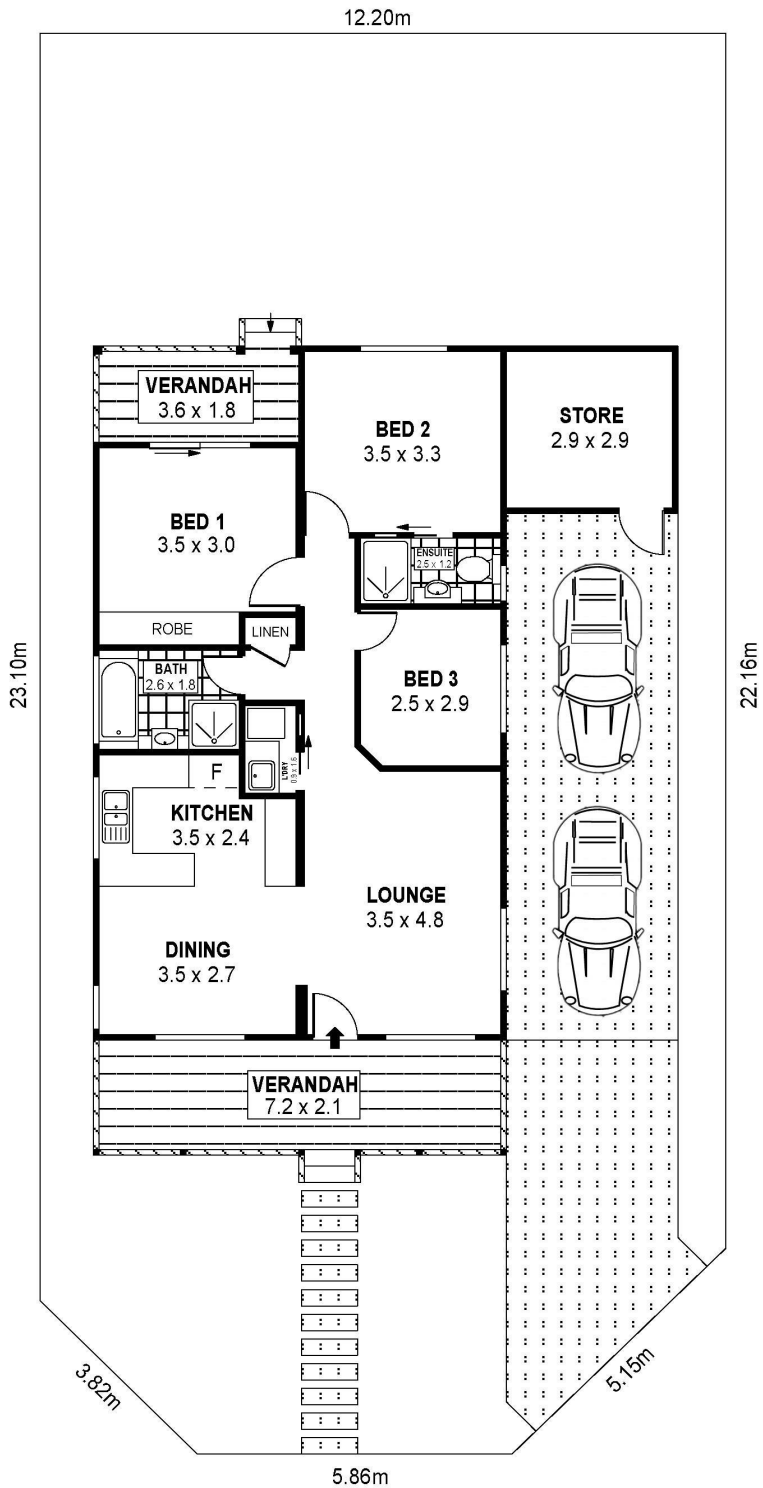

PLANS SHOWN ONLY INDICATIVE OF LAYOUT. DIMENSIONS ARE APPROXIMATE.
Ref. No: 010774



INT	: 83m ²
EXT	: 20m ²
STORE	: 8m ²

SITE 96, 35 THE BASIN ROAD

ST GEORGES BASIN

All information contained therein is gathered from relevant third parties sources.
We cannot guarantee or give any warranty about the information provided.
Interested parties must rely solely on their own enquiries.

