



6/24 Little Norman Street, Southport

## JUST LISTED IN THE HEART OF SOUTHPORT

This beautifully refurbished 2-bedroom, 1-bathroom townhouse with a single car space:

- Small block of only seven units
- Fully tiled living area with spacious kitchen on the lower level
- Polished timber floors upstairs in both bedrooms
- Main bedroom opens onto a huge balcony.
- An easy walk to the newly refurbished Australia Fair shopping and restaurant complex, the local Workers Club and Southport RSL.
- Only a few minutes' walk to the magnificent Broadwater Parklands with swim beach, BBQ and picnic facilities, children's play areas, Olympic standard aquatic centre and associated facilities, and the Southport CBD.
- 10 minutes' drive to Griffith University and Gold Coast Hospital.
- 50 minutes' drive to Brisbane CBD or take the train from Nerang.
- An outstanding investment in the heart of one of the Gold Coast's major growth suburbs
- Very low body corporate at \$48.90 per week.

2 🏠 1 🚿 1 🚗

### FOR SALE

Offers over \$570,000

### AGENTS

Michael Levonis

0414 323 997

[mlevonis.southport@ljhooker.com.au](mailto:mlevonis.southport@ljhooker.com.au)

### AGENCY

LJ Hooker Southport

(07) 5591 5222

All information contained therein is gathered from relevant third parties sources.  
We cannot guarantee or give any warranty about the information provided.  
Interested parties must rely solely on their own enquiries.

 **LJ Hooker**

## MORE DETAILS

Property ID 108HF4K  
Property Type Unit  
Including Balcony  
Dishwasher

**Michael Levonis 0414 323 997**

Salesperson | [mlevonis.southport@ljhooker.com.au](mailto:mlevonis.southport@ljhooker.com.au)

**LJ Hooker Southport (07) 5591 5222**

2308-2309 Level 3 Southport Central, Tower 2, 5 Lawson Street,  
SOUTHPORT QLD 4215  
[southport.ljhooker.com.au](http://southport.ljhooker.com.au) | [southport@ljhooker.com.au](mailto:southport@ljhooker.com.au)



All information contained therein is gathered from relevant third parties sources.  
We cannot guarantee or give any warranty about the information provided.  
Interested parties must rely solely on their own enquiries.

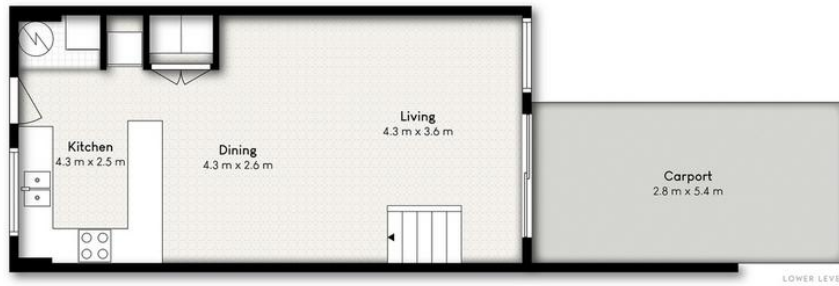

6/24 LITTLE NORMAN STREET, SOUTHPORT



Internal: 76m<sup>2</sup> | External: 30m<sup>2</sup> | Total: 106m<sup>2</sup>

Whilst every attempt has been made to ensure the accuracy of the floor plan contained here, measurements of doors, windows, rooms and any other item are approximate and no responsibility is taken for any error, omission, or misstatement. This plan is for illustrative purposes only and should only be used as such by any prospective purchaser.

