



Southport, 2/103 Pohlman Street

Fully renovated * Huge Parking * Ultra-Private * Lots of storage

Step into style and comfort with this beautifully renovated 2-bedroom townhouse in the heart of Southport. Perfectly positioned in a boutique complex of only four townhouses, this home offers exceptional privacy and a relaxed, low-maintenance lifestyle.

Key features:

- * Fully renovated throughout - move in and enjoy
- * Two spacious bedrooms, each with modern finishes
- * Large luxury modern 2-way bathroom upstairs
- * Laundry/powder room plumbed ready to go downstairs for additional shower
- * Clever storage space both inside and out
- * Parking for up to 5 cars - a rare find
- * Only 4 townhouses in a quiet, well-kept complex



Disclaimer: All information contained therein is gathered from relevant third parties sources. We cannot guarantee or give any warranty about the information provided. Interested parties must rely solely on their own enquiries.

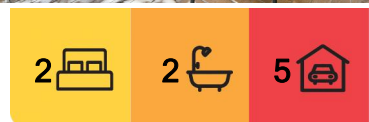

For Sale
Offers Over \$769,000

View
By Appointment

Contact
Alexander Bally
0410 650 470
abally@ljhgc.com.au

LJ Hooker Nerang
(07) 5581 4422

- * Split system air-conditioning
- * Security screens throughout
- * Landscaped low maintenance gardens
- * Full roof restoration paid for and getting done soon
- * New blinds through out
- * Fully insulated
- * Garden shed
- * Low body corp fees

Located just minutes from the CBD, Broadwater, Griffith University and the Gold Coast University Hospital, this home offers unbeatable convenience while still feeling tucked away from the hustle and bustle.

Building and pest available on request.

Open homes start this Friday through till Monday, all offers will be presented the following day.

More About this Property

Property ID	5H4VF41
Property Type	Townhouse

Alexander Bally 0410 650 470
Sales Specialist | abally@ljhgc.com.au

LJ Hooker Nerang (07) 5581 4422
2-4 New Street, NERANG QLD 4211
nerang.ljhooker.com.au | nerang@ljhgc.com.au



LJ Hooker Nerang
(07) 5581 4422

Disclaimer: All information contained therein is gathered from relevant third parties sources. We cannot guarantee or give any warranty about the information provided. Interested parties must rely solely on their own enquiries.

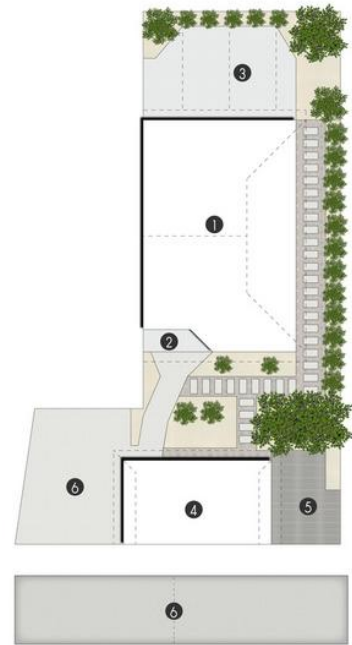
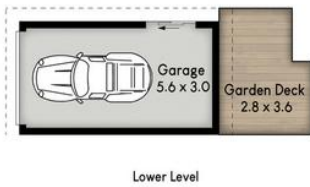

- Legend**
- 1. Residence
 - 2. Porch
 - 3. Covered Entertainment
 - 4. Garage
 - 5. Garden Deck
 - 6. Car Space

2/103 POHLMAN STREET, SOUTHPORT

2 2 5

Internal: 135m² | External: 32m² | Total: 167m²

Whilst every attempt has been made to ensure the accuracy of the floor plan contained here, measurements of doors, windows, rooms and any other item are approximate and no responsibility is taken for any error, omission, or misstatement. This plan is for illustrative purposes only and should only be used as such by any prospective purchaser.

