



8 Trevally Place, Sandstone Point

UNDER CONTRACT PRIOR TO AUCTION

Positioned in a peaceful, family-friendly cul-de-sac, 8 Trevally Place in Sandstone Point offers the perfect blend of comfort, space, and relaxed coastal living.

Set on a generous 660sqm block, this large family home presents an outstanding opportunity for growing families or savvy investors. The home features four spacious bedrooms and two bathrooms, thoughtfully designed to support easy, everyday living.

Inside, you'll find a light-filled layout where the open-plan kitchen, dining, and living areas seamlessly connect, creating a welcoming central hub for the home. Designed to capture natural breezes, the interiors feel fresh and inviting all year round, while a second living area adds flexibility for families needing extra space.



Whether it's hosting weekend barbecues or enjoying quiet evenings under the stars, this home embraces the best of coastal living.

Conveniently located close to local shops, schools, and the waterfront, you'll enjoy easy access to everything Sandstone Point has to offer, while still appreciating the tranquillity of this quiet setting.

While the home could benefit from a touch of internal updating, it presents incredible potential to add value and truly make it your own.

Property Features:

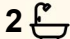
- 4 spacious bedrooms

4  2  3 

FOR SALE

Please Call

AGENTS

Craig Gillard
0410 553 557
craig.gillard@ljhooker.com.au

Izabella Shipley
0437 106 269
izabella.shipley@ljhooker.com.au

AGENCY

LJ Hooker Bribie Island
(07) 3400 1900

All information contained therein is gathered from relevant third parties sources.
We cannot guarantee or give any warranty about the information provided.
Interested parties must rely solely on their own enquiries.



- 2 modern bathrooms
- Double car accommodation with drive-through access (ideal for boat or jet ski storage)
- Generous 660sqm block
- Open-plan kitchen, dining, and living areas
- Additional living space for added flexibility
- Light-filled interiors with excellent natural airflow
- Large backyard with room for a pool or shed
- Quiet cul-de-sac location
- Rainwater tanks with pumps
- 5kw solar system
- Garden sheds

Sandstone Point is a relaxed coastal suburb in the Moreton Bay region, just minutes from Bribie Island. Known for its waterfront lifestyle and family-friendly atmosphere, it offers convenient access to local amenities, schools, and dining—making it a highly desirable place to call home.

For more information or to arrange your inspection, contact:

Graig Gillard – 0410 553 557

Izabella Shipley – 0437 106 269

A fantastic opportunity to secure a quality home in a sought-after coastal community—don't miss your chance to make it yours.

MORE DETAILS

Property ID	XBNHCP
Property Type	House
Land Area	660 m2

Craig Gillard 0410 553 557

Principal/Licensee | craig.gillard@ljhooker.com.au

Izabella Shipley 0437 106 269

Administration | izabella.shipley@ljhooker.com.au

LJ Hooker Bribie Island (07) 3400 1900

16/19 Benabrow Avenue, BELLARA QLD 4507

bribieisland.ljhooker.com.au | sales.bribieisland@ljhooker.com.au



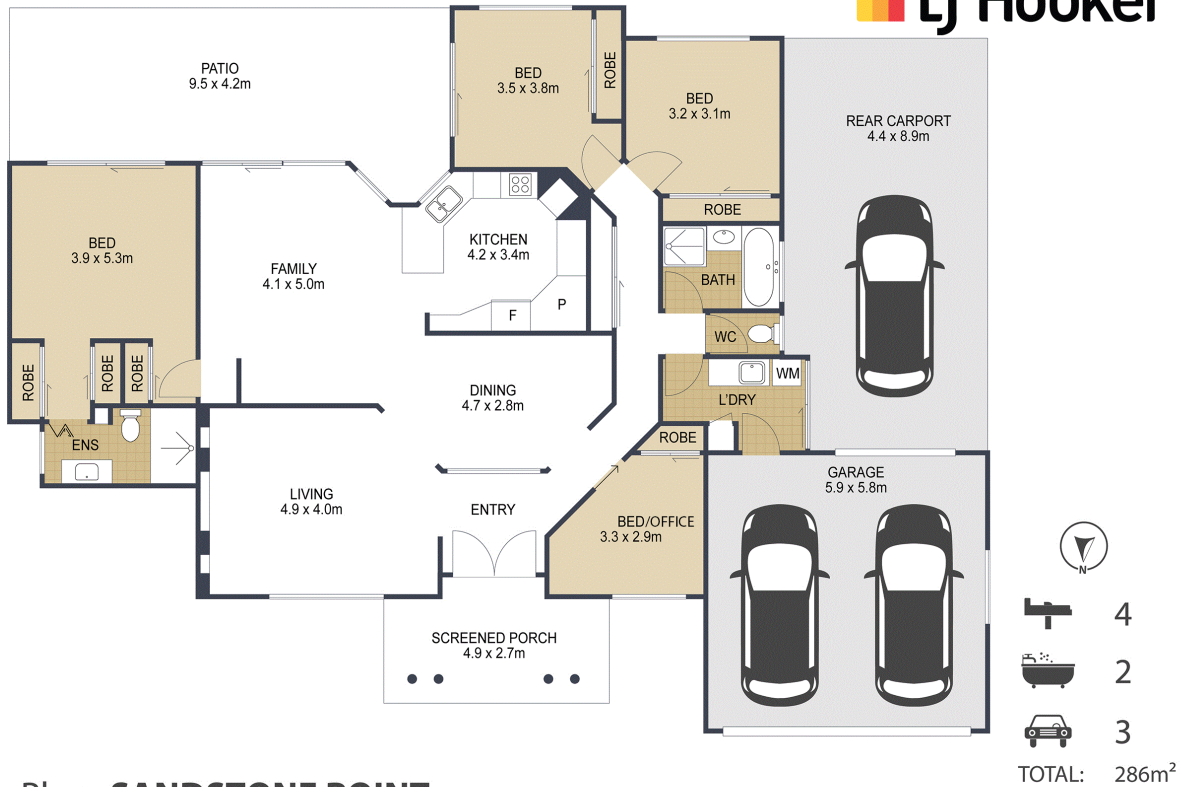

8 Trevally Place SANDSTONE POINT

ARTIST'S IMPRESSION ONLY: While every attempt has been made to ensure the accuracy of this floor plan's areas and measurements of doors, windows, rooms and all other items are approximate and no responsibility is taken for any error, omission, or mis-statement. This plan is for illustrative purposes only and should only be used as such by any prospective purchaser. Floor plan by: www.open2view.com.au