

Russell Island, 19 Canaipa Drive

Small Business Opportunity: Motel Being Built Next Door

Island Entrepreneurs Act Fast!

Prime opportunity for a home based business just a few hundred meters from the village shopping centre, ferry and barge terminal.

This recently refurbished high set home, zoned SMBI Centre Development, is the perfect opportunity to set up your home offices, consulting rooms, shop or cafe/restaurant downstairs while you set up home upstairs.

The House

Highset with a combination of genuine timber and easy care tile floors

Spacious lounge area and separate, huge eat in kitchen

Three larger than average bedrooms

Separate bathroom and toilet

Storage galore with detached double garage

New paint, windows, screens and gutters

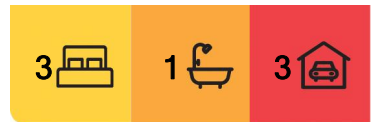

For Sale
By Negotiation

View
By Appointment

Contact
Donna Pinkerton
0400 997 699
dpinkerton@ljhpropertycentre.com.au

LJ Hooker Property Centre
(07) 3286 2500

Disclaimer: All information contained therein is gathered from relevant third parties sources. We cannot guarantee or give any warranty about the information provided. Interested parties must rely solely on their own enquiries.

Solar hot water

The Block

Spacious 759m2 allotment with ample room for client parking

Level and fenced on 2 sides

The Location

Great exposure location on main road

To Passenger ferry and vehicle barge: 2 min (600m)

To Village shopping: 2 min (450m)

To Bay Islands Aquatic Centre: 1 min (400m)

To Primary School: 1 min (550m)

To Russell Island RSL: 2 min (950m)

To Russell Island Bowls Club: 3 min (2.1km)

To Jock Kennedy Boat Ramp: 2 min (1km)

For a copy of the Develo report containing information regarding all overlays and utility placements and SMBI zoning fact sheet just hit the enquire button now.

Russell Island is part of Redland City, Queensland and the largest of the Southern Moreton Bay Islands. It has a length of 8 kilometers and width of nearly 3 kilometers and is situated between North Stradbroke Island and the mainland. Home to evocatively named landmarks such as Kinbbinkibbinwa Point, Ooncooncoo Bay and the Whistling Kite Wetlands, Russell (Canaipa) has a rich history; originally inhabited by indigenous residents later limeburners, timbergetters, oystermen and sugar, fruit and cotton farmers of yesteryear called the island home.

We now have a range of facilities and services that include an RSL and Bowls Club, a shopping center that includes a Supa IGA, post office, bakery and hair dresser. We also have a police station, ambulance center, public swimming pool, primary school, child care centre hardware store, petrol station, vet, pet store, and several great cafes. There is also a medical center, pathology collection center and pharmacy.

The waters around the Southern Moreton Bay Islands are a great attraction for boaties of every type, canoeists and fisherman. For tourists, tripadvisor suggests that visitors enjoy our beautiful sunrises and sunsets from our coastline or parks, the biking and walking trails. We also have a number of Galleries, markets scheduled on a regular basis and swimming pool. weekendnotes.com lists Russell island as number 4 in the top places to Kayak in Brisbane

All information contained herein is gathered from sources we consider to be reliable. However, we cannot guarantee or give any warranty about the information provided. Interested parties must solely rely on their own enquiries.

Note: This property is being sold without a price and therefore a price guide cannot be provided. The website may have filtered the property into a price bracket for website functionality purposes only.



LJ Hooker Property Centre
(07) 3286 2500

Disclaimer: All information contained therein is gathered from relevant third parties sources. We cannot guarantee or give any warranty about the information provided. Interested parties must rely solely on their own enquiries.

More About this Property

Property ID	BRQCF2S
Property Type	House
Land Area	759 m ²

Donna Pinkerton 0400 997 699

Independent Contractor - Canaipa Residential Pty Ltd |
dpinkerton@ljhpropertycentre.com.au

LJ Hooker Property Centre (07) 3286 2500

152-164 Shore Street West, Raby Bay, Brisbane QLD 4163
propertycentre.ljhooker.com.au | hello@ljhpc.com.au



Disclaimer: All information contained therein is gathered from relevant third parties sources.
We cannot guarantee or give any warranty about the information provided. Interested parties must rely solely on their own enquiries.

LJ Hooker Property Centre
(07) 3286 2500

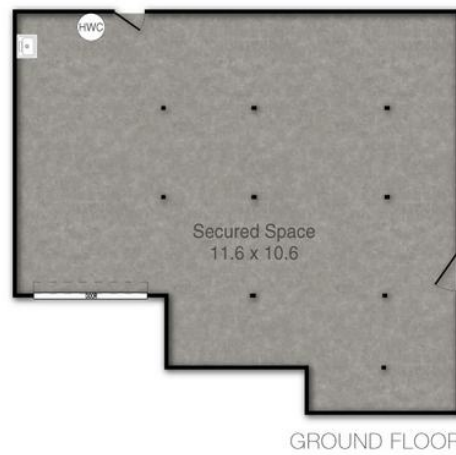

19 Canaipa Road, Russell Island

PLEASE NOTE THIS PLAN IS FOR MARKETING PURPOSES AND IS TO BE USED AS A GUIDE ONLY. ALL MARKINGS, MEASUREMENTS, AREAS, AND LAYOUT ARE INDICATIVE ONLY AND INTERESTED PARTIES SHOULD MAKE THEIR OWN ENQUIRIES BEFORE MAKING ANY DECISIONS. FLOOR COVERINGS INDICATED ARE FOR ILLUSTRATIVE PURPOSES ONLY AND MAY NOT ACCURATELY PORTRAY ACTUAL FLOOR COVERINGS OF THE PROPERTY. NO GUARANTEES ARE MADE REGARDING THE INFORMATION CONTAINED IN THIS PLAN AND NO LIABILITY FOR ANY INACCURACIES IS ACCEPTED.