



36 Yusen Street (Grantham Farm), Riverstone

## **SOLD BY SANJEEV KUMAR RIVERSTONE & GRANTHAM FARM SPECIALIST 0433 289 620 FOR DETAILS**

Sanjeev Kumar and the LJ Hooker team is proud to present this exquisite family home to the market. This stunning double-storey residence combines elegance, comfort, and practicality, offering the perfect setting to create lasting family memories. Designed with impeccable style and a functional layout, it stands out for its thoughtful details and premium finishes. Conveniently located close to schools, shops, and transport, LJ Hooker Schofields warmly invites you to discover your next home.

### Key Features:

- Five generously sized bedrooms, including a grand master suite with a floor-to-ceiling tiled ensuite and a spacious walk-in wardrobe for ultimate comfort.
- A stunning chef's kitchen featuring gas cooking, stainless steel appliances, range hood, walk-in pantry, 40mm stone benchtops, an island with seating, and abundant storage.
- Expansive open-plan living and dining areas seamlessly

4 🏠 2 🚿 1 🚗

### FOR SALE

SOLD by Sanjeev Kumar

### AGENTS

Sanjeev Kumar

0433 289 620

sanjeev.kumar@ljhooker.com.au

### AGENCY

LJ Hooker Schofields | Riverstone

02 9157 4077

All information contained therein is gathered from relevant third parties sources.  
We cannot guarantee or give any warranty about the information provided.  
Interested parties must rely solely on their own enquiries.



connected to the kitchen, creating a perfect space for family gatherings and entertaining.

- Ducted air-conditioning with smart control functionality, allowing comfort at your fingertips all year round.
- A large alfresco area overlooking a well-sized backyard - ideal for entertaining family and friends.
- Main bathroom complete with a freestanding bathtub, floor-to-ceiling tiles, large vanity with ample storage, and a spacious shower.
- Single automatic garage with internal access for convenience and security.
- High ceilings throughout the living spaces and garage, complemented by LED downlights and elegant pendant lighting.
- 6.6kw Solar Panels

#### Location Highlights:

- 1.8 km to Riverstone Village (approx.)
- 1.9 km to Riverstone Station (approx.)
- 3 km to Carmel Village Shopping Centre (approx.)
- 5 km to Tallawong Metro Station (approx.)
- 7 km to Rouse Hill Town Centre (approx.)

#### Schools & Education:

- 1 km to St. John's Primary School (approx.)
- 1.3 km to Riverstone Public School (approx.)
- 1.3 km to Norwest Christian School (approx.)
- 1.6 km to Riverstone High School (approx.)

Welcome to 36 Yusen Street, Riverstone - a home where family dreams become reality.

Don't miss your chance to make it yours. Contact Sanjeev Kumar on 0433 289 620 for more information. We look forward to welcoming you at the open home.

• \*\*\*

**DISCLAIMER:** This advertisement contains information provided by third parties. While all care is taken to ensure otherwise, LJ Hooker Schofields does not make any representation as to the accuracy of the information contained in the advertisement, does not accept any responsibility or liability, and recommends that any client make their own investigations and inquiries. All images are indicative of the property only.

## MORE DETAILS

Property ID	4JJHXY
Property Type	House
Land Area	272.7 m2
Including	Ensuite
	Air Conditioning
	Toilets (3)
	Dishwasher
	Built-in-Robes
	Solar Panels

### Sanjeev Kumar 0433 289 620

Director | Licensee | [sanjeev.kumar@ljhooker.com.au](mailto:sanjeev.kumar@ljhooker.com.au)

### LJ Hooker Schofields | Riverstone 02 9157 4077

Shop 35, 111 Railway Terrace, SCHOFIELDS NSW 2762  
[schofields.ljhooker.com.au](http://schofields.ljhooker.com.au) | [schofields@ljhooker.com.au](mailto:schofields@ljhooker.com.au)

All information contained therein is gathered from relevant third parties sources. We cannot guarantee or give any warranty about the information provided. Interested parties must rely solely on their own enquiries.

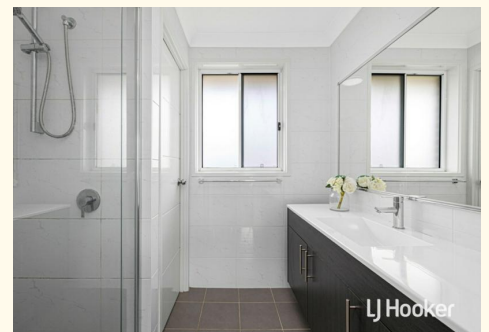

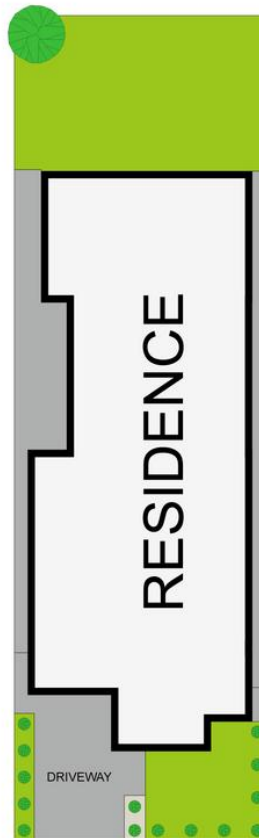
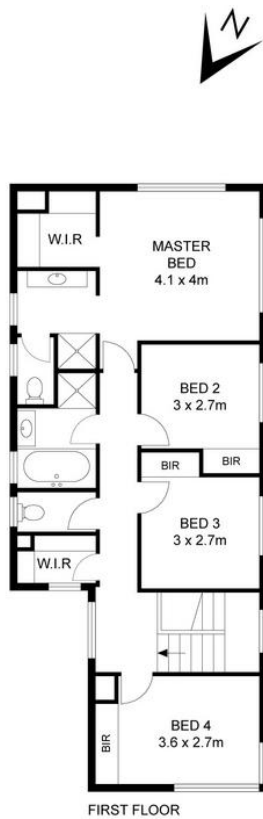

0 1 2 3 4 5  
SCALE (METRES)

## 36 Yusen Street, Riverstone

Disclaimer: Floor plans and site plans are intended as a guide only. They are not part of any legal document or title and are subject to errors, omission, and inaccuracies and should not be used as reference. Sizes and dimensions are approximate only. Interested parties should make their own enquiries. Floor plan by : Sync Studios Pty Ltd

