



17 Trippe Street (Grantham Farm), Riverstone

North Facing Versatile Family Home - walk to Upcoming Primary School

Sanjeev Kumar, Kit Patel and the LJ Hooker Schofields | Riverstone team present this beautifully designed double-storey residence in the highly sought-after Grantham Farm precinct, offering the perfect combination of style, space, and everyday convenience.



Thoughtfully crafted with modern family living in mind, this home showcases quality finishes, a versatile floor plan, and seamless indoor-outdoor integration-ideal for both entertaining and relaxed living.

Positioned in a growing, family-friendly community, the home is within close proximity to local schools, shopping centres, parks, and transport options. Whether you're a growing family, first-home buyer, or savvy investor, this property presents an outstanding opportunity to secure a low-maintenance lifestyle without compromise.

Features Include:

- Generous master bedroom with walk-in robe and private ensuite
- Three additional spacious bedrooms, all with built-in wardrobes

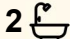
All information contained therein is gathered from relevant third parties sources. We cannot guarantee or give any warranty about the information provided. Interested parties must rely solely on their own enquiries.

5  2  2 

FOR SALE

Just Listed

VIEW

Sat 11th Apr @ 11:20AM - 11:40AM

AGENTS

Sanjeev Kumar
0433 289 620
sanjeev.kumar@ljhooker.com.au

Kit Patel
0466 412 920
kit.patel@ljhooker.com.au

AGENCY

LJ Hooker Schofields | Riverstone
02 9157 4077

 **LJ Hooker**

- Versatile ground-floor lounge or optional fifth bedroom, ideal as a home office or guest room
- Expansive open-plan family and dining area plus additional living space flowing to alfresco
- Well-appointed gourmet kitchen with pantry, ample bench space, and storage
- Large upstairs rumpus room perfect for a media or kids' retreat
- Double garage with internal access and additional storage
- Modern family bathroom, separate laundry, and convenient powder room on the ground floor
- Low-maintenance block with welcoming porch, driveway, and outdoor entertaining area

Location Highlights:

- Approx. 650m walk to Maya Park
- Approx. 2.0km to Riverstone Station
- Approx. 2.3km to Carmel Village Shopping Centre
- Approx. 5.9km to Tallawong Metro
- Approx. 5.5km to Schofields Station
- Approx. 5.6km to Schofields Village
- Approx. 7.8km to Rouse Hill Town Centre
- Approx. 9.0km to Sydney Business Park (Costco, IKEA, ALDI, Bunnings and more)

Schools & Education:

- Approx. 1.1km to Upcoming Grantham Farm Public School
- Approx. 1.3km to St John's Primary School
- Approx. 1.6km to Riverstone Public School
- Approx. 1.7km to Norwest Christian College
- Approx. 2.0km to Riverstone High School
- Approx. 9.6km to Wyndham College

Welcome to a home where comfort meets convenience, and family living is elevated to a new level. Contact Sanjeev or Kit to arrange your private inspection.

• **

DISCLAIMER: This advertisement contains information provided by third parties. While all care is taken to ensure otherwise, LJ Hooker Schofields | Riverstone does not make any representation as to the accuracy of the information contained in the advertisement, does not accept any responsibility or liability and recommends that any client make their own investigations and inquiries. Agent discloses property is four bedroom per brochure and floor plan but has potential to make a fifth bedroom if desired. All images are indicative of the property only.

MORE DETAILS

Property ID 532HXY
Property Type House
Including Air Conditioning
Outdoor Entertaining
Built-in-Robes
Secure Parking

Sanjeev Kumar 0433 289 620

Director | Licensee | sanjeev.kumar@ljhooker.com.au

Kit Patel 0466 412 920

Sales Associate | kit.patel@ljhooker.com.au

LJ Hooker Schofields | Riverstone 02 9157 4077

Shop 35, 111 Railway Terrace, SCHOFIELDS NSW 2762
schofields.ljhooker.com.au | schofields@ljhooker.com.au



All information contained therein is gathered from relevant third parties sources.
We cannot guarantee or give any warranty about the information provided.
Interested parties must rely solely on their own enquiries.

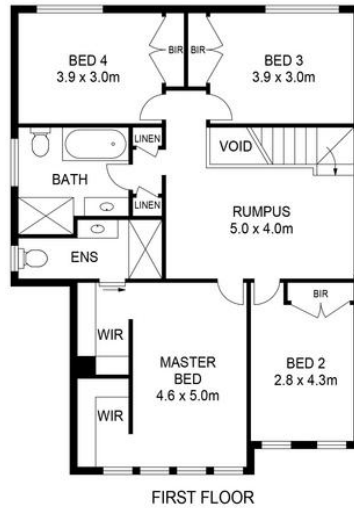

17 TRIPPE STREET, GRANTHAM FARM



DISCLAIMER DIMENSIONS ARE APPROXIMATE AND SHOULD BE USED AS A GUIDE THEY ARE NOT TO SCALE AND NO LIABILITY BE ACCEPTED. Floor plan by: The House Media Co Pty. Ltd.

All information contained therein is gathered from relevant third parties sources. We cannot guarantee or give any warranty about the information provided. Interested parties must rely solely on their own enquiries.

