



## Redland Bay, 59/20 Salisbury Street

SOLD BY KAREN RENOUF

Located in the peaceful modern Seascape Estate this stunning 3-bedroom, 2-bathroom, single garage home with additional off-street parking. It is the perfect opportunity for those seeking a spacious and modern property in a sought-after location. The open plan living and dining area seamlessly flow into the kitchen, creating the perfect space for entertaining family and friends. The kitchen boasts modern appliances, storage, and a sleek design. From this area we transfer seamlessly via glass sliding doors to the undercover alfresco dining area.

- \* Modern Kitchen w/ Stone Benchtops, dishwasher and plenty of storage and soft close drawers and cupboards
- \* Master bedroom complete with Ensuite, Robes, Ceiling fan and air conditioning
- \* 2 Additional bedrooms with built in robes, ceiling fans and one with additional A/C
- \* Family bathroom with separate bath and shower
- \* Separate toilet



**Disclaimer:** All information contained therein is gathered from relevant third parties sources. We cannot guarantee or give any warranty about the information provided. Interested parties must rely solely on their own enquiries.

3

2

1

**For Sale**  
Offers Invited

**View**  
[ljhooker.com.au/BRGFF2S](http://ljhooker.com.au/BRGFF2S)

**Contact**  
**Karen Renouf**  
0413 473 461  
[krenouf@ljhpropertycentre.com.au](mailto:krenouf@ljhpropertycentre.com.au)  
**Tony Webber**  
0457 637 578  
[twebber@ljhpropertycentre.com.au](mailto:twebber@ljhpropertycentre.com.au)

**LJ Hooker Property Centre**  
**(07) 3286 2500**

- \* Separate Laundry
- \* LED Lighting Throughout
- \* Ceiling Fans Throughout
- \* Garden shed
- \* Single remote-controlled lock up garage with storage
- \* Additional half undercover car park
- \* 6.6 KW Solar System
- \* Crim safe screens on all windows and doors
- \* Additional external pull down sun blinds front and rear of the property.

Pull Down shade blinds in Alfresco area.

- \* Private spacious alfresco entertainment area
- \* Spacious & Low Maintenance Backyard with plenty of artificial lawn
- \* Low Body Corporate Fees only \$55 per week

Rates \$680 per quarter

Large Swimming Pool to enjoy the refreshing waters of a spacious pool right within the complex. Whether you're a serious swimmer or simply looking to cool off on a hot day. BBQ Area to host gatherings and cookouts with ease. Invite friends and family over for delicious meals while enjoying the outdoors. It's an ideal setting for memorable get-togethers.

Communal Garden space is a serene escape for green thumbs and those who appreciate the beauty of nature. Whether you're an experienced gardener or simply want a peaceful place to relax outdoors, this garden space will help you relax and unwind.

Inhouse Function Room which provides a versatile venue that can be used for events, celebrations, or community meetings. It's a valuable addition for residents seeking a convenient and communal space.

Only minutes away from shops, eateries, schools and easy access to the bay- this home has to be on the top of your list.

## More About this Property

Property ID	BRGFF2S
Property Type	Villa
Land Area	147 m²
Including	Air Conditioning Dishwasher Built-in-Robes Secure Parking Fully Fenced

**Karen Renouf 0413 473 461**

High Performance Agent - Team Renouf Properties Pty Ltd at LJH Property Centre  
| krenouf@ljhpropertycentre.com.au

**Tony Webber 0457 637 578**

Sales Agent â€“ Team Renouf Properties Pty Ltd |  
twebber@ljhpropertycentre.com.au

**LJ Hooker Property Centre (07) 3286 2500**

152-164 Shore Street West, Raby Bay, Brisbane QLD 4163  
propertycentre.ljhooker.com.au | hello@ljhpc.com.au



**Disclaimer:** All information contained therein is gathered from relevant third parties sources. We cannot guarantee or give any warranty about the information provided. Interested parties must rely solely on their own enquiries.



**LJ Hooker Property Centre**  
**(07) 3286 2500**



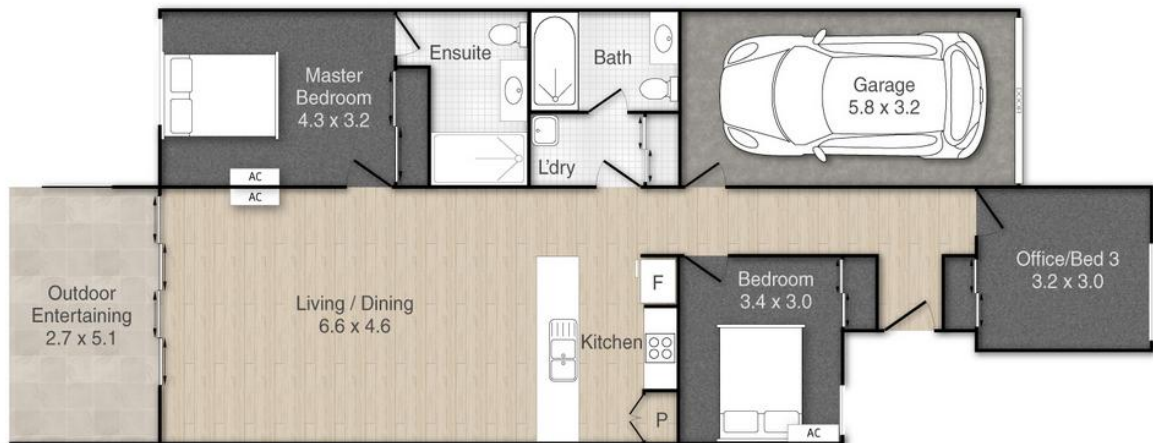

## 59/20 Salisbury Street, Redland Bay

Total Approx Floor Area: 126m<sup>2</sup>

PLEASE NOTE THIS PLAN IS FOR MARKETING PURPOSES AND IS TO BE USED AS A GUIDE ONLY. ALL MARKINGS, MEASUREMENTS, AREAS, AND LAYOUT ARE INDICATIVE ONLY AND INTERESTED PARTIES SHOULD MAKE THEIR OWN ENQUIRIES BEFORE MAKING ANY DECISIONS. FLOOR COVERINGS INDICATED ARE FOR ILLUSTRATIVE PURPOSES ONLY AND MAY NOT ACCURATELY PORTRAY ACTUAL FLOOR COVERINGS OF THE PROPERTY. NO GUARANTEES ARE MADE REGARDING THE INFORMATION CONTAINED IN THIS PLAN AND NO LIABILITY FOR ANY INACCURACIES IS ACCEPTED.