



13 Hereweka Street, Portobello

Your Portobello Hideaway Awaits

Deadline sale closing 2pm Thursday, 13th November 2025 (prior unconditional offers may be considered)

In the heart of Portobello lies a hidden treasure on an expansive 1,448m² section. This charming one-bedroom cottage has been tastefully updated to offer a modern feel while staying true to its original character.

Complemented by a large single garage, an outbuilding, and an additional shed, this property blends functionality with charm.

Set among established trees with its own microclimate and a peaceful stream meandering through, it's a haven of tranquility. Located within walking distance to the Portobello community and the ever-popular cycle and walkway, this home invites you to embrace the very best of relaxed Peninsula living.

Don't miss your opportunity to secure this home for yourself!

1 1 1

FOR SALE

Negotiation

AGENTS

Toni Curline
0212225469
toni@ljhdunedin.co.nz

Reagan Curline
0278464545
reagan@ljhdunedin.co.nz

AGENCY

LJ Hooker Dunedin
(03) 470 1370
Wayne Graham Realty Ltd

All information contained therein is gathered from relevant third parties sources.
We cannot guarantee or give any warranty about the information provided.
Interested parties must rely solely on their own enquiries.



MORE DETAILS

Property ID 3QFQGDS
Property Type House
Land Area 1448 m2
Licensed Real Estate Agents (REAA2008)

Toni Curline 0212225469

Licensee | toni@ljhdunedin.co.nz

Reagan Curline 0278464545

Licensee | reagan@ljhdunedin.co.nz

LJ Hooker Dunedin (03) 470 1370

Wayne Graham Realty Ltd

63 Musselburgh Rise, DUNEDIN 9013

dunedin.ljhooker.co.nz | dunedin@ljhdunedin.co.nz



All information contained therein is gathered from relevant third parties sources.
We cannot guarantee or give any warranty about the information provided.
Interested parties must rely solely on their own enquiries.

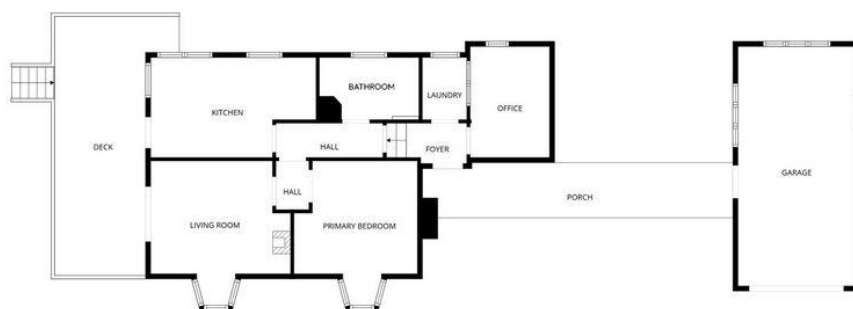

This floor plan is not to scale and is for illustrative purposes only.