

## Pimlico, 66 Pimlico Road

### Affordable Lifestyle Opportunity

Auction Location: Lennox Head Cultural Centre

Situated directly opposite emigrant creek, this property provides a rare opportunity to secure a property on 2413m<sup>2</sup>, and just minutes' drive to Ballina, Alstonville and surrounding beaches.

The current block includes an existing home that requires extensive renovations, making it an ideal project for those looking to invest or to build their own custom residence to fit their lifestyle. In addition to the home, the property features a swimming pool, a half tennis court, and a double lock-up garage, providing a variety of amenities that enhance its appeal.

The location provides a peaceful rural setting with the coastal convenience giving you the chance to secure a large parcel of land with great potential. Whether you're looking to



**Disclaimer:** All information contained therein is gathered from relevant third parties sources. We cannot guarantee or give any warranty about the information provided. Interested parties must rely solely on their own enquiries.

3

2

4

**For Sale**

Auction Guide - \$350,000

**View**

[ljhooker.com.au/1XQMF5A](https://ljhooker.com.au/1XQMF5A)

**Contact**

**Travers Golding**

0481 257 710

[travers.golding@ljhooker.com.au](mailto:travers.golding@ljhooker.com.au)

**Will Woolley**

0412 133 279

[will.woolley@ljhooker.com.au](mailto:will.woolley@ljhooker.com.au)

**LJ Hooker Ballina**  
**(02) 6686 2711**

renovate, rebuild, or invest.

- Level 2413m2 block with existing infrastructure.
- Ideal for those desiring to build there own custom residence to fit lifestyle.
- Directly opposite Emigrant Creek.
- Just minutes' drive to Ballina, Alstonville and surrounding beaches.
- Features include a swimming pool, a half tennis court, and a double lock-up garage
- Location providing a peaceful rural setting with the coastal convenience.



## More About this Property

<b>Property ID</b>	1XQMF5A
<b>Property Type</b>	House
<b>Land Area</b>	2413 m <sup>2</sup>
<b>Including</b>	Toilets (2)

### Travers Golding 0481 257 710

Salesperson | [travers.golding@ljhooker.com.au](mailto:travers.golding@ljhooker.com.au)

### Will Woolley 0412 133 279

Sales Consultant | [will.woolley@ljhooker.com.au](mailto:will.woolley@ljhooker.com.au)

### LJ Hooker Ballina (02) 6686 2711

87 - 89 River Street, BALLINA NSW 2478

[ballina.ljhooker.com.au](http://ballina.ljhooker.com.au) | [ballina@ljhooker.com.au](mailto:ballina@ljhooker.com.au)



**LJ Hooker Ballina**  
**(02) 6686 2711**

**Disclaimer:** All information contained therein is gathered from relevant third parties sources. We cannot guarantee or give any warranty about the information provided. Interested parties must rely solely on their own enquiries.

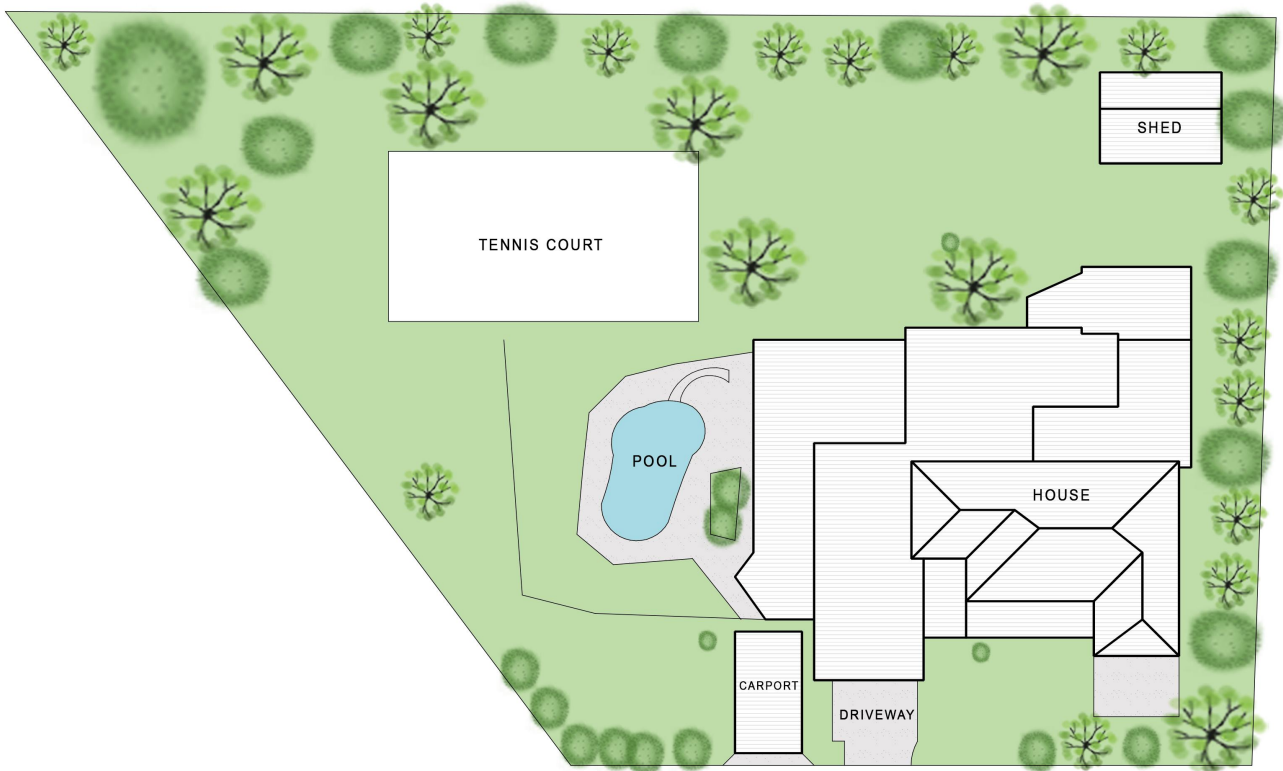

66 Pimlico Road, Pimlico

Floor Plan Disclaimer: Media Drive (MD) floor plans / site plans are intended as an approximate guide only. No representations or warranties of any nature are given or intended and any person using this information other than as a guide should always rely on their own enquiries. Media Drive property marketing services / 0413979204 / Photography, Floor plans, Video, Aerial photography / www.mediadrive.com.au



**LJ Hooker Ballina**  
**(02) 6686 2711**

**Disclaimer:** All information contained therein is gathered from relevant third parties sources. We cannot guarantee or give any warranty about the information provided. Interested parties must rely solely on their own enquiries.