



Sold



59 Riverbank Road, Pimlico

This Immaculate Home with Views of Richmond River

This immaculate home is beautifully modernised with uninterrupted views of the Richmond River. Carpeted bedrooms and floating timber floors make this fresh modern home, move in ready! The kitchen is a focal point of the home with subway tile splash back, stone look benchtops and ample wall pantry. This three-bedroom home with a 4th room for versatile use, are all carpeted with ceiling fans. A tandem garage has been converted into usable space with sealed epoxy floor, ceiling fans and blinds. This home with its unique function is a delight to inspect.

Upstairs:

Generous kitchen with electric cooktop, rangehood, oven + dishwasher

Open plan living and dining with timber look flooring, ceiling fans plus air conditioning

2 carpeted bedrooms with built in robes and ceiling fans (1 x air conditioning)

Elegantly renovated bathroom with separate toilet

Downstairs:

Formal entry with understairs storage

3rd carpeted bedroom + carpeted office space or playroom off the garage

3 2 3

FOR SALE

Guide \$790,000 - \$840,000

AGENTS

Gabrielle Thompson

0421 029 162

gthompson.alstonville@ljhooker.com.au

AGENCY

LJ Hooker Alstonville

(02) 6628 1163

All information contained therein is gathered from relevant third parties sources. We cannot guarantee or give any warranty about the information provided. Interested parties must rely solely on their own enquiries.

LJ Hooker

Laundry with 2nd bathroom, shower and toilet
Single entry garage for tandem car parking
20.000L water tank
Electric hot water

The 1,024 sq meter block has side access plus a gated rear yard.
Plenty of room for the boat or caravan. The generous yard had a large
powered 9 x 6 metre shed with roller door access.

This lifestyle property is from 14km to Ballina, 20km to Lennox Head
and 36km to Byron Bay.

Please feel welcome to inspect this well-established home, with
Exclusive Agent: Gabrielle Thompson.

MORE DETAILS

Property ID	16JDF55
Property Type	House
Land Area	1024 m2

Gabrielle Thompson 0421 029 162
Sales Consultant/Licensed Real Estate Agent |
gthompson.alstonville@ljhooker.com.au

LJ Hooker Alstonville (02) 6628 1163
Shop 16 The Plaza, ALSTONVILLE NSW 2477
alstonville.ljhooker.com.au | alstonville@ljhooker.com.au



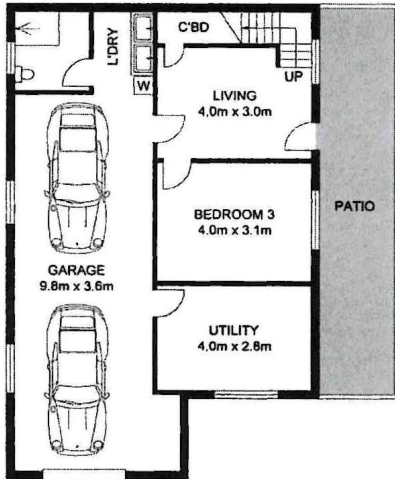

LOWER LEVEL

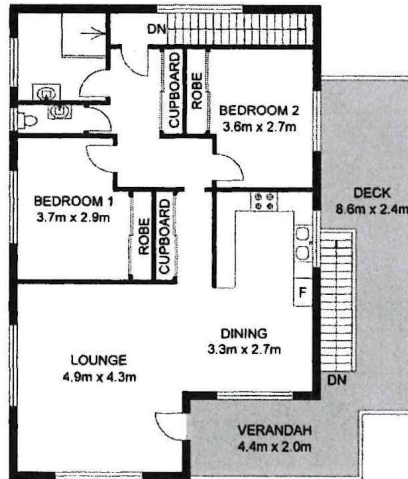

UPPER LEVEL

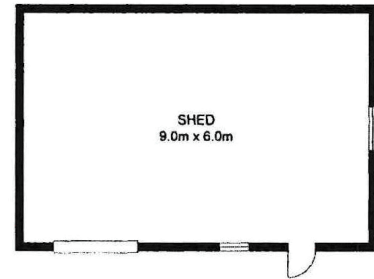

SHED

Dimensions are approximate. All information contained herein gathered from sources we believe to be reliable. However we cannot guarantee its accuracy and interested persons should rely on their own enquiries © visionmedia.vision 2024.

INT : 124.1m²
 EXT : 48.9m²
 SHED : 54.0m²
 GARAGE : 44.4m²



59 Riverbank Road, Pimlico