





1/42 Ashley Street, Paynesville

## STYLISH UNIT - PRICED TO SELL

Nestled in a peaceful complex of just two, this spacious unit offers an exceptional low maintenance lifestyle close to the recreation reserve, bowls club and school. The light filled L shaped living area boasts split system heating and cooling for year round comfort. The well equipped kitchen features a Belling stove, dishwasher, ample bench space and storage, making meal preparation a breeze.

Two generously sized bedrooms, both with built in robes, are serviced by a central bathroom with a bath, shower and direct access to the separate toilet. The laundry provides additional storage, while outside, the private grassy backyard offers a tranquil retreat. A secure garage with a roller door completes the package.

With walking tracks nearby and the option to purchase fully furnished, this unit is ideal for downsizers, first home buyers, or investors seeking a convenient and relaxed lifestyle.

2  1  1 

**FOR SALE**  
\$365,000 - PRICED TO SELL

### AGENTS

Lorraine Edlington  
0437 532 860  
ledlington.paynesville@ljhooker.com.au

### AGENCY

LJ Hooker Paynesville | Lakes Entrance  
| Metung  
(03) 5156 6166

All information contained therein is gathered from relevant third parties sources.  
We cannot guarantee or give any warranty about the information provided.  
Interested parties must rely solely on their own enquiries.

 **LJ Hooker**

## MORE DETAILS

Property ID MBWFCA  
Property Type Unit  
Including Air Conditioning  
Toilets (1)  
Dishwasher  
Built-in-Robes

**Lorraine Edlington 0437 532 860**  
Officer In Effective Control | Licensed Estate Agent |  
[ledlington.paynesville@ljhooker.com.au](mailto:ledlington.paynesville@ljhooker.com.au)

**LJ Hooker Paynesville | Lakes Entrance | Metung (03) 5156 6166**  
25A Esplanade, PAYNESVILLE VIC 3880  
[paynesville.ljhooker.com.au](http://paynesville.ljhooker.com.au) | [paynesville@ljhooker.com.au](mailto:paynesville@ljhooker.com.au)



All information contained therein is gathered from relevant third parties sources.  
We cannot guarantee or give any warranty about the information provided.  
Interested parties must rely solely on their own enquiries.

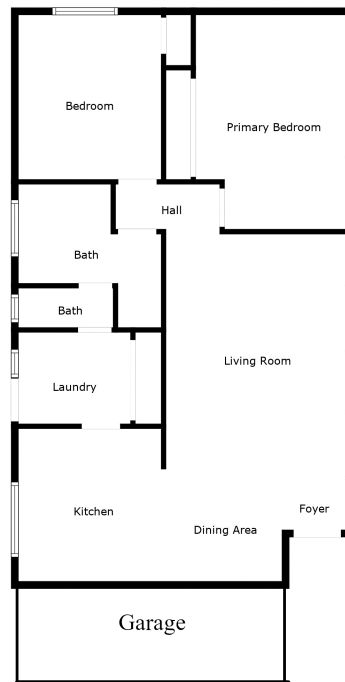

Disclaimer: Whilst every attempt has been made to ensure the accuracy of this floorplan, measurements or doors, windows, rooms and any other items are approximate only. The producer or the agent cannot be held responsible for any errors, omissions or misstatements. This plan is for illustrative purposes only and should be used as such.