





95 Pacific Road, Palm Beach

## State-of-the-Art Smart Home with Iconic Beach & Lighthouse Views

This extraordinary residence redefines luxury with cutting-edge automation, offering a seamless blend of sophistication, comfort, and technology. Basking in uninterrupted north-facing views across Palm Beach and Barrenjoey Headland, this automated smart home is as intelligent as it is beautiful—a true retreat for modern living.

Every aspect of this architectural masterpiece has been meticulously designed for effortless comfort and control. From security, lighting, ventilation, and garden irrigation the entire home can be managed at the touch of a button. The state-of-the-art automation system allows remote control of lighting, automated shutters, windows, external cameras, alarm system and irrigation.

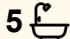
The dual-level layout is both expansive and inviting, with soaring double-height ceilings framed by exposed trusses. Neutral tones and premium finishes enhance the seamless connection between sunlit interiors and outdoor spaces, including a 12.5m solar heated pool, gas firepit, and dining cabana. With a due north aspect, the home is bathed in natural light year-round while remaining protected from cold

5  5  2 

### FOR SALE

Expressions of Interest Guide \$9.5m

### VIEW

By Appointment

### AGENTS

BJ Edwards  
0420 304 140  
bjedwards@ljhpb.com.au

David Edwards  
0415 440 044  
dedwards@ljhpb.com.au

### AGENCY

LJ Hooker Palm Beach  
(02) 9974 5999

All information contained therein is gathered from relevant third parties sources.  
We cannot guarantee or give any warranty about the information provided.  
Interested parties must rely solely on their own enquiries.

 **LJ Hooker**

southerly winds.

The kitchen is a showpiece of both style and functionality, featuring a vast Calacatta marble island bench ideal for entertaining. Advanced appliances and intelligent lighting create a setting that is as practical as it is beautiful.

On the lower level, the sleeping quarters exude elegance and comfort. Three ensuite bedrooms, a children's bunk room, and a lavish master suite offer custom-designed wardrobes, luxury bathrooms, and direct access to the terrace and pool. The master wing is a private sanctuary, complete with a sitting room, his-and-hers wardrobes, and direct outdoor access.

Set in a prestigious position at the lower end of Pacific Road, this home integrates every element of modern luxury with advanced smart technology, providing a lifestyle of effortless ease in one of Palm Beach's most exclusive settings.

## MORE DETAILS

Property ID	BTHF6Z
Property Type	House
Land Area	1062 m2
Including	Air Conditioning Alarm Pool Water Views

### BJ Edwards 0420 304 140

Licensed Real Estate Agent | [bjedwards@ljhpb.com.au](mailto:bjedwards@ljhpb.com.au)

### David Edwards 0415 440 044

Director | Licensee | David Edwards Palm Beach Realty Pty Ltd CLN 348342 | [dedwards@ljhpb.com.au](mailto:dedwards@ljhpb.com.au)

### LJ Hooker Palm Beach (02) 9974 5999

1073 Barrenjoey Road, PALM BEACH NSW 2108  
[palmbeach.ljhooker.com.au](http://palmbeach.ljhooker.com.au) | [office@ljhpb.com.au](mailto:office@ljhpb.com.au)

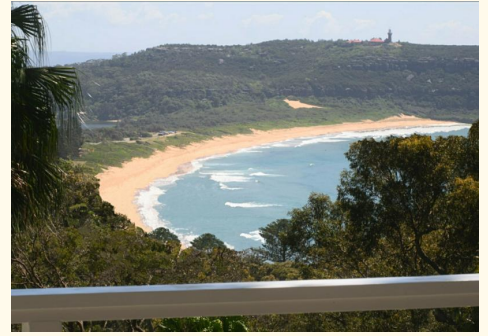



Lower Ground Floor

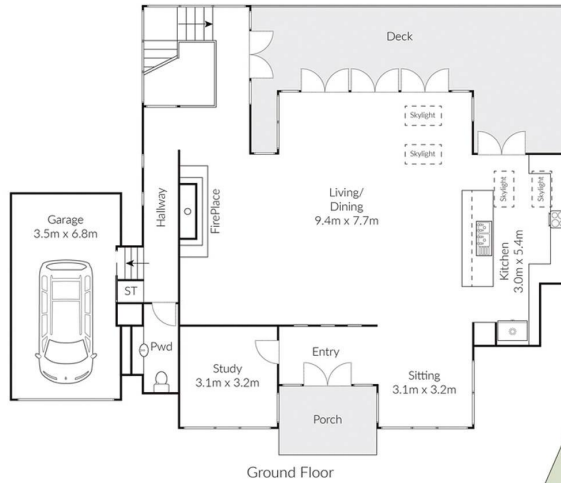

Ground Floor

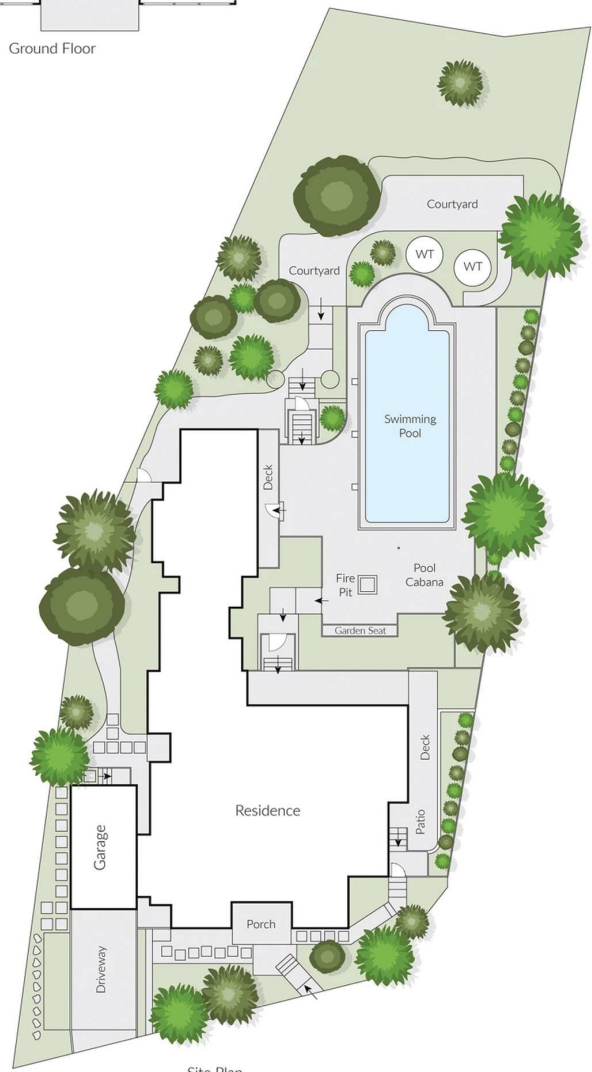

Site Plan

Approx Internal Area: 356m<sup>2</sup>  
 Approx External Area: 190m<sup>2</sup>  
 Approx Total Area: 546m<sup>2</sup>  
 Approx Land Area: 1062m<sup>2</sup>

**Disclaimer:** Every precaution to verify the accuracy of the above details has been taken. However, prospective purchasers are advised to make their own enquiries.

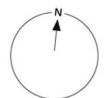

## 95 Pacific Road, Palm Beach



All information contained therein is gathered from relevant third parties sources.  
 We cannot guarantee or give any warranty about the information provided.  
 Interested parties must rely solely on their own enquiries.

