

Palm Beach, 68 Pacific Road

Contemporary home, spectacular views, brilliant north aspect

It's the Instagram view of a lifetime: due north vistas across the entire sweep of Palm Beach with Lion Island on the Pittwater side and the tip of Barrenjoey straight ahead. This contemporary residence is all about privacy, brilliant sunshine and phenomenal views; set on a level and low-maintenance block of 822sqm, the generous, open plan layout capitalizes on all three. Galleries of glass bring the views and light to the very centre of the residence, while decks and sandstone terraces extend the living areas to outdoor entertaining zones and the privacy of the gardens.

The kitchen is smartly-finished with Corian benchtops, custom-designed joinery and walk-in pantry; there are two guest bedrooms on the ground level, while the entire second floor is given over to a lavish master retreat with a second lounge and private deck. A sensational weekend or fulltime residence in one of the area's most desirable settings, it's located directly across from the walking track to Palm Beach and the rockpool,

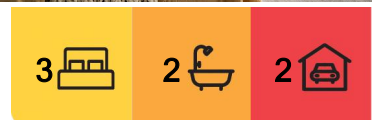

For Sale
\$5,200,000

View
ljhooker.com.au/BEDF6Z

Contact
David Edwards
0415 440 044
david.edwards@ljhooker.com.au

BJ Edwards
0420 304 140
bjedwards@ljhp.com.au



Disclaimer: All information contained therein is gathered from relevant third parties sources. We cannot guarantee or give any warranty about the information provided. Interested parties must rely solely on their own enquiries.

LJ Hooker Palm Beach
(02) 9974 5999

- Unrivalled views; Barrenjoey, the beach, Lion Island + Central Coast
- Sun-drenched north aspect, corner setting, level 822sqm parcel
- Clean, contemporary lines; sits beautifully within the landscape
- Open plan design with a generous layout maximises the views
- Fabulous entertainer with shady decks and sandstone terraces
- Contemporary Corian kitchen, custom storage, walk-in pantry
- Two large bedrooms on main level, serviced by family bathroom
- Full-floor master retreat; spectacular views and a private deck
- Set directly across from the pathway to the beach and rockpool

More About this Property

Property ID	BEDF6Z
Property Type	House
Land Area	822 m²
Including	Ocean Views Water Views

David Edwards 0415 440 044

Director | Licensee | David Edwards Palm Beach Realty Pty Ltd CLN 348342â€ | david.edwards@ljhooker.com.au

BJ Edwards 0420 304 140

Licensed Real Estate Agent | bjedwards@ljhpb.com.au

LJ Hooker Palm Beach (02) 9974 5999

1073 Barrenjoey Road, PALM BEACH NSW 2108
palmbeach.ljhooker.com.au | office@ljhpb.com.au

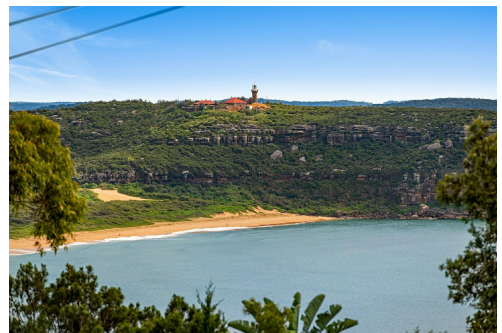

Disclaimer: All information contained therein is gathered from relevant third parties sources. We cannot guarantee or give any warranty about the information provided. Interested parties must rely solely on their own enquiries.

LJ Hooker Palm Beach
(02) 9974 5999

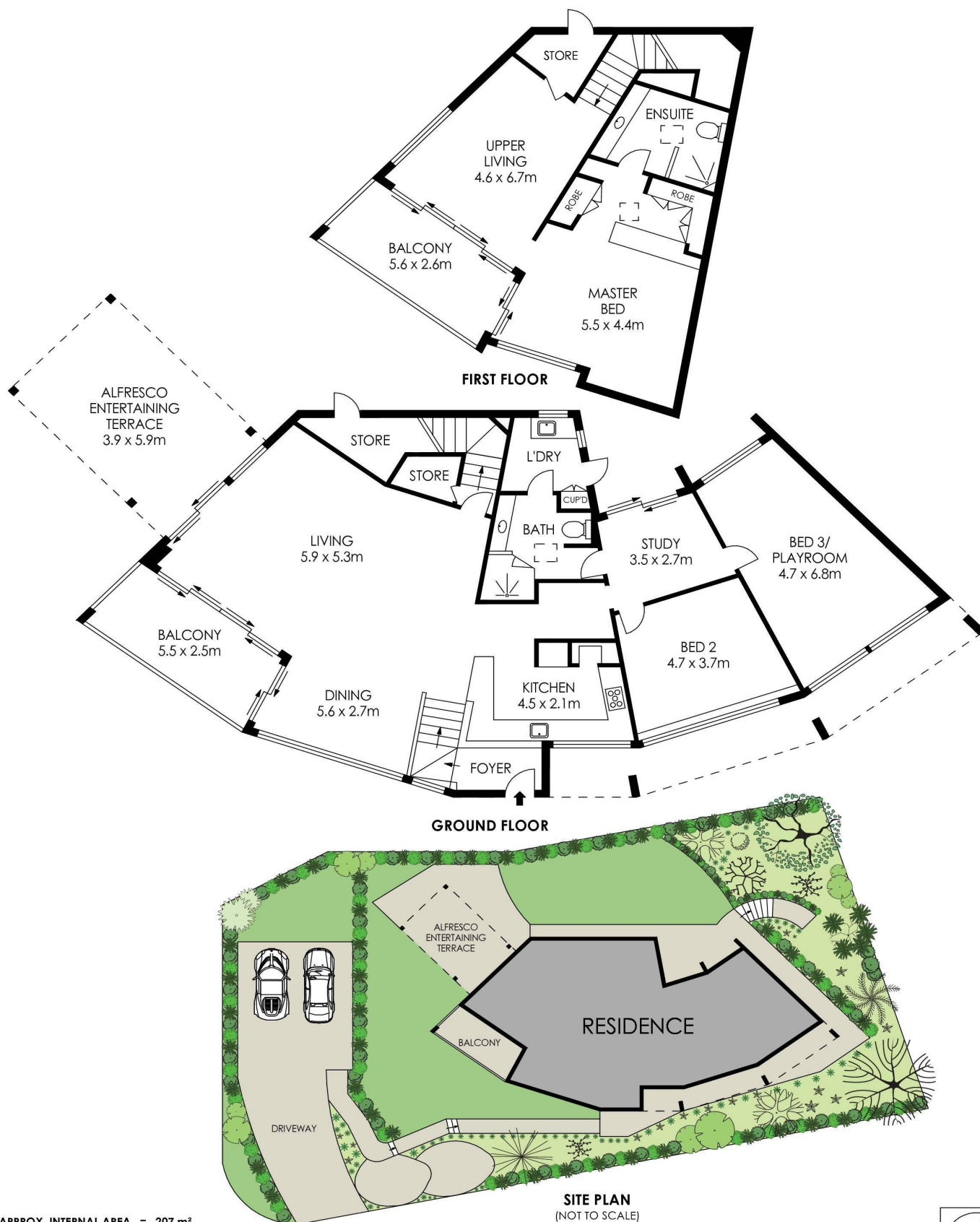

APPROX. INTERNAL AREA = 207 m²
 APPROX. EXTERNAL AREA = 45 m²
 TOTAL = 252 m²
 LAND SIZE = 822 m²

PLANS SHOWN ONLY INDICATIVE OF LAYOUT. DIMENSIONS ARE APPROXIMATE.

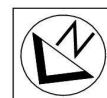

68 Pacific Road, Palm Beach

LJ Hooker

LJ Hooker

LJ Hooker Palm Beach
 (02) 9974 5999

Disclaimer: All information contained therein is gathered from relevant third parties sources.
 We cannot guarantee or give any warranty about the information provided. Interested parties must rely solely on their own enquiries.