

601/176 Glenmore Road, Paddington

2 🏠 1 🚿 1 🚗

Bright and Spacious 2-Bedroom Apartment in Prime Location with Covered Parking

FOR SALE

Sold - Price Undisclosed

AGENTS

Darran Wyatt
0407 440 947
darran@ljhdoublbay.com

James Fragias
0432 503 176
james.fragias@ljhdoublbay.com

Ideally positioned near the heart of the 5-Ways precinct, this sunlit apartment offers a perfect mix of comfort, lifestyle, and convenience. Located in the well-maintained 'Glenmore' complex, residents enjoy quality amenities in a peaceful garden setting.

Features include:

- Two bright and well-proportioned bedrooms, main with built-in robes
- Designer kitchen with dishwasher, timber waterfall bench tops
- Updated bathroom with bespoke vanity, ample storage
- Freshly painted throughout with a light, modern feel
- Open-plan living and dining area with great natural light, timber flooring
- Covered parking space included for added convenience
- Secure building with intercom access and lift
- " Residents' swimming pool surrounded by leafy gardens
- " Short walk to 5-Ways cafés, restaurants, and shops
- Easy access to CBD buses, Oxford Street, parks, and local amenities

AGENCY

LJ Hooker Double Bay
(02) 9185 2816

All information contained therein is gathered from relevant third parties sources. We cannot guarantee or give any warranty about the information provided. Interested parties must rely solely on their own enquiries.

 **LJ Hooker**

MORE DETAILS

Property ID 2C6HYY
Property Type Apartment

Darran Wyatt 0407 440 947

Associate Director - Wyatt Property Group Pty Ltd |
darran@ljhdoublebay.com

James Fragias 0432 503 176

Sales Associate Team Wyatt | james.fragias@ljhdoublebay.com

LJ Hooker Double Bay (02) 9185 2816

38 Ocean Street, WOOLLAHRA NSW 2025
doublebay.ljhooker.com.au | admin@ljhdoublebay.com

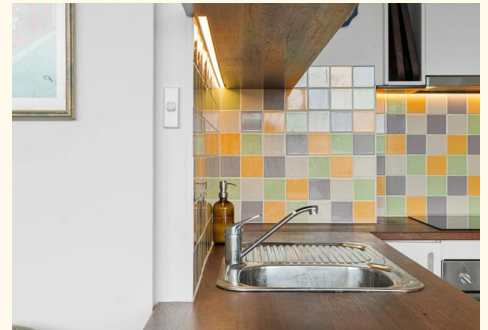
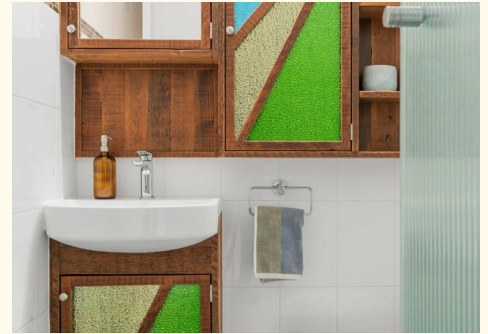

All information contained therein is gathered from relevant third parties sources.
We cannot guarantee or give any warranty about the information provided.
Interested parties must rely solely on their own enquiries.

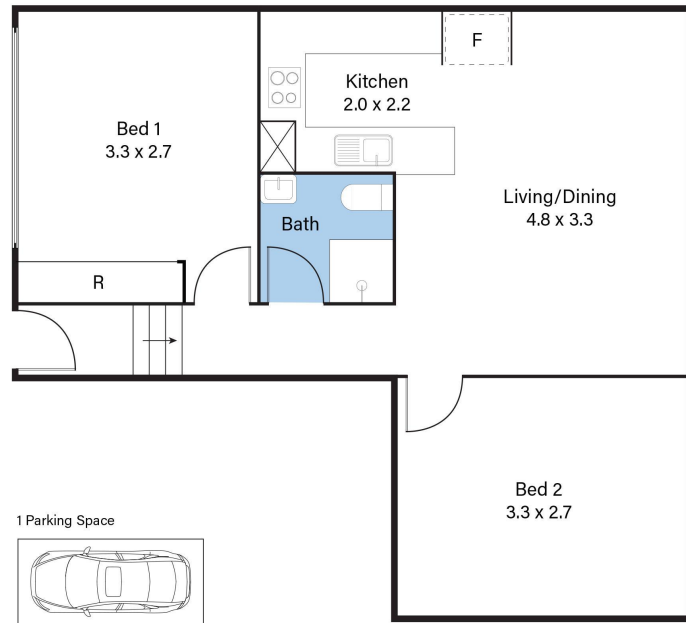

INDICATIVE ONLY. ALL INFORMATION CONTAINED HEREIN IS OBTAINED FROM SOURCES WE BELIEVE TO BE ACCURATE. IF INTERESTED PERSONS SHOULD MAKE THEIR OWN ENQUIRIES.