



9 Bellona Court, Pacific Pines

Elevated Family Living with Stunning Views on 1,387m²

Perched proudly in a quiet cul-de-sac and commanding an impressive 1,387m² allotment, 9 Bellona Court presents an exceptional opportunity to secure a spacious family residence with breathtaking elevated views, expansive living areas, and endless potential to create your dream outdoor oasis.

Beautifully maintained and thoughtfully designed for modern family living, this high-set contemporary home offers an abundance of space, comfort, and functionality. From the moment you step inside, you'll be captivated by the light-filled interiors, generous proportions, and seamless connection between indoor and outdoor living.

Property Highlights:

- " Elevated position with sweeping district views
- " Expansive 1,387m² fully fenced block
- Four oversized bedrooms, all featuring large built-in wardrobes and ceiling fans
- Spacious master retreat complete with ensuite, plantation shutters, and an enormous four-door built-in wardrobe
- Open-plan living and dining zones with floating timber flooring, air-conditioning, ceiling fans, and a stylish electric fireplace

All information contained therein is gathered from relevant third parties sources. We cannot guarantee or give any warranty about the information provided. Interested parties must rely solely on their own enquiries.

4 2 6

FOR SALE

Just Listed

VIEW

Sat 20th Jun @ 11:00AM - 11:30AM

AGENTS

Aaron Squires
0466 824 668
aaron.squires@ljhteam.com.au

AGENCY

LJ Hooker Pacific Pines | Helensvale
(07) 5573 2099



- Sliding doors opening onto the elevated balcony, creating the perfect setting for entertaining or enjoying peaceful sunsets
- Impressive entertainer's kitchen featuring extensive storage, stainless steel appliances, dishwasher, and ample bench space
- Large family bathroom with separate shower, bathtub, vanity, and separate toilet
- Functional laundry with built-in storage, bench space, and direct access to the backyard
- Huge triple-car garage with approximately 3-metre-high remote door, internal access, workshop area, extensive storage, and additional laundry facilities
- Outdoor Lifestyle

The enormous landscaped backyard offers a rare blank canvas for families and entertainers alike. With ample space for a resort-style swimming pool, expansive entertaining deck, children's play area, or all three, the possibilities are endless.

Additional features include:

- Security screens throughout
- Plantation shutters and quality window furnishings
- Multiple storage cupboards
- Exposed aggregate driveway
- Shade sails providing additional undercover parking

Prime Pacific Pines location, conveniently located just minutes from everything you need, this home offers easy access to:

- M1 Motorway
- Westfield Helensvale
- Top Golf, Movie World and Wet and Wild
- Quality public and private schools
- Public transport options
- Local parks, sporting facilities, and shopping precincts

Offering space, privacy, spectacular views, and incredible future potential, this is a home that truly needs to be experienced in person.

Whether you're upsizing, accommodating a growing family, or simply searching for a property with room to move, 9 Bellona Court delivers an outstanding lifestyle opportunity in one of Pacific Pines' most desirable pockets. Properties of this calibre, on blocks of this size, are becoming increasingly rare.

Contact Aaron Squires today on 0466 824 668 should you have any questions.

Disclaimer:

All information contained is gathered from relevant third party sources. We cannot guarantee or give any warranty about the information provided. Interested parties must rely solely on their own enquiries.

MORE DETAILS

Property ID 364WGMK
Property Type House
Land Area 1387 m2
Including Ensuite
Air Conditioning
Toilets (2)
Balcony
Dishwasher
Workshop
Built-in-Robes
Fully Fenced
Remote Garage

Aaron Squires 0466 824 668
Sales Specialist | aaron.squires@ljhteam.com.au

LJ Hooker Pacific Pines | Helensvale (07) 5573 2099
8 Discovery Drive, HELENSVALE QLD 4212
pacificpines-helensvale.ljhooker.com.au | admin@ljhteam.com.au



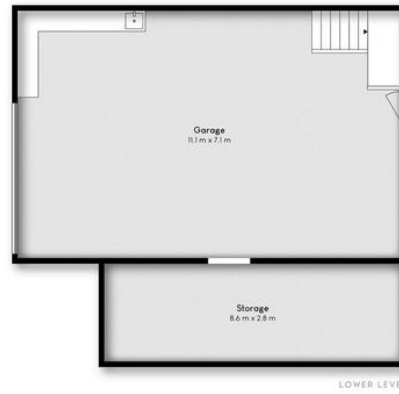

9 BELLONA COURT, PACIFIC PINES

 4  2  5

Internal: 308m² | External: 21m² | Total: 329m²

Whilst every attempt has been made to ensure the accuracy of the floor plan contained here, measurements of doors, windows, rooms and any other item are approximate and no responsibility is taken for any error, omission, or misstatement. This plan is for illustrative purposes only and should only be used as such by any prospective purchaser.

