

29 Diamond Drive, Ocean Reef

## Original. Elevated. Full of Potential.

A Rare Original with Space, Scale & a Blank Canvas to Create Something Special

Held by the same owner since 1992, this immaculately kept and completely original home offers a rare combination of space, flexibility, and future potential-set on an elevated 812sqm block with a desirable South/West aspect.

Behind its unassuming facade, the home opens into a surprisingly generous and well-considered floorplan spanning over 221sqm of internal living. Multiple living zones create natural separation, with a formal lounge and dining at the front and a more relaxed open-plan kitchen, meals, and family area to the rear. It's a layout that works effortlessly for families now, while also providing the perfect foundation to modernise over time.

The bedroom wing is equally well designed, with four comfortable bedrooms including a master suite with walk-in robe and ensuite. Each room offers genuine space, reinforcing the sense of a home built for long-term living rather than short-term trends.

4  2  2 

### FOR SALE

\$1,500,000+

### VIEW

Sat 18th Apr @ 1:30PM - 2:30PM

### AGENTS

Matt Hemsworth  
0488 070 954  
matthew.hemsworth@ljhooker.com.au

Connor Hines  
0436 524 374  
connor.hines@ljhooker.com.au

### AGENCY

LJ Hooker Joondalup  
(08) 9300 2100

All information contained therein is gathered from relevant third parties sources.  
We cannot guarantee or give any warranty about the information provided.  
Interested parties must rely solely on their own enquiries.



At the centre, the original kitchen remains neat and functional, yet its proportions hint at what could be-an easy opportunity to redesign into a contemporary focal point that connects seamlessly with the surrounding living areas.

Step outside and the opportunity becomes even more compelling. The outdoor spaces are currently simple and understated, but this is where imagination takes over. With the scale of land on offer, there is more than enough room to create something exceptional-whether that's a statement alfresco, a poolside retreat, lush landscaping, or a complete transformation into a modern coastal entertainer. It's a true blank canvas, rarely found in such a tightly held location.

Positioned just moments from Mullaloo Beach lookout, Mirror Park, Ocean Reef Primary School, and the future Sunset Plaza precinct, the lifestyle on offer is as appealing as the property itself.

This is not a home trying to be something it's not. It's honest, solid, and full of possibility-ready for its next owner to shape its future.

For more, contact Matt Hemsworth.

## MORE DETAILS

Property ID	KZYHRD
Property Type	House
House Size	221 m2
Land Area	812 m2
Including	Ensuite Air Conditioning Toilets (3) Courtyard Dishwasher Outdoor Entertaining Built-in-Robes Fully Fenced Liveability

**Matt Hemsworth 0488 070 954**

Residential Property Sales | [matthew.hemsworth@ljhooker.com.au](mailto:matthew.hemsworth@ljhooker.com.au)

**Connor Hines 0436 524 374**

Associate to Matt Hemsworth | [connor.hines@ljhooker.com.au](mailto:connor.hines@ljhooker.com.au)

**LJ Hooker Joondalup (08) 9300 2100**

4/25 Delage Street, JOONDALUP WA 6027

[joondalup.ljhooker.com.au](http://joondalup.ljhooker.com.au) | [admin.joondalup@ljhooker.com.au](mailto:admin.joondalup@ljhooker.com.au)



**LJ Hooker** 29 Diamond Drive, Ocean Reef



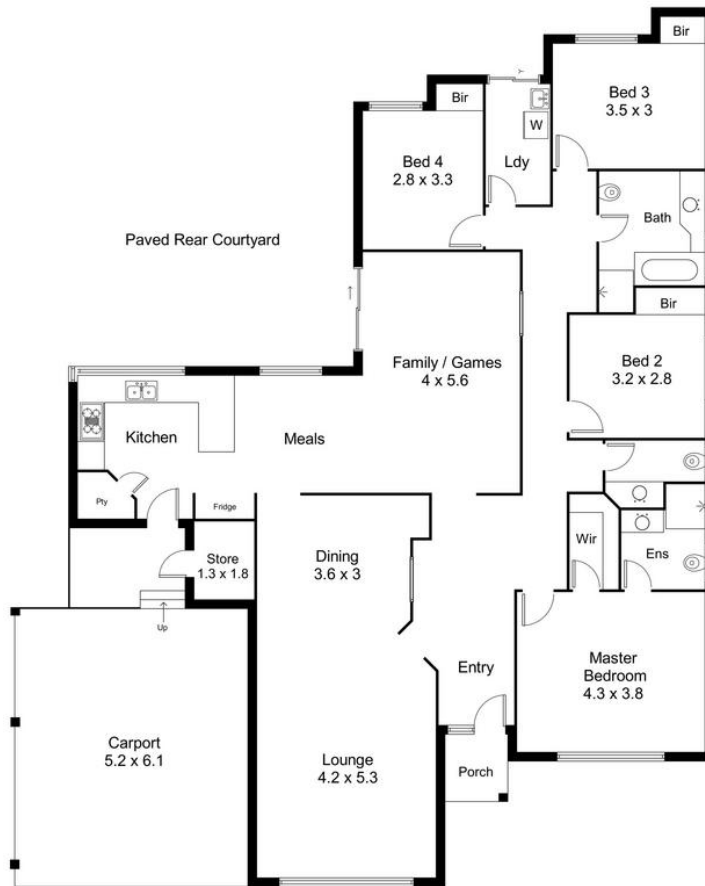

29 Diamond Drive, Ocean Reef

For information and guidance purpose only / measurements shown are approximate

All information contained therein is gathered from relevant third parties sources. We cannot guarantee or give any warranty about the information provided. Interested parties must rely solely on their own enquiries.

