



6/1-9 Wharf Road, North Batemans Bay

Holiday Haven Moments from the Water

Set in one of North Batemans Bay's most convenient and sought-after pockets, this tidy 2-bedroom, 1-bathroom unit at 6/1-9 Wharf Road offers the ideal coastal retreat. Whether you're looking for a low-maintenance weekender, a smart investment, or a relaxed holiday base, this property ticks all the boxes. Positioned just moments from the Batemans Bay foreshore, you'll enjoy easy access to cafes, restaurants, shops, and the iconic Clyde River. Launch the kayak, stroll along the waterfront, or simply sit back and take in the sea breeze - this location is all about lifestyle.

Key Features:

- Fantastic holiday location
- Neat and low-maintenance 2-bed, 1-bath design
- Single lock-up garage
- Less than 100m to the foreshore, approx. 600m to town and local dining
- Ideal as a holiday home, permanent residence, or investment opportunity
- Filtered water glimpses through the trees

Relax, unwind, and enjoy everything the South Coast has to offer -

2  1  1 

FOR SALE
\$489,000

AGENTS

Jacob Rush
0419 690 813
jrush.batemansbay@ljhooker.com.au

Rob Routledge
0414 235 976
routledge.batemansbay@ljhooker.com.au

AGENCY

LJ Hooker Batemans Bay
(02) 4472 6455

All information contained therein is gathered from relevant third parties sources.
We cannot guarantee or give any warranty about the information provided.
Interested parties must rely solely on their own enquiries.

 **LJ Hooker**

this is an unbeatable opportunity in a prime holiday hotspot.

Body Corp: \$519/qtr
Council Rates: \$2,696/yr

MORE DETAILS

Property ID 12QPF8F
Property Type Unit

Jacob Rush 0419 690 813

Licensed Real Estate Agent | Auctioneer | Stock & Station Agent |
jrush.batemansbay@ljhooker.com.au

Rob Routledge 0414 235 976

Licensed Real Estate Agent / Auctioneer / Stock & Station Agent |
rroutledge.batemansbay@ljhooker.com.au

LJ Hooker Batemans Bay (02) 4472 6455

Cnr Beach Road & Orient Street, BATEMANS BAY NSW 2536
batemansbay.ljhooker.com.au | batemansbay@ljhooker.com.au



Total Approximate Area
86 square metres
Property Includes
Single Garage

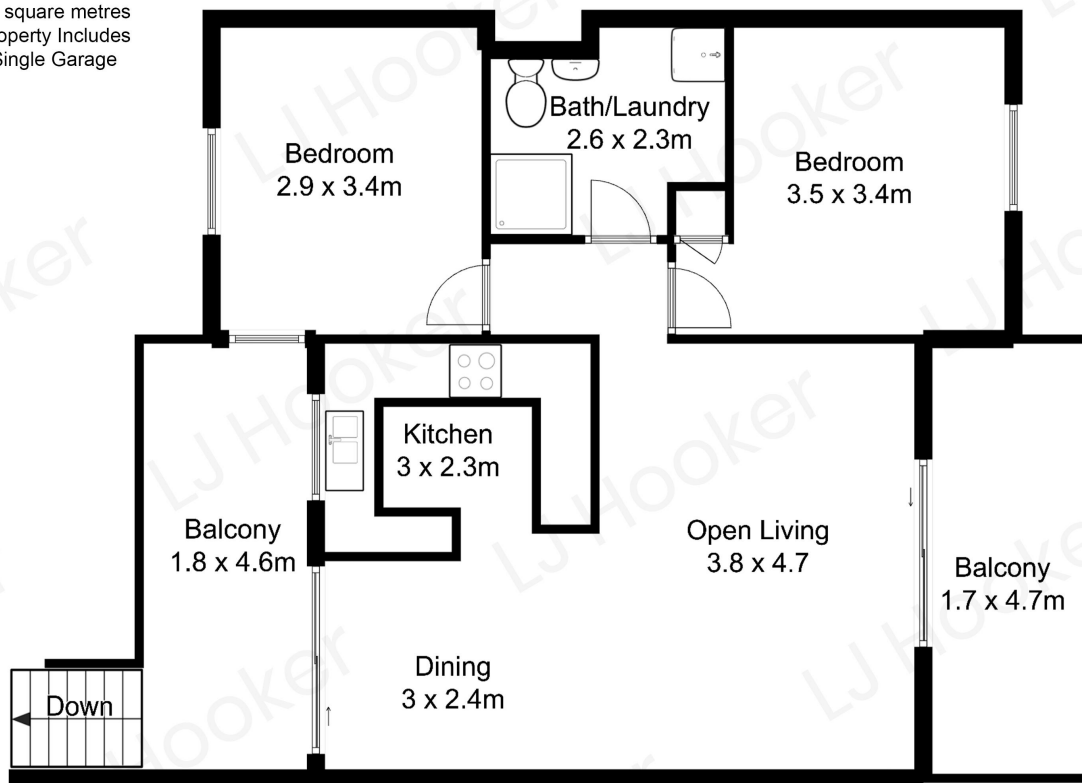

All measurements are approximate and are intended as a guide only

