



Nightcliff, 2/16 Grevillea Circuit

Leafy Ground Floor Bliss

Delightful ground floor apartment neatly presented in the ever-desirable suburb of Nightcliff. Set in a beachside neighbourhood where the bike and walking paths wind around the foreshore to the Jetty and beyond, this home is more than a roof over your head, it's a lifestyle choice.

Inviting and easy to maintain, the living space features a painted exposed brick wall with light tiled flooring and sliding door access to the lush courtyard. A functional U shaped kitchen provides a great use of space with wrap around counters, offering plenty of room to prepare meals and extra storage with overhead cupboards plus the convenience of a servery window.

Both of the bedrooms are bright and spacious and offer ample storage with a built in robe and both are air-conditioned to help beat the build up heat. A functional design in the bathroom incorporates the laundry facilities to maximise space and efficiency. An open

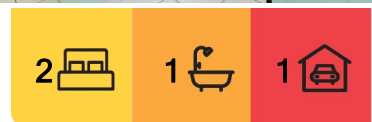

For Sale
\$330,000

View
l.jhooker.com.au/5CRNF2X

Contact
Jasmine Smith
0438 978 737
jsmith@l.jhookerdarwin.com.au



Disclaimer: All information contained therein is gathered from relevant third parties sources. We cannot guarantee or give any warranty about the information provided. Interested parties must rely solely on their own enquiries.

LJ Hooker Darwin
(08) 8924 0900

shower and neat vanity tucked between the washing machine and a nib wall plus the toilet are all well placed and supremely functional.

Features include:

- * Great sized living room overlooking the leafy courtyard
- * Two generous size bedrooms with built in robes
- * Well-appointed U shape kitchen with ample storage
- * Two bedrooms, both with built-in robes and air conditioning
- * Tiled main bathroom and laundry combo
- * Large private courtyard with lush established gardens

The complex offers a large swimming pool under a shade sail to keep the water pleasant all year round. Paved surrounds offer a place to entertain or sit poolside with friends and the cool water is just perfect for these hotter months. A handy storage shed is also tucked away at the rear of the complex.

Superb as a first home or ideal as an investment, this two bedroom apartment has so much to offer in a wonderful location with local schools and shops all within walking distance.

Body corporate management: Whittles
Body corporate levies: \$1,400 p/q approx.
Council rates: \$1,750 per annum approx.
Property built: 1970 approx.
Area under Title: 160m2

More About this Property

Property ID	5CRNF2X
Property Type	Apartment
Land Area	160 m2

Jasmine Smith 0438 978 737
Sales Representative | jsmith@ljhookerdarwin.com.au

LJ Hooker Darwin (08) 8924 0900
Shop 1/25 Parap Road, PARAP NT 0820
darwin.ljhooker.com.au | reception@ljhookerdarwin.com.au



Disclaimer: All information contained therein is gathered from relevant third parties sources. We cannot guarantee or give any warranty about the information provided. Interested parties must rely solely on their own enquiries.

LJ Hooker Darwin
(08) 8924 0900

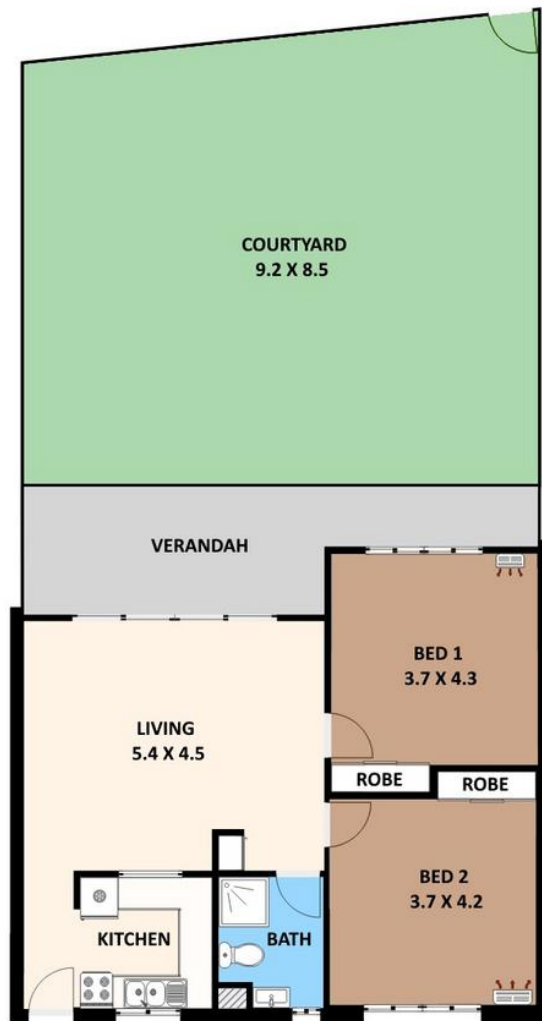

2/16 GREVILLEA CIRCUIT, NIGHTCLIFF

DISCLAIMER

PLANS SHOWN ARE FOR MARKETING PURPOSES ONLY, ALL DIMENSIONS ARE APPROXIMATE IN METRES AND NOT TO SCALE. THEY ARE SUBJECT TO ERRORS AND INACCURACIES AND NO LIABILITY WILL BE ACCEPTED. INTERESTED PARTIES SHOULD MAKE THEIR OWN INQUIRIES.