

## Newport, 98 Prince Alfred Parade

### Exquisite deep waterfront residence

Boasting one of the finest deep waterfront settings in Newport, this exquisite residence would be right at home on the Amalfi Coast. Its Mediterranean design is combined with a sun-drenched north aspect and views straight up Pittwater. The home is one of graceful lines and grand proportions, cascading over several levels to the waterfront and serviced by an internal lift plus a separate inclinuator from the house to the waterfront. A series of expansive terraces and courtyards create an unrivalled indoor/outdoor experience. It offers an extraordinary lifestyle for boating enthusiasts with a substantial deep water jetty and resort style pool at the water's edge.

- Sandstone and double brick construction
- North aspect, elegant interiors, internal lift, two fireplaces
- Magnificent Pittwater views; dotted with sun-drenched terraces



**Disclaimer:** All information contained therein is gathered from relevant third parties sources. We cannot guarantee or give any warranty about the information provided. Interested parties must rely solely on their own enquiries.

5

6

2

**For Sale**

\$12,900,000

**View**

[ljhooker.com.au/APXF6Z](http://ljhooker.com.au/APXF6Z)

**Contact**

**David Edwards**

0415 440 044

[david.edwards@ljhooker.com.au](mailto:david.edwards@ljhooker.com.au)

**BJ Edwards**

0420 304 140

[bjedwards@ljhpb.com.au](mailto:bjedwards@ljhpb.com.au)

**LJ Hooker Palm Beach**  
**(02) 9974 5999**



- Designer kitchen with Bertazzoni appliances, butler's pantry
- Master suite offers magnificent views and sleek kitchenette
- Ample room for weekend guests with two self-contained suites
- Double garage plus off street car parking; level street entrance
- Inclinator to shoreline; deep waterfront; substantial jetty
- Poolside cabana/boathouse and a sparkling resort style pool
- Stroll to Royal Prince Alfred and Royal Motor Yacht Clubs

DISCLAIMER:

We have obtained the above information from sources we believe to be reliable and accurate, however, interested parties should rely upon their own enquiries and seek advice where necessary in respect of this property.

## More About this Property

Property ID	APXF6Z
Property Type	House
Land Area	600 m²
Including	Fire Place Pool Prestige Homes Water Front Water Views

David Edwards

Director | Licensee | Independent Contractor |  
david.edwards@ljhooker.com.au

BJ Edwards

Licensed Real Estate Agent | bjedwards@ljhpb.com.au

LJ Hooker Palm Beach (02) 9974 5999

1073 Barrenjoey Road, PALM BEACH NSW 2108  
palmbeach.ljhooker.com.au | office@ljhpb.com.au



**Disclaimer:** All information contained therein is gathered from relevant third parties sources. We cannot guarantee or give any warranty about the information provided. Interested parties must rely solely on their own enquiries.

**LJ Hooker Palm Beach**  
**(02) 9974 5999**



LEVEL ONE

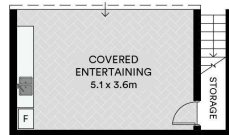

LOWER LEVEL



LEVEL TWO



LEVEL THREE  
(ENTRY LEVEL)

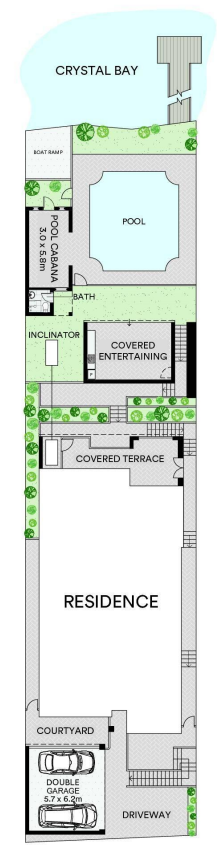

PRINCE ALFRED PARADE



INTERNAL AREA : 482 M<sup>2</sup>  
EXTERNAL AREA : 458 M<sup>2</sup>  
LAND AREA : 606 M<sup>2</sup>

All information contained in this document is from sources we believe to be accurate, however we cannot guarantee its accuracy. Interested persons should make and rely on their own enquiries in relation to measurements, dimensions, layout, furniture and descriptions.