



Newport, 9 Yachtsmans Paradise

First Time Offered- Architectural Split-Level Design

Tucked away in the highly sought-after Yachtsman's Paradise on Sydney's Northern Beaches, this architecturally designed, elevated family home offers the perfect blend of timeless elegance, expansive living, and unparalleled convenience.

For the first time in over 40 years, the current owners are offering this cherished home for sale - an extraordinary opportunity to acquire a property that has been a loving home for generations.

Key Features:

* 4 Bedrooms + Loft Game Room

This expansive home boasts four spacious bedrooms, including a private master with a well appointed ensuite. A versatile loft or games room offers endless possibilities - whether it's a home office, creative space, or a fun-filled entertainment area for family and friends.



Disclaimer: All information contained therein is gathered from relevant third parties sources.

We cannot guarantee or give any warranty about the information provided. Interested parties must rely solely on their own enquiries.

SOLD

4

2

4

For Sale

Sold Off Market

View

ljhooker.com.au/2VU5F6K

Contact

Asha Kerr

0451 635 535

akerr@ljhmv.com.au

Lachlan Elder

0418 224 180

lelder@ljhmv.com.au

LJ Hooker Mona Vale
(02) 9979 8000

* Architectural Split-Level Design

Step inside and be captivated by the home's thoughtful, split-level design, which maximizes natural light, space, and flow. Each level is carefully positioned to offer distinct zones for living and entertaining, while maintaining a sense of privacy and serenity throughout. The result is a seamless living experience that's perfect for modern family life.

* Impeccable Build Quality

Constructed with solid double-brick and complemented by rich hardwood timbers, this home is built to last.

From the quality finishes to the attention to detail, the craftsmanship is evident at every turn - ensuring both durability and timeless appeal. This is a home designed to stand the test of time, just as it has for over four decades.

* While this offering is open to all, it remains a rare and hidden gem- Wharf Access. One of the standout features of this remarkable property is the dedicated wharf, providing direct access for boat drop-offs and pick-ups. This unique amenity opens up a world of possibilities, from leisurely cruises to exploring the scenic waterways right at your doorstep.

It's a rare privilege that adds a distinct dimension to your lifestyle, offering unmatched convenience and opportunity.

* Ideal Family Park & Backyard Cricket

Within the cul-de-sac is a stunning public park - a perfect spot for weekend BBQs, outdoor play, or a game of backyard cricket. Imagine your children running through the grass, while you enjoy the space and freedom of this family-friendly area, just steps from your door.

* A Location Like No Other

The Northern Beaches lifestyle is renowned for its relaxed, coastal charm - and Yachtsman's Paradise is its crown jewel. A short stroll will take you to pristine beaches, chic cafes, boutique shopping, and a vibrant local community. Whether you're a beach lover, a water enthusiast, or simply someone who values privacy and peace, this home offers it all - with the added convenience of being just moments from schools, transport, and the best of Sydney.

* A Home with a History

Built and lovingly maintained by the current owners for over 40 years, this home is rich with family memories and a testament to quality and care. It's a place where the past has been cherished, and the future is ready to unfold for its next lucky owners.

Disclaimer:

All information contained herewith, including but not limited to the general property description, price and the address, is provided to LJ Hooker Mona Vale by third parties. We have obtained this information from sources we believe to be reliable; however, we cannot guarantee its accuracy. The information contained herewith should not be relied upon and you should make your own enquiries and seek advice in respect of this property or any property on this website.



LJ Hooker Mona Vale
(02) 9979 8000

Disclaimer: All information contained therein is gathered from relevant third parties sources. We cannot guarantee or give any warranty about the information provided. Interested parties must rely solely on their own enquiries.

More About this Property

Property ID	2VU5F6K
Property Type	House
Land Area	744 m ²

Asha Kerr 0451 635 535

Licensed Real Estate Agent | akerr@ljhmv.com.au

Lachlan Elder 0418 224 180

Principal, Licensed Real Estate Agent | lelder@ljhmv.com.au

LJ Hooker Mona Vale (02) 9979 8000

3/18 Bungan Street, MONA VALE NSW 2103

monavale.ljhooker.com.au | monavale@ljhmv.com.au



LJ Hooker Mona Vale
(02) 9979 8000

Disclaimer: All information contained therein is gathered from relevant third parties sources. We cannot guarantee or give any warranty about the information provided. Interested parties must rely solely on their own enquiries.

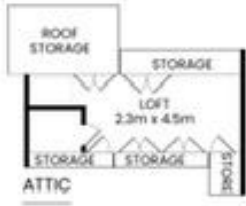

9 Yachtsman Paradise Newport

INTERNAL FLOOR AREA 225m² APPROX.
INCL. GARAGE
EXTERNAL FLOOR AREA 59m² APPROX.
LOFT AREA 26m² APPROX.
TOTAL FLOOR AREA 310m² APPROX.



The site plan and floor plan are not to scale; measurements are indicative and in meters. Bushes and trees are placed for illustration purposes. Plans should not be relied on. Interested parties should make and rely on their own enquiry. All other information provided has been collected from reliable sources but cannot be guaranteed for accuracy.