



29 Attunga Road, Newport

Architectural Brilliance Above Newport Beach

Positioned to capture sweeping vistas across Newport Beach and the endless blue beyond, this grand architecturally designed residence is a statement of coastal luxury and timeless design. Spanning four impressive levels, the home reveals a series of sophisticated living spaces that embrace light, scale and breathtaking outlooks from almost every room.

Expanses of glass frame the spectacular coastline, while seamless indoor outdoor integration invites relaxed family living and effortless entertaining. From sun-drenched terraces to beautifully appointed interiors, every element of this exceptional home has been crafted to celebrate its remarkable setting just moments from the sand.

Just moments from the vibrant village atmosphere of Newport, the home places boutique shopping, cafés and some of the Northern Beaches' most celebrated surf breaks within easy reach. This is a rare opportunity to secure a substantial coastal sanctuary where architectural sophistication meets breathtaking ocean panoramas.

Property highlights:

- Grand four-level residence designed by renowned architect Clive

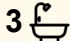
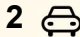
4  3  2 

FOR SALE
Contact Agent

VIEW
By Appointment

AGENTS
Jake McDonall
0402 740 085
jmcdonall@ljhnewport.com.au

AGENCY
LJ Hooker Newport
(02) 9979 1111

All information contained therein is gathered from relevant third parties sources.
We cannot guarantee or give any warranty about the information provided.
Interested parties must rely solely on their own enquiries.

 **LJ Hooker**

Henri Gorton

- Spectacular elevated views across Newport Beach and the coastline from almost every room
- Immaculate light-filled interiors framed by walls of glass and a flowing open plan layout
- Expansive entertaining deck featuring ocean view bar seating, perfect for sunset drinks overlooking Newport Beach
- Outdoor entertaining zone complete with built-in BBQ, a relaxing hot tub, ideal for hosting family and friends
- Level lawn areas complemented by a private gas-heated plunge pool with spa jets
- Stunning entertainer's kitchen featuring elegant stone benchtops, gas cooking and an impressive butler's pantry
- Two generous living areas with stunning ocean views, including a main living space with feature stone fireplace
- Luxurious master retreat featuring an ensuite with spa, walk-in robe, kitchenette and additional living area
- Three further generous bedrooms, including one with ensuite and its own balcony
- Large home office with balcony, coastal views and separate access-ideal for working from home
- Double garage with storage, air conditioning and a refined blackbutt timber flooring throughout

Disclaimer:

All information contained herewith, including but not limited to the general property description, price and the address, is provided to LJ Hooker Newport by third parties. We have obtained this information from sources we believe to be reliable; however, we cannot guarantee its accuracy. The information contained herewith should not be relied upon and you should make your own enquiries and seek advice in respect of this property or any property on this website.

MORE DETAILS

Property ID	1B0MG5W
Property Type	House
Land Area	602.5 m2
Including	Ensuite Pool Fire Place Balcony Floorboards Close to Shops Close to Transport Ocean Views Water Views

Jake McDonall 0402 740 085
Sales Executive | jmcdonall@ljhnewport.com.au

LJ Hooker Newport (02) 9979 1111
303 Barrenjoey Road, NEWPORT NSW 2106
newport.ljhooker.com.au | newport@ljhnewport.com.au

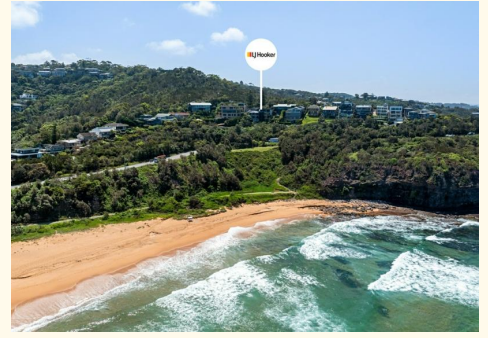

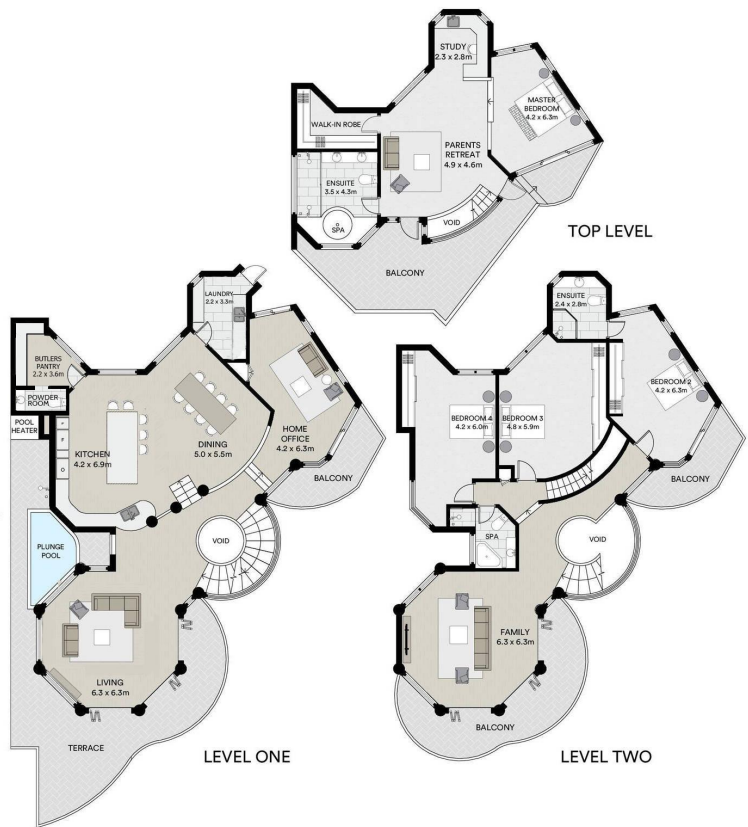
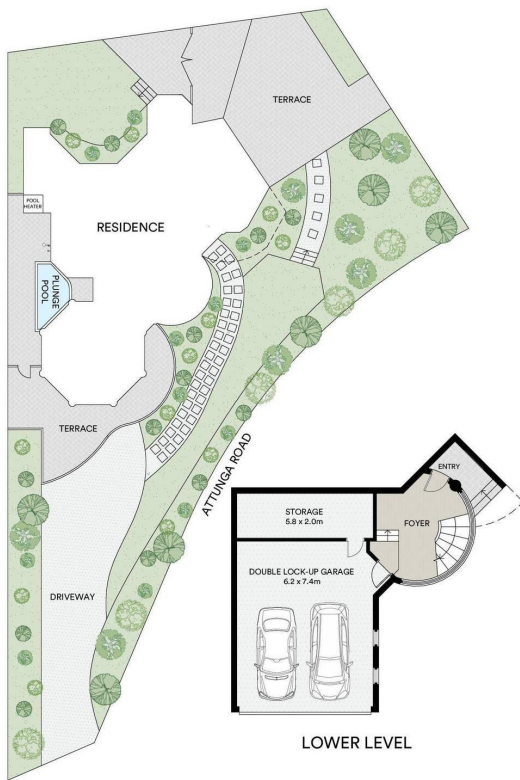

All information contained in this document is from sources we believe to be accurate, however we cannot guarantee its accuracy. Interested persons should make and rely on their own enquiries in relation to measurements, dimensions, layout, furniture and descriptions.

All information contained therein is gathered from relevant third parties sources.
 We cannot guarantee or give any warranty about the information provided.
 Interested parties must rely solely on their own enquiries.