



Newport, 2/28 Bardo Road

Sunlit Ground Floor Gem Moments to Beach and Village

Infused with laid-back coastal charm, this light-filled two-bedroom apartment sits on the ground floor of the tightly held Bardo Court—a boutique block of just 12. Polished timber floors and fresh paint enhance the airy interiors, while a northeast-facing patio invites morning sunshine and a leafy, private oasis making it an ideal spot to unwind. There's plenty of scope to make your mark or simply settle into its relaxed, move-in ready vibe. This is an exciting opportunity to enter the market or invest with confidence, perfectly positioned to embrace the best of the Northern Beaches lifestyle.

- oLight-filled two-bedroom apartment in Newport
- oSet on the ground floor in boutique Bardot Court
- oFreshly painted with light polished timber floors
- oTimber kitchen with dining, shelving, gas cooking
- oTwo bright bedrooms, built-in robes, floorboards
- oOriginal retro bathroom offers scope to reimagine

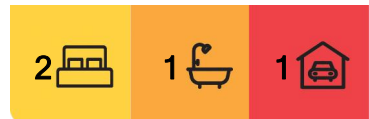

For Sale
Guide \$900,000

View
By Appointment

Contact
Cherie Sevenoaks
0414 400 689
csevenoaks@ljhnewport.com.au



LJ Hooker Newport
(02) 9979 1111

Disclaimer: All information contained therein is gathered from relevant third parties sources. We cannot guarantee or give any warranty about the information provided. Interested parties must rely solely on their own enquiries.

- oPrivate northeast-facing patio with garden outlook
 - oSingle carport for ease, shared laundry in building
 - oMove-in ready with exciting potential to enhance
 - oSmart first home or investment in prime location
- Superbly positioned just moments from Newport's vibrant village, offering an array of boutique shops, seaside cafés, and popular restaurants. This prime location is close to schools, yacht clubs, scenic golf courses, pristine surf beaches, and provides easy access to express city buses.

Disclaimer:

All information contained herewith, including but not limited to the general property description, price and the address, is provided to LJ Hooker Newport by third parties. We have obtained this information from sources we believe to be reliable; however, we cannot guarantee its accuracy. The information contained herewith should not be relied upon and you should make your own enquiries and seek advice in respect of this property or any property on this website.

More About this Property

Property ID	1AR1G5W
Property Type	Apartment
Land Area	65 m2
Including	Balcony Floorboards Built-in-Robes Close to Schools Close to Shops Close to Transport Disabled Access

Cherie Sevenoaks 0414 400 689

Senior Sales Executive, LREA | csevenoaks@ljhnewport.com.au

LJ Hooker Newport (02) 9979 1111

303 Barrenjoey Road, NEWPORT NSW 2106
newport.ljhooker.com.au | newport@ljhnewport.com.au



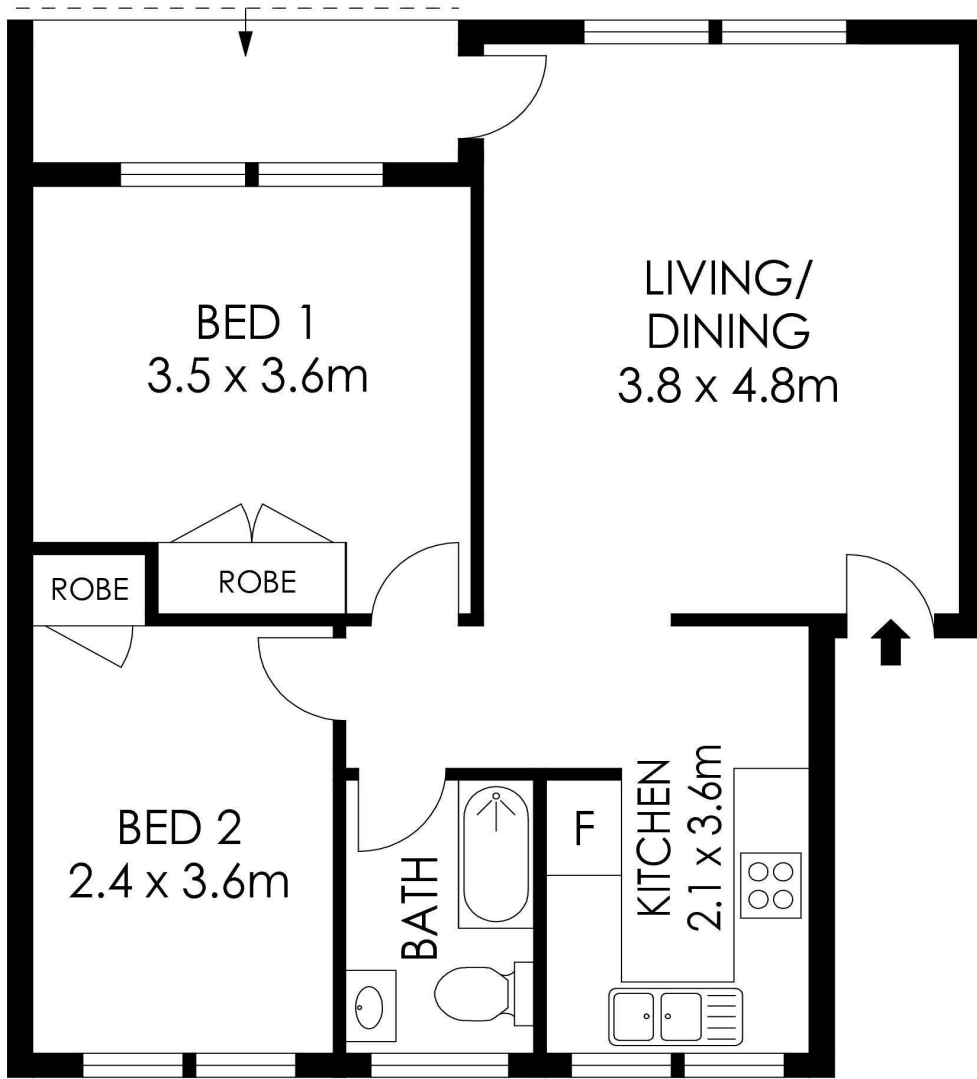

GROUND LEVEL

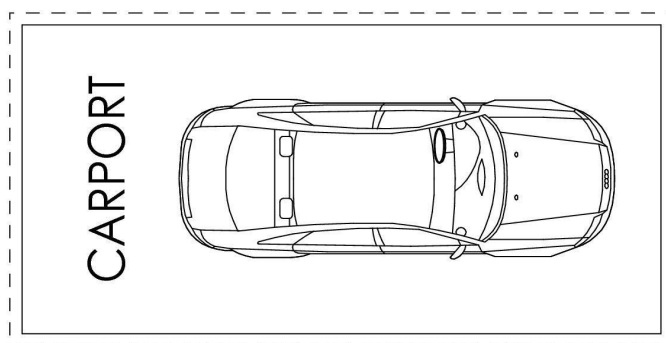

2/28 Bardo Road, Newport



LJ Hooker Newport
(02) 9979 1111

Disclaimer: All information contained therein is gathered from relevant third parties sources. We cannot guarantee or give any warranty about the information provided. Interested parties must rely solely on their own enquiries.